

Nº 46161

R.P.O. Vol. 1822
C.T. Vol.

Fol. 309
Fol.

Ward of Diego Martin
County of St. George
Cadastral Sheet A.14.G&K. (12c)

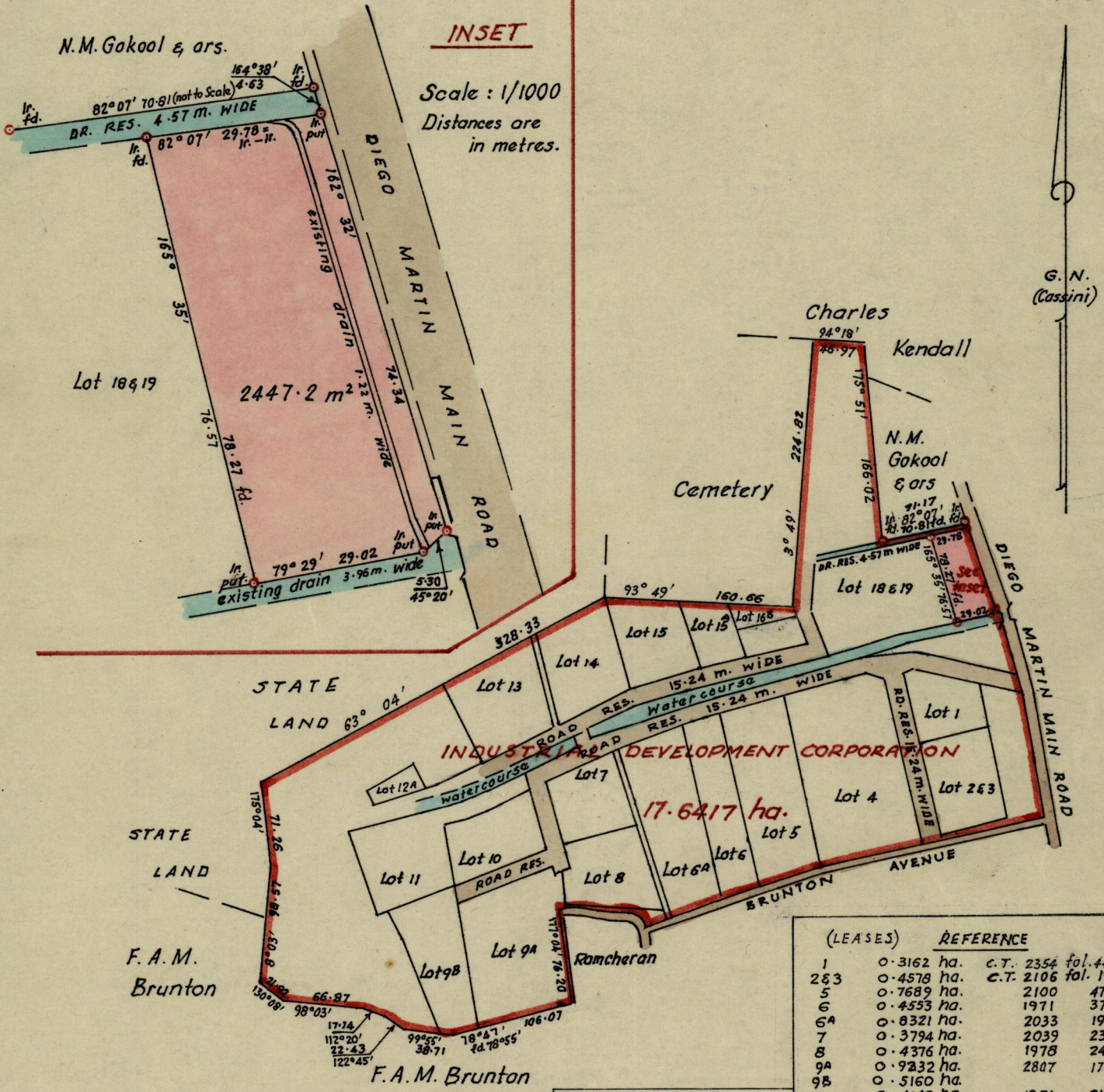

INSET

Scale: 1/1000
Distances are in metres.

(LEASES)	REFERENCE
1	0.3162 ha. C.T. 2354 fol. 447
253	0.4578 ha. C.T. 2106 fol. 19
5	0.7689 ha. 2100 473
6	0.4553 ha. 1971 371
6A	0.8321 ha. 2033 197
7	0.3794 ha. 2039 231
8	0.4376 ha. 1978 247
9A	0.9232 ha. 2807 177
9B	0.5160 ha.
10	0.4148 ha. 1951 215
11	0.6070 ha. 2674 21
13	0.5615 ha. 2074 521
14	0.5109 ha. 2119 439
15	0.4199 ha. 2035 453
15A	0.2656 ha. 2480 237
16	0.1138 ha.
18619	0.8549 ha. 1978 485

11A	C.T. 2674 fol. 27
12A	996.8m ² C.T. 2558 " 33
16B	588.5m ² C.T. 2480 " 257

Approved

K.B. Jones
Director of Surveys
86.9.26

SCALE: 1/5000

Note: To obtain compass bearings ~~add~~ subtract 4 minutes Distances are in metres
PLAN of a Parcel of land coloured pink in the Ward of Diego Martin
Containing two thousand, four hundred & forty-seven point two square metres
Surveyed by me, with due authority, in May 1984.

I certify that I have complied with rule 76 under Section 14 (2) (d) of the Land Surveyors' Ordinance 1952, and that this plan is correct.

Checked by *W.D.* 86/09/26

Therese A. P. ...
Land Surveyor, Trinidad 22nd June 1984