

Nº 48039

R.P.O. Vol. 28
C.T. Vol. 428

Fol. 379
Fol. 449

Ward of Savana Grande
County of Victoria
Cadastral Sheet D. 24. N.

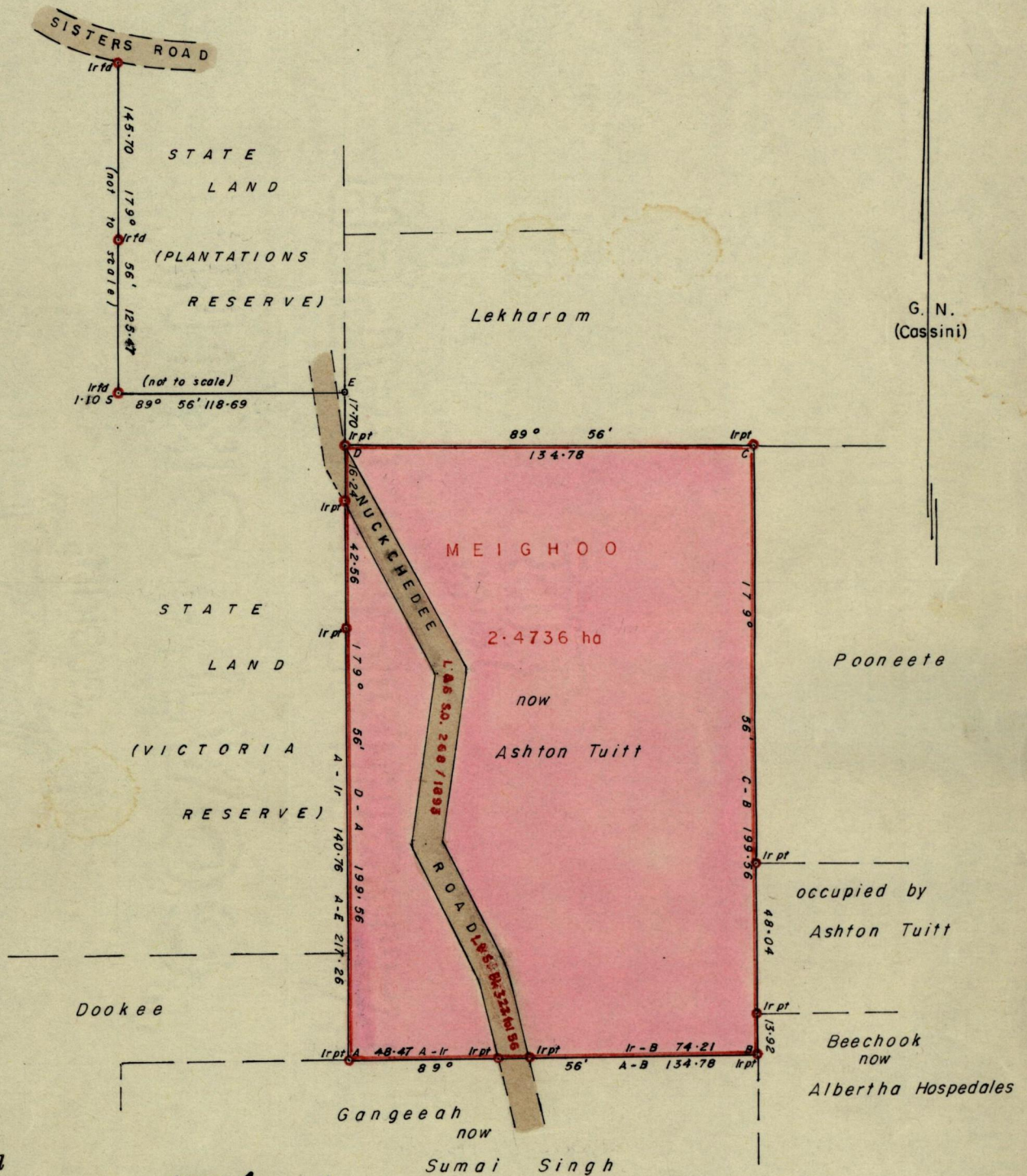

Approved

K.B. Joubert
Director of Surveys
86.8.12

SCALE 1:2000

Note: To obtain compass bearings add/subtract 4 minutes Distances are in metres

PLAN of a Parcel of land coloured pink in the Ward of Savana Grande

Containing two point four seven three six hectares

Redefined Surveyed by me, with due authority, in June 1985

I certify that I have complied with rule 76 under Section 14 (2) (d) of the Land Surveyors' Ordinance 1952, and that this plan is correct.

Checked by *A.D.* 86.8.12

Blanchard

Entered.....

Land Surveyor, Trinidad 19th September 1985