

REMAINING PORTION

63E.

R.P.O. Vol. 97

Fol. 121

Cadastral Sheet G. 13.E. 2/d.

C. of T. Vol.

Vol.

Ward of Siparia.

County of St. Patrick.

Plan B653

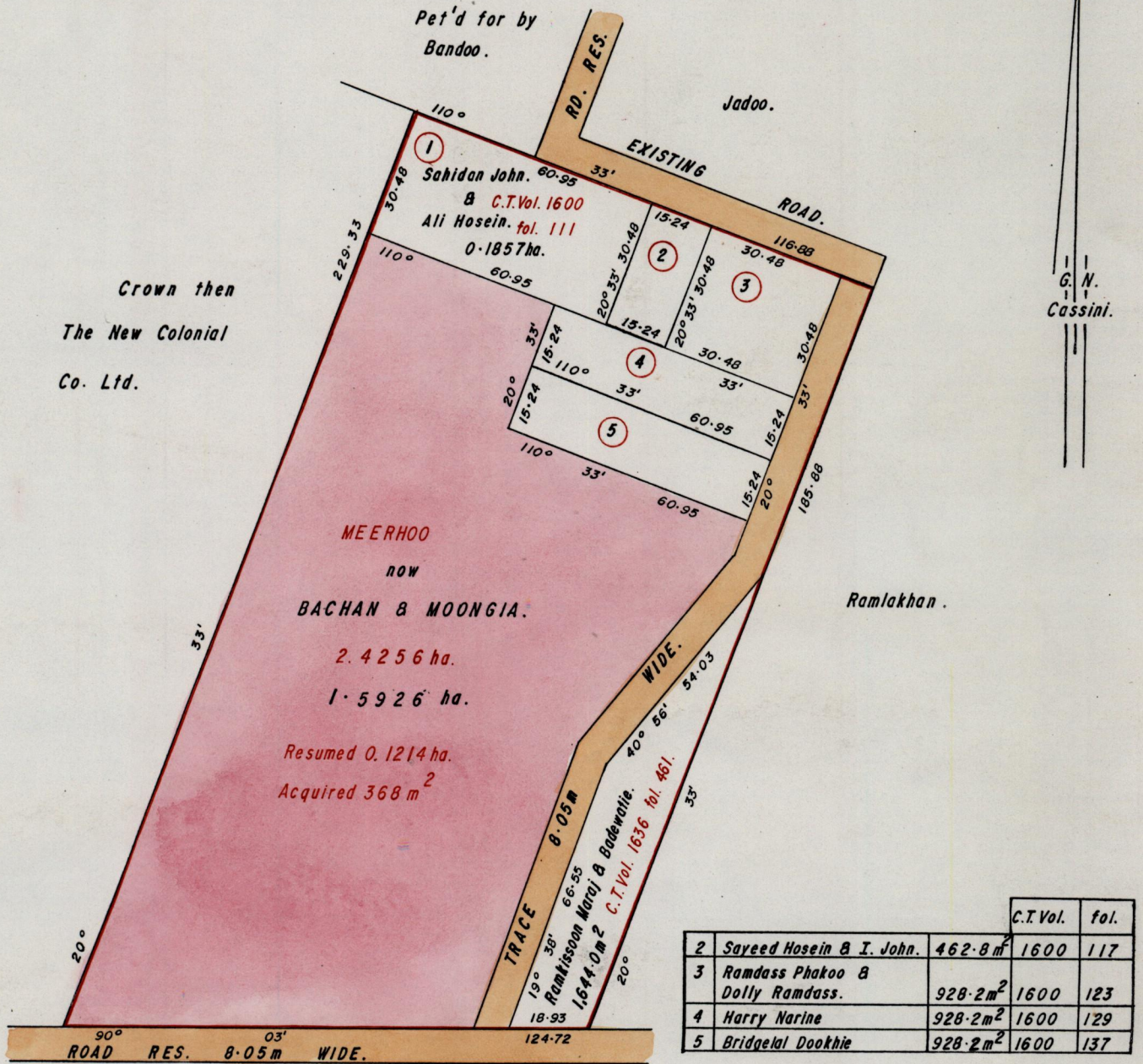

Approved

[Signature]
 Director of Surveys
 980204

Note: To obtain compass bearings add subtract minutes

Bearings are based on Solar Obs. (Cassini Grid.)

SCALE 1/1500

Distances are in metres.

This is a true copy of a diagram of two point four two five six hectares, originally granted to MEERHOD, coloured pink and containing one point five nine two six hectares, being the remainder after one acquisition, one resumption and six previous transfers of other portions of the land, the dividing lines having been run in conformity with Rule 76 under Sec. 7(d) of Cap. 27. No. 2 and duly certified by the Director of Surveys.

Checked by AMZ 98.1.28

Entered on

[Signature]
 Land Surveyor, Trinidad, 12th January 19.98.