

No 26697

R.P.O. Vol.  
C.T. Vol. 2479

Fol.  
Fol. 345

Ward of Tobago.  
Parish of St. Andrew.  
Cadastral Sheet 1. 17. L;  $\frac{2G}{3/6/4}$

Ref: BK.1049 fol. 5

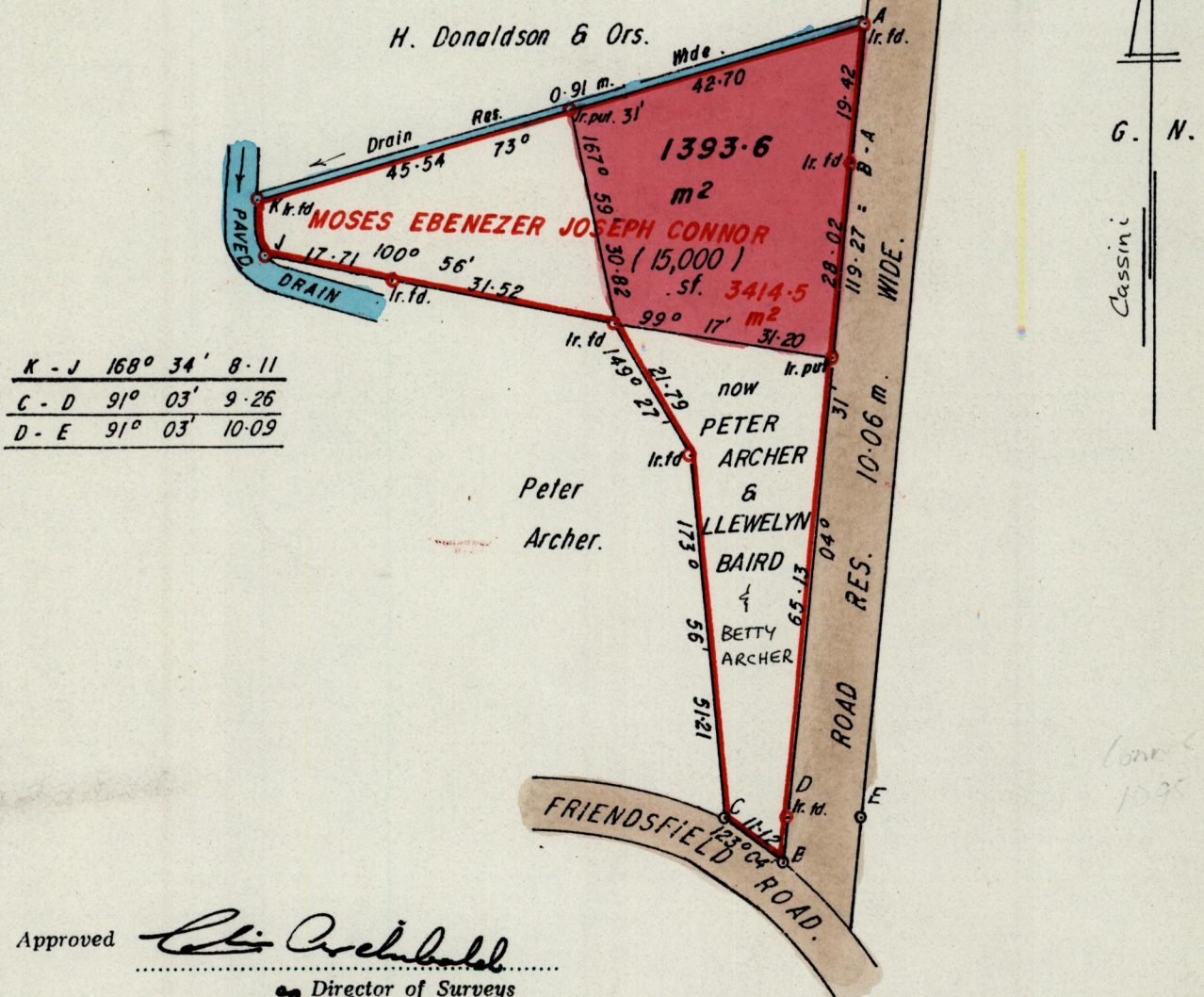

Approved *Colin Archibald*  
Director of Surveys  
960306

SCALE 1 / 1000  
minutes

Distances are in metres.

Note: To obtain compass bearings add/subtract

PLAN of a Parcel of land coloured pink in the Ward of Tobago.  
Containing one thousand three hundred and ninety three point six square metres.  
Surveyed by me, with due authority, in October 1992

I certify that I have complied with rule 76 under section 14(2)(d) of the  
Land Surveyors' Ordinance 1952, and that this plan is correct.

Checked by *G. Johnson 14/2/96* ..... *Horace A. Achille* .....  
Entered ..... Land Surveyor, Trinidad and Tobago *4\* Meuch* ..... 19.9.94