

No 17690

1145

679

R.P.O. Vol. 278  
C.T. Vol.

Fol. 1  
Fol.

Ward of Tamana  
County of St. Andrew (25 D)  
Cadastral Sheet C. 21. M. (2/d)

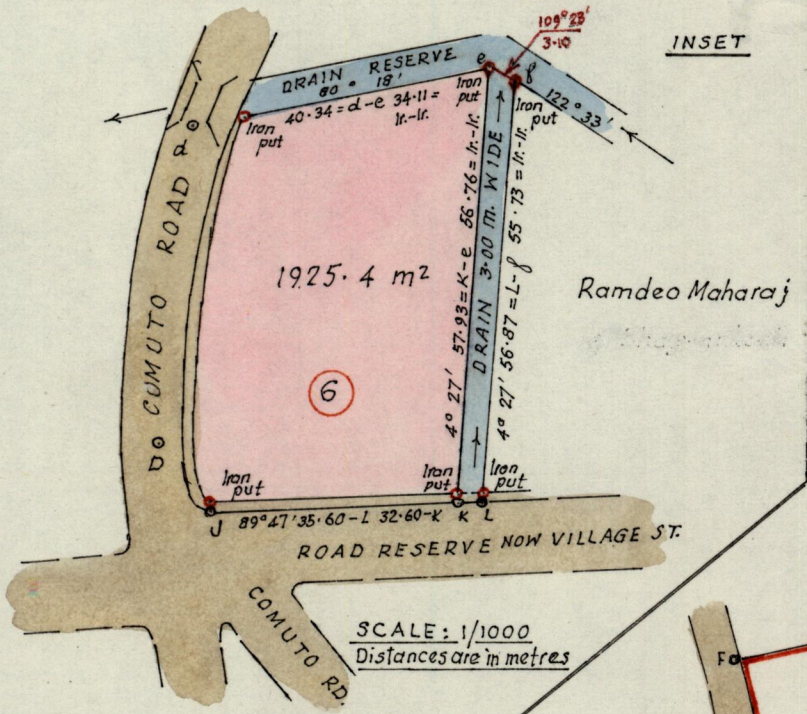

See L.S. Bk. 1115 fol. 32  
L.S. Bk. 38 fol. 185  
See Survey Order 169/1923

G. N. (Cassini)

SCALE: 1/1000  
Distances are in metres

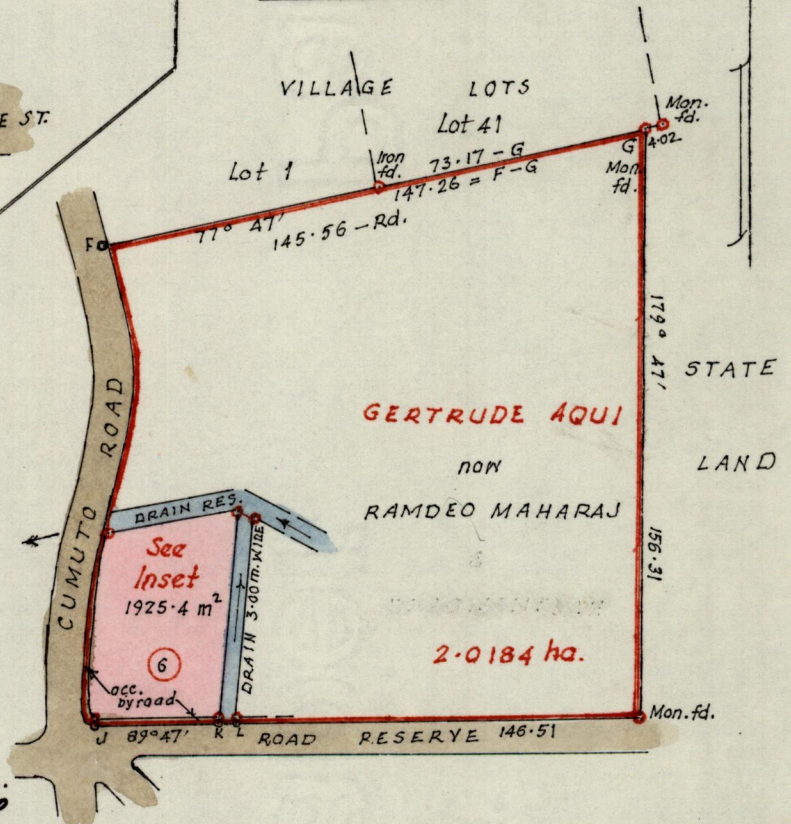

Along Cumuto Road

D	11.72	d	42.02
	9.50		40.42
	8.53		40.23
	6.04		20.18
	2.73		20.12
	1.13		18.96
	0		5.08
	J		0
			D

acc. by road 2.34, 3.36, 0.89, 0.56 @ lr. put

Approved

*Law Charles*  
Director of Surveys  
95.12.14

SCALE: 1/2000

Note: To obtain compass bearings add/subtract 13 minutes Distances are in metres

PLAN of a Parcel of land coloured pink in the Ward of Tamana  
Containing one thousand, nine hundred & twenty-five point four square metres  
Surveyed by me, with due authority, in October 1994

I certify that I have complied with rule 76 under section 14(2)(d) of the  
Land Surveyors' Ordinance 1952, and that this plan is correct.

Checked by *A. D. D. 12/95*

*Seal & Signature*  
Land Surveyor, Trinidad 28th October 1995

Entered .....