

REMAINING PORTION

R.P.O. Vol. 108

Fol.511

Ward of Siparia

C.T. Vol. 1827

Fol.177

County of St.Patrick

Cadastral Sheet G.12.B. 630/2/b

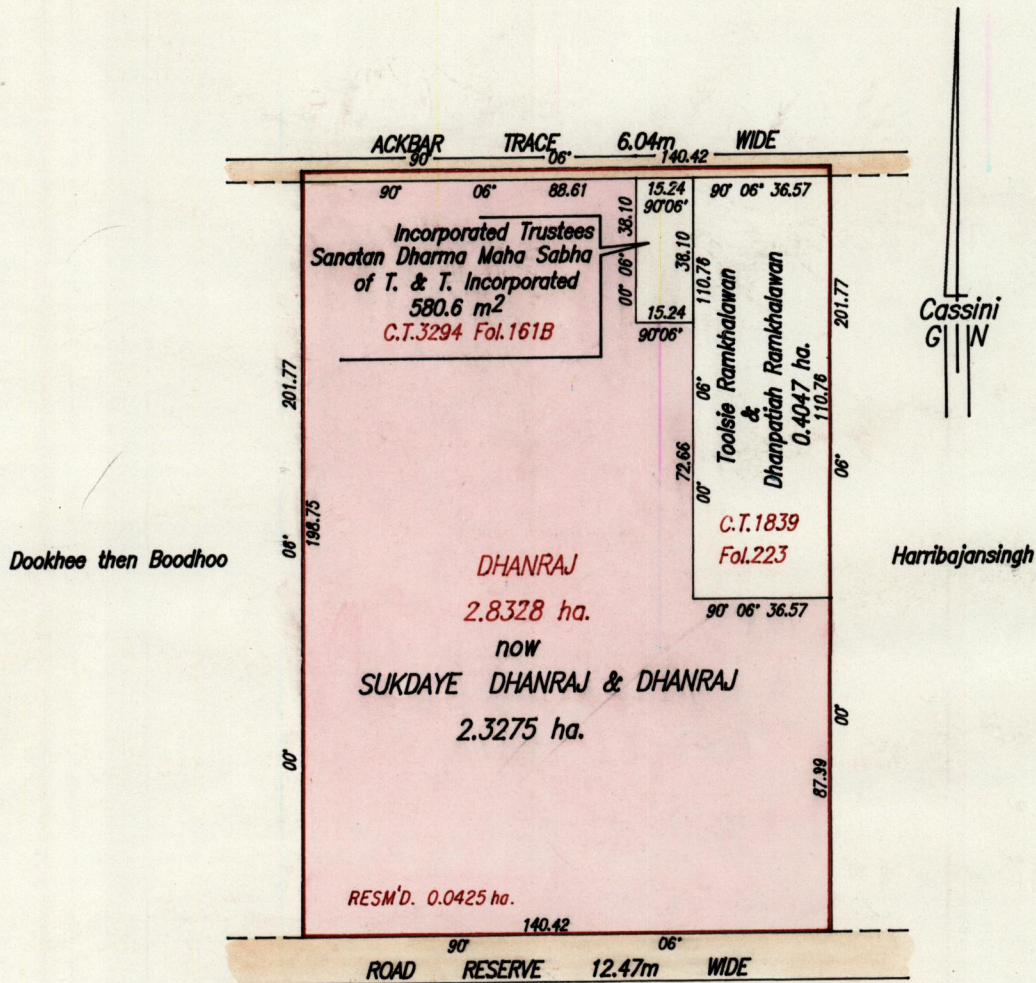

SCALE 1/2000

Approved

[Signature]
 Director of Surveys
 95.11.15

Distances are in Metres

This is a true copy of a diagram of two point eight three two eight originally transferred to Dhanraj, showing a portion coloured pink and containing two point three two seven five hectares being the remainder after 2 previous transfers and 1 resumption of another portion of the land. The dividing lines have been run in conformity with rule 76 under sec. 14 (2) (d) of the Land Surveyor's Ordinance 1952 and duly certified by the Director of Surveys

Checked by: *[Signature]* 14/11/95

[Signature]
 Land Surveyor, Trinidad & Tobago. 25/5/95. 19...

Entered

GANESHDATH RAMCHARITAR
LAND SURVEYOR

Original Survey BK 467:168
Remaining portion plan
BK 1175 fol. 133

24
15
16
17