

REMAINING PORTION

R.P.O. Vol. 248 Fol. 85

C. of T. Vol. 1648 Vol. 301

Cadastral Sheet E. 21.1

Ward of Charuma

County of Nariva

1145

61

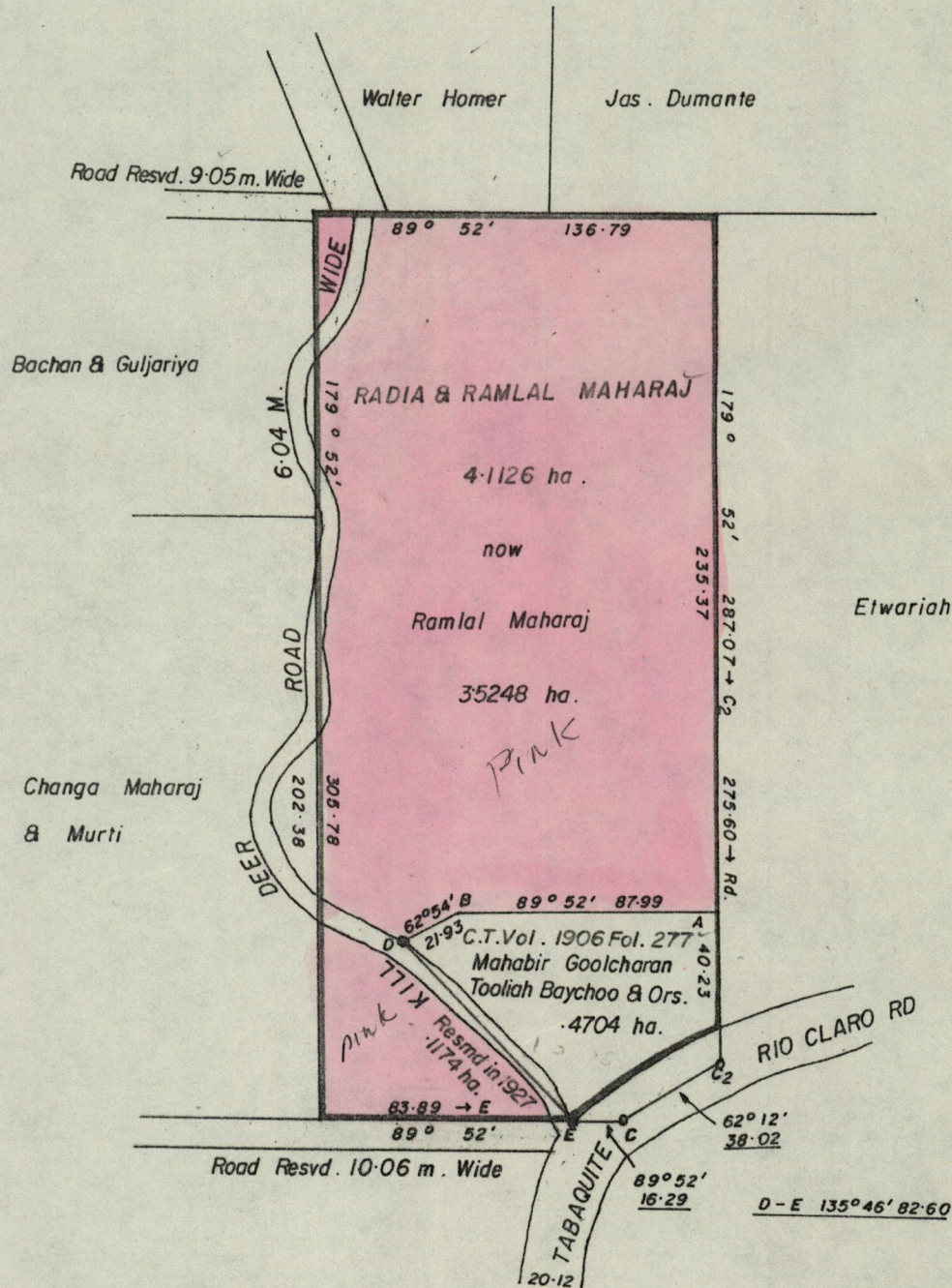

Approved

K.B. Ford
 Director of Surveys
 86.2.07

SCALE 1: 2500

Note: To obtain compass bearings *add* 8 minutes
~~subtract~~

Distances are in metres

This is a true copy of a diagram of four point one one two six hectares originally granted to Radia and Ramlal Maharaj, shewing a portion coloured pink and containing three point five two four eight hectares being the remainder after one Resumption and one previous transfer of another portion of the land. the dividing lines having been run in conformity with Rule 76 under Sec. 7(d) of Cap. 27. No. 2 and duly certified by the Director of Surveys.

Checked by *J.D. 86.2.7*

Entered on

S. Alliecharan
 Land Surveyor, Trinidad,

20-1-1986