

REMAINING PORTION

R.P.O. Vol. 149 Fol. 46  
C. of T. Vol. 1737 Vol. 105

1145

Cadastral Sheet  $\frac{73A}{2/a}$  G.17.A 551  
Ward of Siparia  
County of St. Patrick  
Vide L&S Bk. 999 fol. 49  
Bk. 1066 fol. 82

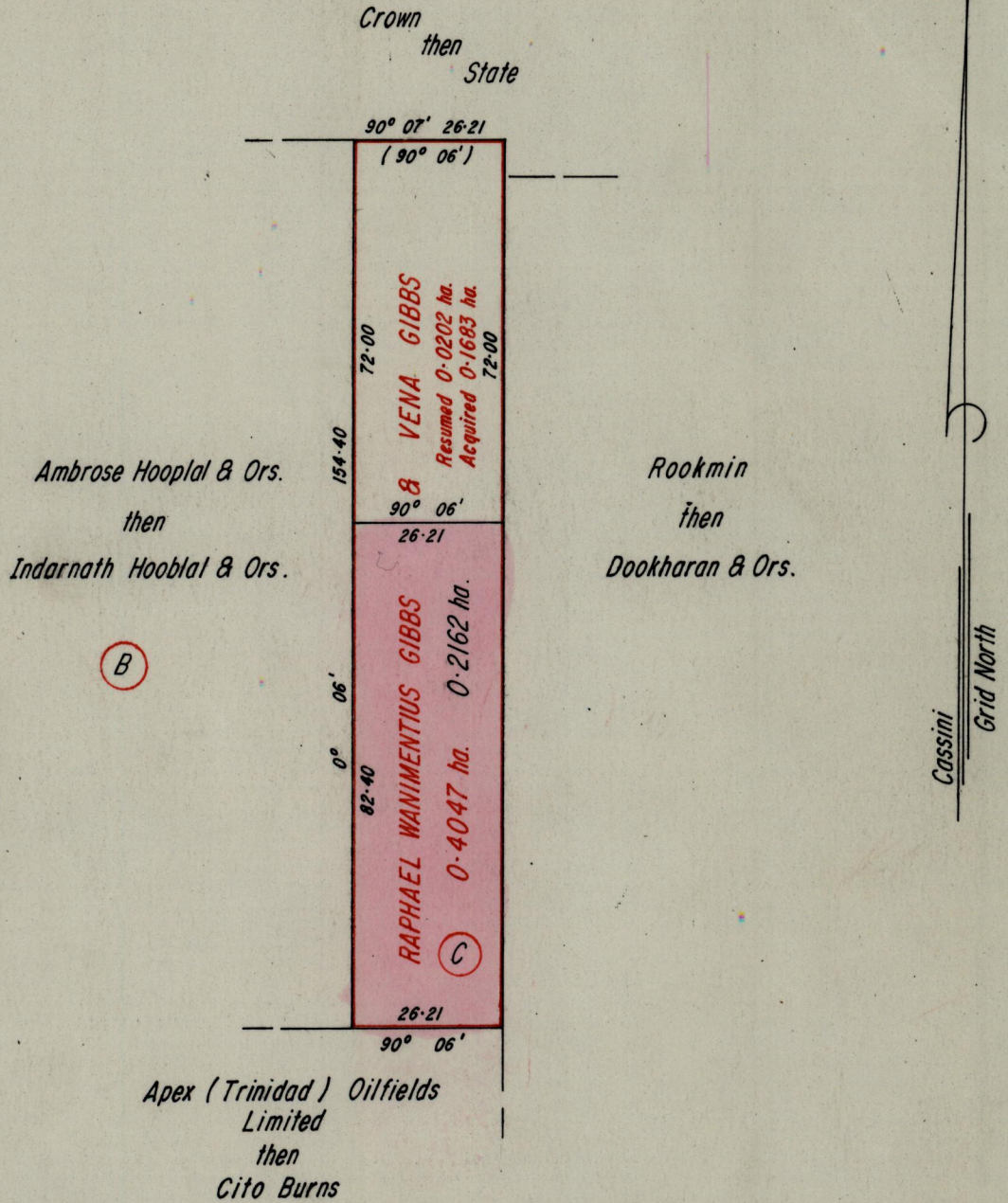

Approved

*Francis Charles*  
Director of Surveys  
95-07-11

Note: Bearings are Grid, based on Solar Observations.

SCALE 1:1250

Note: To obtain compass bearings add subtract minutes

Distances are in metres.

This is a true copy of a diagram of point four zero four seven of a hectare originally granted to RAPHAEL WANIMENTIUS GIBBS & VENA GIBBS, shewing a portion coloured pink and containing point two one six two of a hectare being the remainder after one acquisition and one resumption ~~previous transfer of another portion of the land.~~ the dividing lines having been run in conformity with Rule 70 under Sec. 14(2)(d) of the Land Surveyors' Ordinance 1952 ~~7(d) of Cap. 27, No. 2~~ and duly certified by the Director of Surveys.

Checked by *Abdul Mustafa*

Entered on

*Colin Campbell*  
Land Surveyor, Trinidad, ..... Dec 1<sup>st</sup> 1973.