

REMAINING PORTION

1145

545

R.P.O Vol 11

Fol 151

Cadastral Sheet 73A G.12.0
1/a

C.T. Vol 484

Fol 735

Ward of Siparia

County of St Patrick

Vide Bk .1196 Fol.392

G. N

Cassini

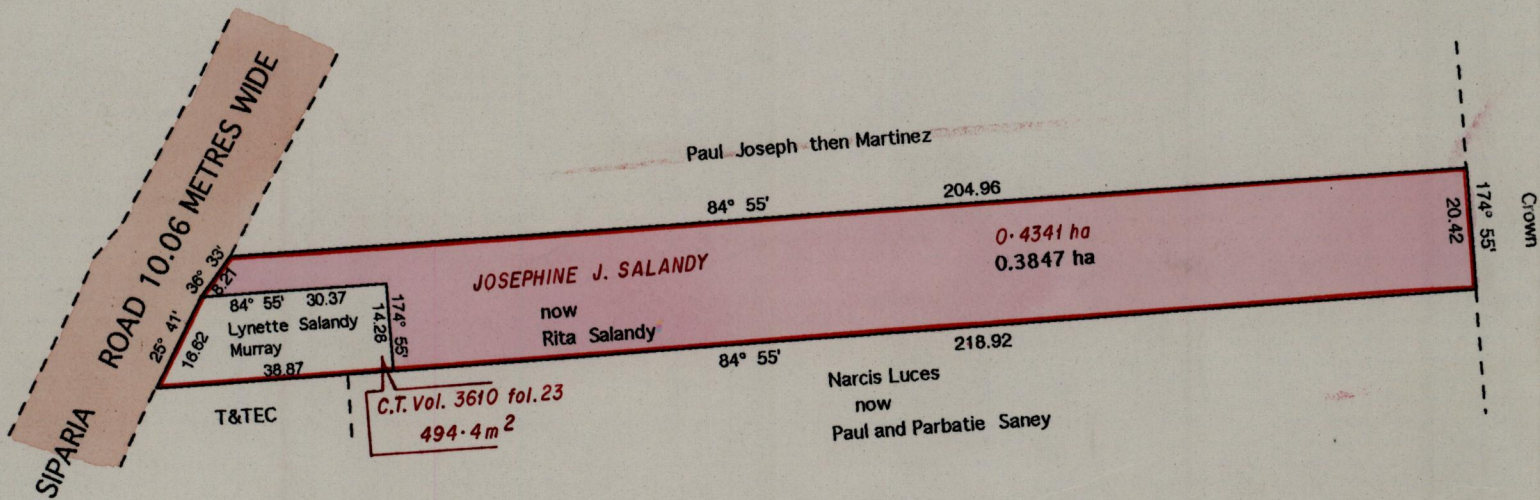

Approved..... *Liam Cole*
 Director of Surveys
 95-07-11

Bearings are Cassini Grid based on Solar Obs.

This is a true copy of a diagram of point four three four one hectares transferred to Josephine Salandy coloured pink and containing point three eight four seven hectares after one previous transfer of another portion of the land. the dividing lines having been run in conformity with rule 76 under section 14(2)(d) of the Land Surveyors' Ordinance 1952 and duly certified by the Director of Surveys.

SCALE 1 : 1250

Distances are in metres

originally

,shewing a portion

being the remainder

previous transfer of another portion of the land.

Checked by *Andy 1 May 95*
 Entered by

Ronald Lewis
 Land Surveyor, Trinidad & Tobago 10th December 1994.