

R.P.O. Vol. 725 fol. 455
C.T. Vol. 1029 fol. 215

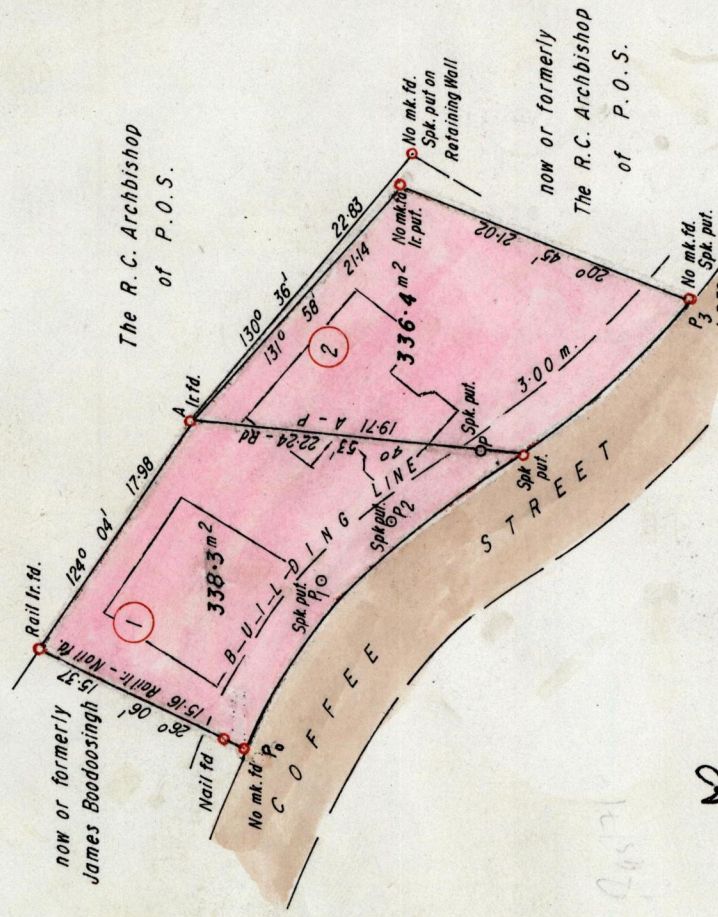

Approved *James Chapp*
Director of Surveys
95.07.09

INSET
SCALE 1 / 500
See Bk. 980 : 193

P0	P1	113° 00'	12.26
P1	P2	137° 55'	5.93
P2	P3	144° 54'	25.51
P	P3	144° 54'	17.30

Bearings are Cassini based on Solar Obs.

PLAN of 2 Parcels of land coloured pink in the City of San Fernando
Containing together six hundred and seventy four point seven square metres
Surveyed by me with due authority in August 1993

I certify that I have complied with rule 76 under Section (14) 2 (d) of the
Land Surveyors' Ordinance 1952, and that this plan is correct.

Keith Marcellus Scott
Licensed Land Surveyor

Checked by *A.D.* 24/4/95
Ent. on

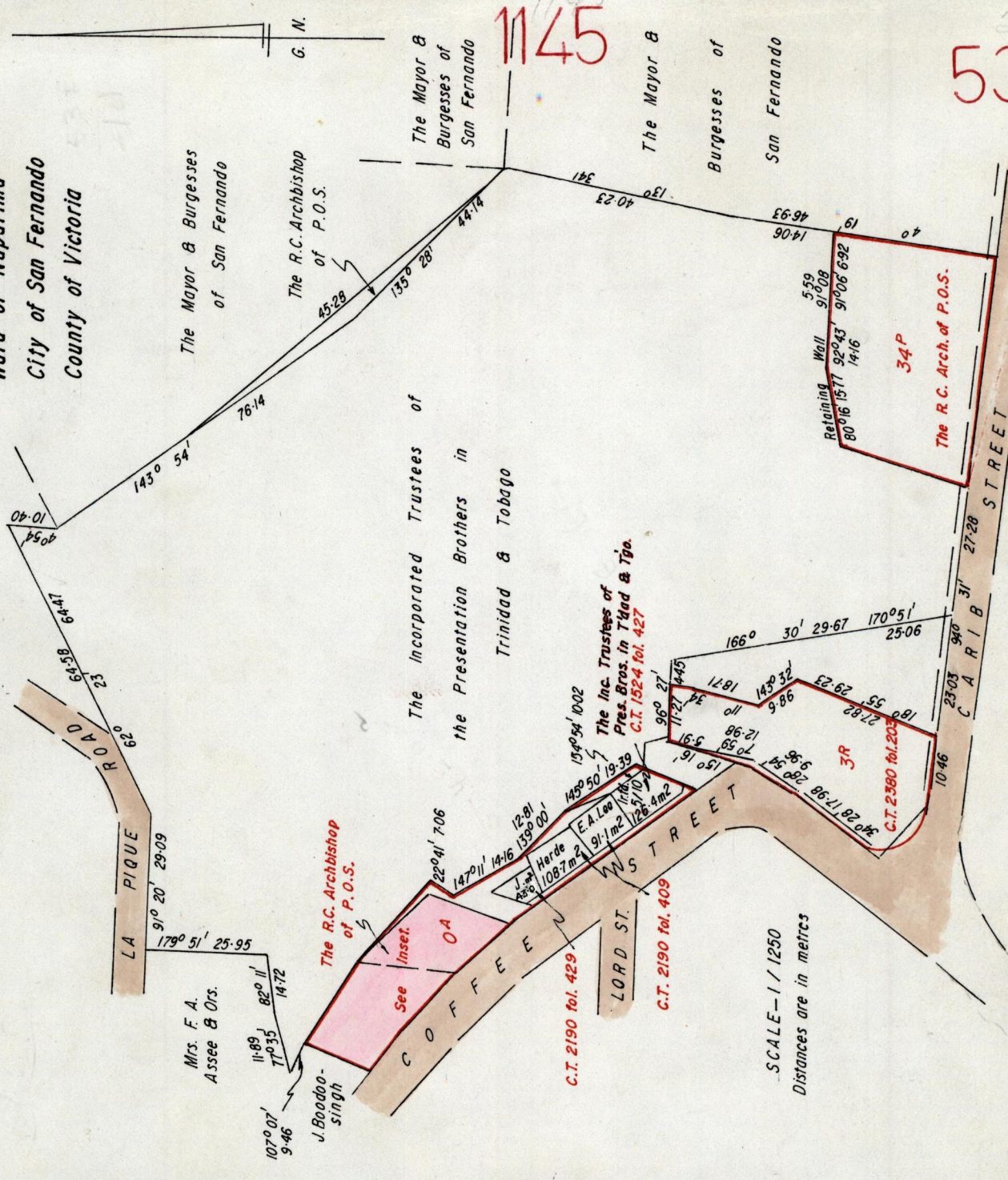

SCALE - 1 / 1250
Distances are in metres

Keith Marcellus Scott
Land Surveyor
Trinidad & Tobago

February 6th 1995

1145

539

Orig survey BK. 897: 74

