

1145

530

530

Ward of Turure
County of St. Andrew

To be Consolidated

Cadastral Sheet C.21.P. ^{25F}/_{1/c}

Cassini
G | W

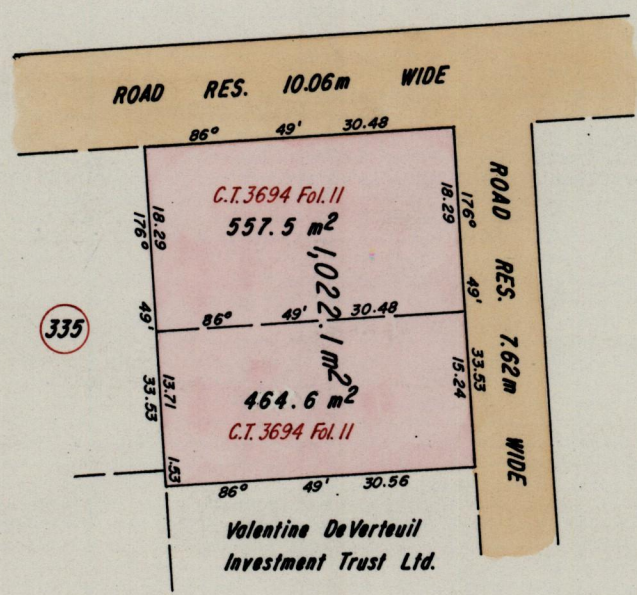

Bastola

Approved. *Jan Cholo*
Director of Surveys # 95-06-23

SCALE 1/750
Distances are in Metres

Note: To obtain compass bearings add 16 minutes
Plan of 2 Parcels of land coloured pink in the Ward of Turure
Containing together one thousand and twenty two point one square metres
Compiled by me, with due authority, in November 1994

Checked. *D.R. 29/1/95* *Ganeshdatt Ramcharan*

Entered. Land Surveyor, Trinidad & Tobago. *16/1/94* .19.