

REMAINING PORTION

R.P.O. Vol. 712

Fol. 365

1145

Cadastral Sheet D. 25.1.

51

C. of T. Vol.

Vol.

Ward of Charuma

County of Nariva

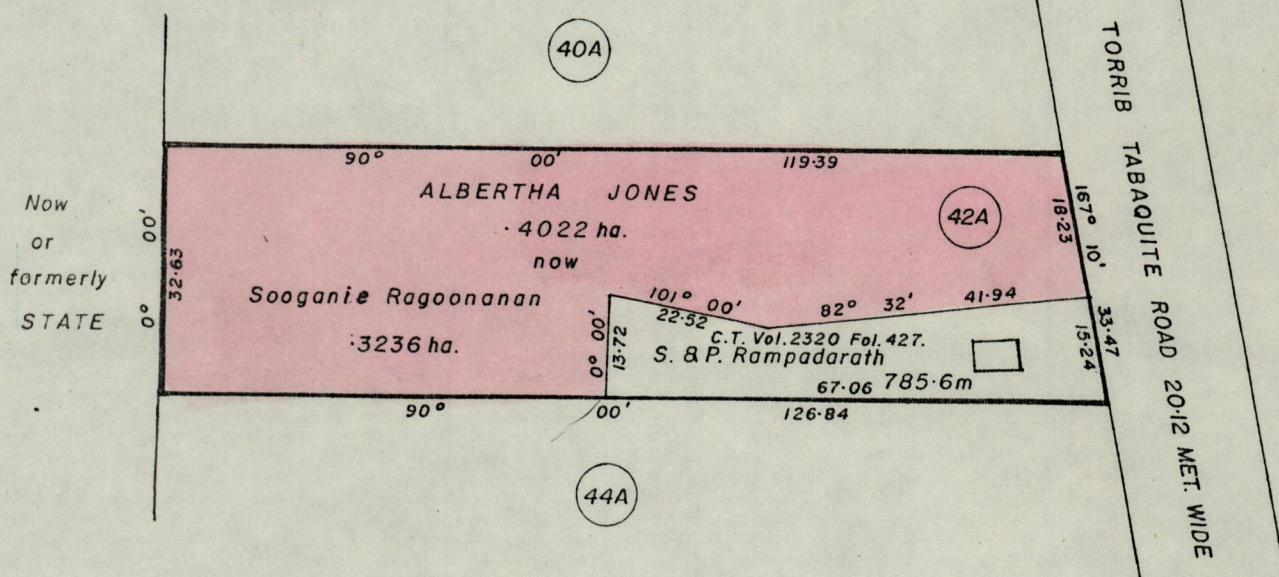

Approved

*K.B. Joseph*

Director of Surveys

85-11-20

SCALE 1 - 1000

Note: To obtain compass bearings

add 4- minutes  
subtract

Distances are in metres

This is a true copy of a diagram of Point Four zero two two hectares originally granted to ALBERTHA JONES, shewing a portion coloured pink and containing Point Three two three six hectares being the remainder after one previous transfer of another portion of the land. 14 (2)(d) of the Land Surveyors' Ordinance 1952, the dividing lines having been run in conformity with Rule 76 under Sec. ~~27 of Chap. 27: 27: 27~~ and duly certified by the Director of Surveys.

Checked by *AK* 85-11-19

Entered on

*S. Alliee Ram*

Land Surveyor, Trinidad,

6/11/1985