

469

1145

L. & S.—56

REMAINING PORTION # 14

84-4-9

5

R.F.O. Vol. 97

Fol. 193

1145

Cadastral Sheet G.13.G.

C. of T. Vol.

Vol.

Ward of Siparia

Remaining Portion Plan R.P.O. Vol. 1936 fol. 285.

County of St. Patrick

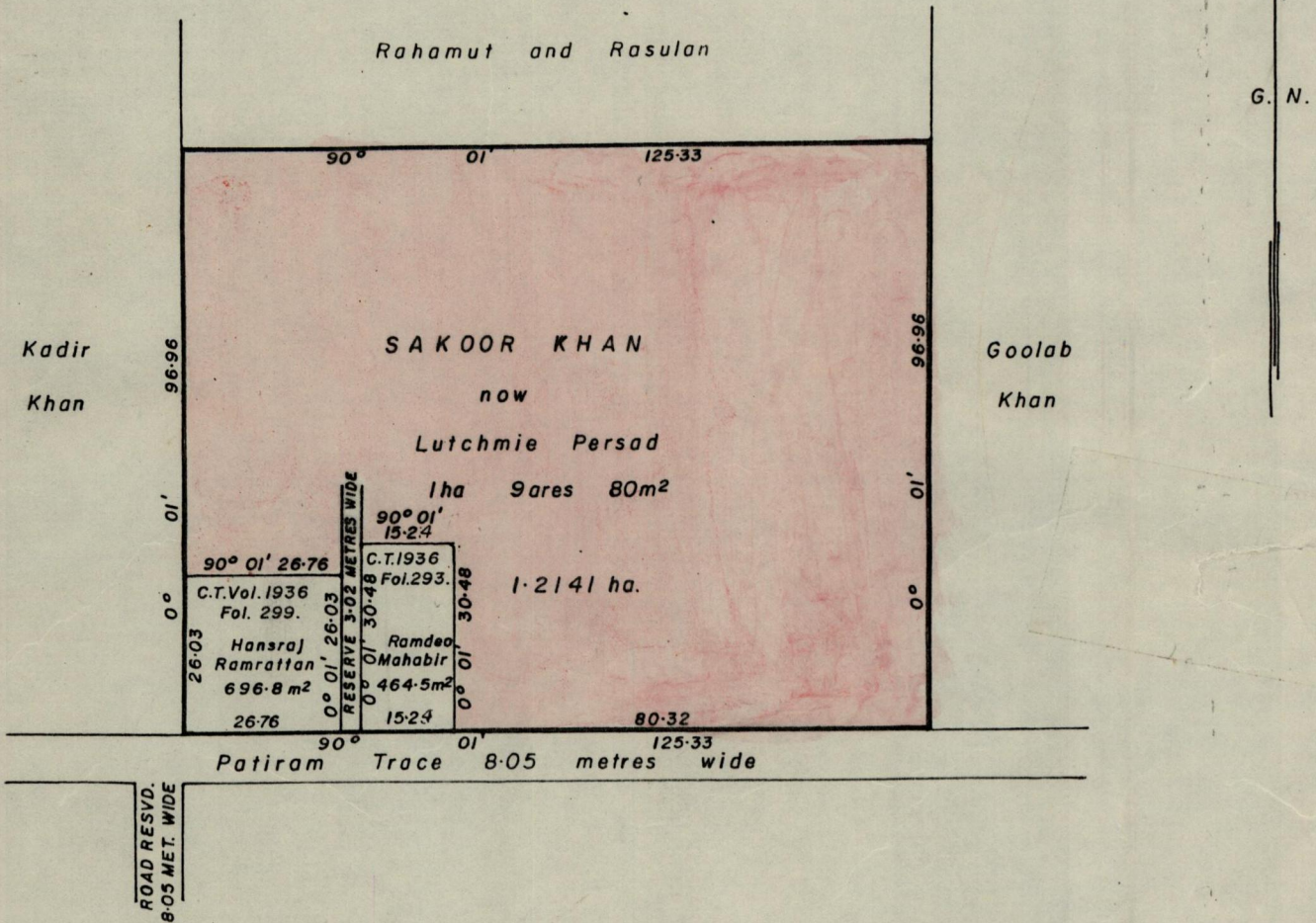

Approved

K.B. Joseph
Director of Surveys
85-1-17

SCALE 1-1250

Note: To obtain compass bearings

add 1 minutes
subtract

Distances are in metres.

This is a true copy of a diagram of One hectare, twenty-one ares and forty-one square metres originally granted to SAKOOR KHAN, shewing a portion coloured pink and containing One hectare, nine ares and eighty square metres being the remainder after two

previous transfers of other portions of the land.
14 (2)(d) of the Land Surveyors' Ordinance 1952,

the dividing lines having been run in conformity with Rule 76 under Sec. 7(1) of Cap. 27. No. 2 and duly certified

by the Director of Surveys.

Checked by *A* 85-1-17

Entered on

Lawrence Clarke
Land Surveyor, Trinidad, 6th April 1984