

REMAINING PORTION

R.P.O. Vol. 140 Fol. 333  
C. of T. Vol. 1776 Vol. 301

1145

Cadastral Sheet  $\frac{73A}{2/a}$  G. 17. A  
Ward of Siparia  
County of St. Patrick  
Vide L&S Bk. 999 fol. 152  
Bk. 1066 fol. 82

494

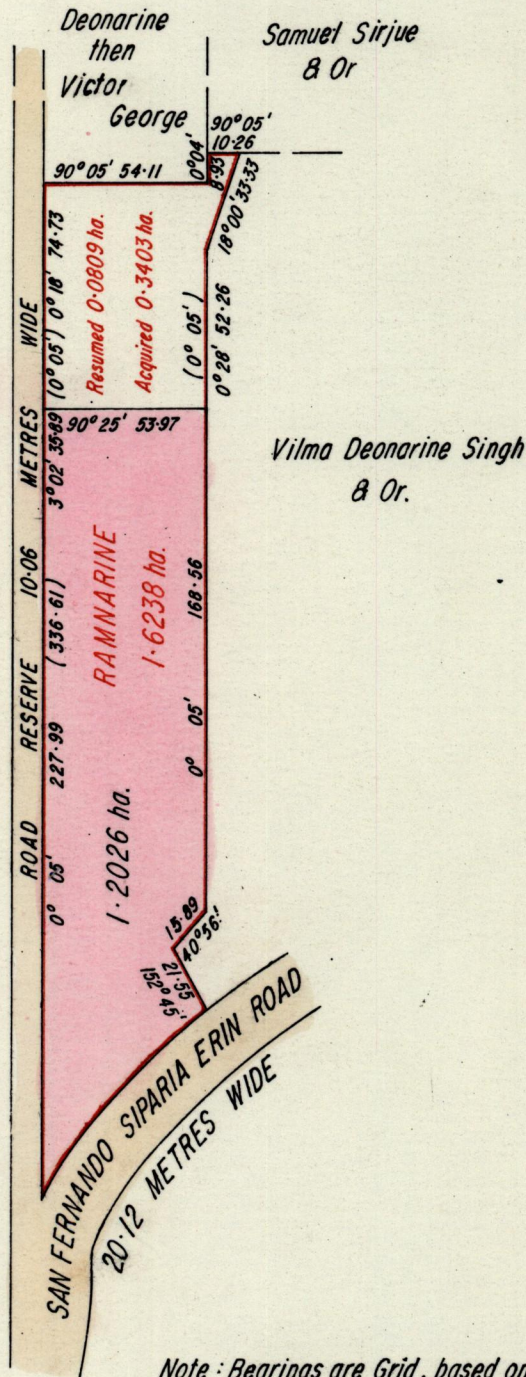

Approved

*Francis Charles*  
Director of Surveys  
95-04-24

Note: To obtain compass bearings

add  
subtract minutes

Note: Bearings are Grid, based on Solar Observations.

SCALE 1 : 2500

Distances are in metres.

This is a true copy of a diagram of transferred ~~granted~~ to

one point six two three eight hectares  
RAMNARINE

originally

coloured pink and containing

one point two zero two six hectares

, shewing a portion

being the remainder

after

one (1) acquisition and one (1) resumption

~~previous transfer of another portions~~ of the land.

the dividing lines having been run in conformity with Rule 76 under Sec. 7(2) of Cap. 27. No. 2 and duly certified

by the Director of Surveys.

Checked by *Abel*

Entered on

*C. C. ...*

Land Surveyor, Trinidad, Dec 1<sup>st</sup> 1993.