

REMAINING PORTION

R.P.O. Vol. 140

Fol. 333

1145

Cadastral Sheet  $\frac{73A}{2/a}$  G. 17. A

493

C. of T. Vol. 3201

Vol. 201

Ward of Siparia

County of St. Patrick

Vide L & S Bk. 999 fol. 152

Bk. 1066 fol. 82

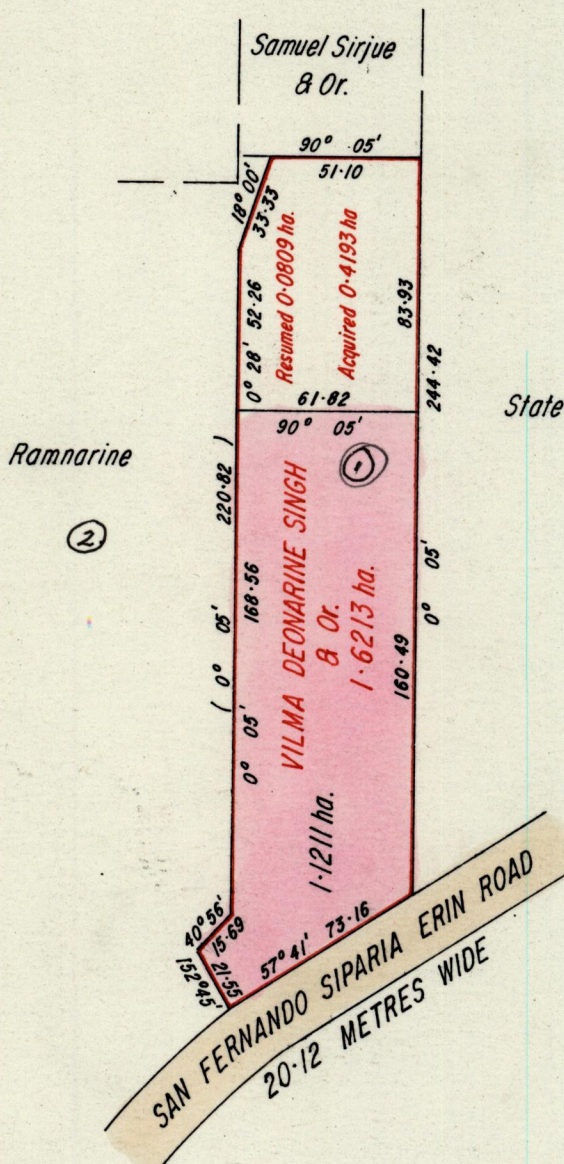

Approved

*Land Chand*  
 Director of Surveys  
 95.04.24

Note: Bearings are Grid, based on Solar Observations.

SCALE 1 : 2500

Note: To obtain compass bearings add subtract minutes

Distances are in metres.

This is a true copy of a diagram of one point six two one three hectares originally transferred granted to VILMA DEONARINE SINGH & Or. , shewing a portion coloured pink and containing one point one two one one hectares being the remainder after one (1) acquisition and one (1) resumption ~~previous transfer of another portions of the land.~~ the dividing lines having been run in conformity with Rule 76 under Sec. 14(2)(d) of the Land Surveyors' Ordinance 1952 ~~of Cap. 27. No. 2~~ and duly certified by the Director of Surveys.

Checked by *Arlo 4/2/75*  
 Entered on

*Land Surveyor, Trinidad, Dec 19 93*