

1145

476

R.P.O. Vol. 651 Fol. 563
 R.P.O. Vol 81 Fol. 69
 C.T. Vol. 2006 Fol. 513
 Consolidated Plan R.P.O. Vol. 2006 Fol. 511.

Ward of Siparia
 County of St. Patrick
 Cadastral Sheet G-12-G $\frac{63E}{1/c/4}$

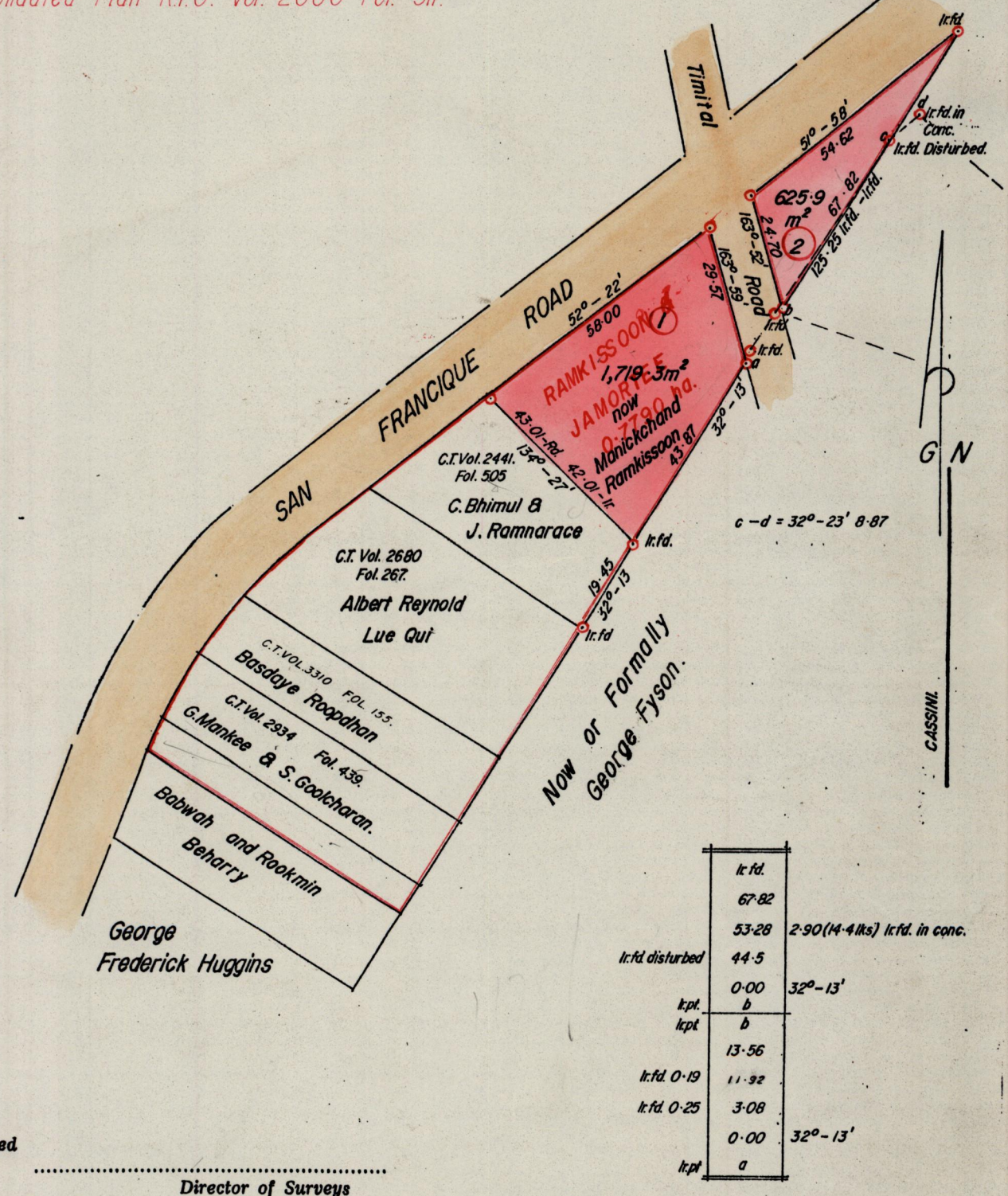

Approved
 Director of Surveys

○ Denotes iron put unless stated otherwise
 Note: To obtain compass bearings add/subtract minutes Distances are in Metres

PLAN of 2 Parcelsof land coloured pink in the Ward of Siparia.
 Containing together two thousand three hundred and forty five point two sq. metres
 Surveyed by me, with due authority, in September, 1993.
 I certify that I have complied with rule 76 under section 14(2)(d) of the
 Land Surveyors' Ordinance 1952, and that this plan is correct.

Checked by *A. B. ... 7/3/95*
 Entered Land Surveyor, Trinidad 2 Sept 1993