

REMAINING PORTION

R.P.O. Vol. 254 Fol. 17

C. of T. Vol. 2422 Vol. 109

1145

Cadastral Sheet G. 13 . P.

63.E 472  
4/d

Ward of Siparia.

County of St. Patrick.

G N  
CASSINI

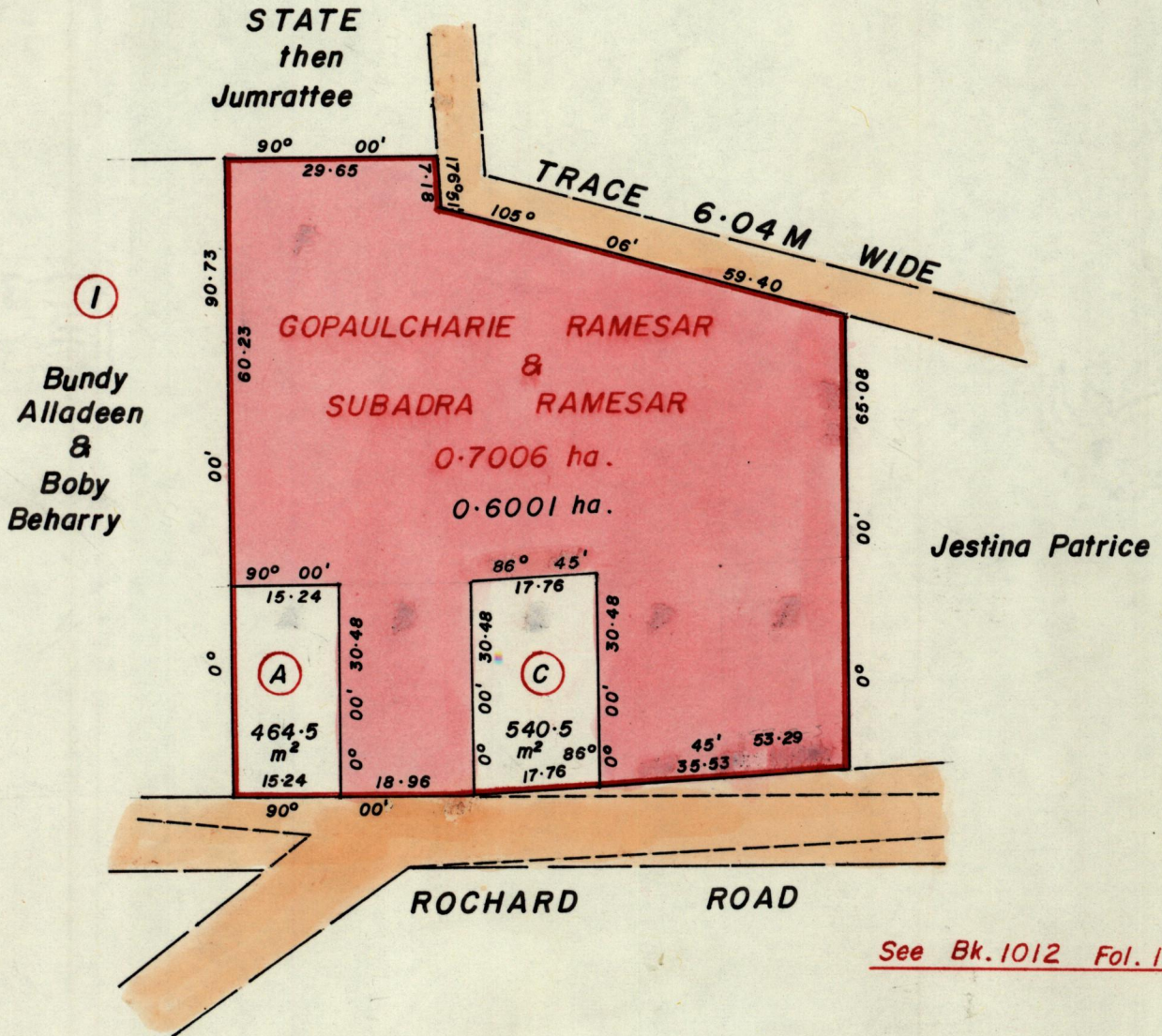

See Bk. 1012 Fol. 112

LOT	NAME	C.T. Vol.	Fol.
A	Bindawati Lalgee	3209	387
C	Ramcharan Ramlakhan & Subadra Ramesar	3348	85

Approved  
*[Signature]*  
Director of Surveys  
95.03.27

SCALE 1 : 1000.

Note: To obtain compass bearings add 0 minutes  
subtract

Distances are in metres.

This is a true copy of a diagram of **point seven zero zero six hectares** originally transferred ~~granted~~ to **GOPAULCHARIE RAMESAR & SUBADRA RAMESAR**, shewing a portion coloured pink and containing **point six zero zero one hectares** being the remainder after **two (2)** previous transfers of ~~an~~ other portions of the land. **14(2)(d) of the Land Surveyors' Ordinance 1952** the dividing lines having been run in conformity with Rule 76 under Sec. 74 of Cap. 27, No. 1 and duly certified by the Director of Surveys.

Checked by *[Signature]* 7/3/95

Entered on

LANDS AND SURVEYS VAULT RECORDS *[Signature]*  
Land Surveyor, Trinidad, 31/10/1994.