

1145

469

No

21652

R.P.O. Vol.
C.T. Vol.

Fol.
Fol.

Ward of Tobago
Parish
County of St. Andrew 1J
Cadastral Sheet I. 21. 2/b

CONSOLIDATED PLAN

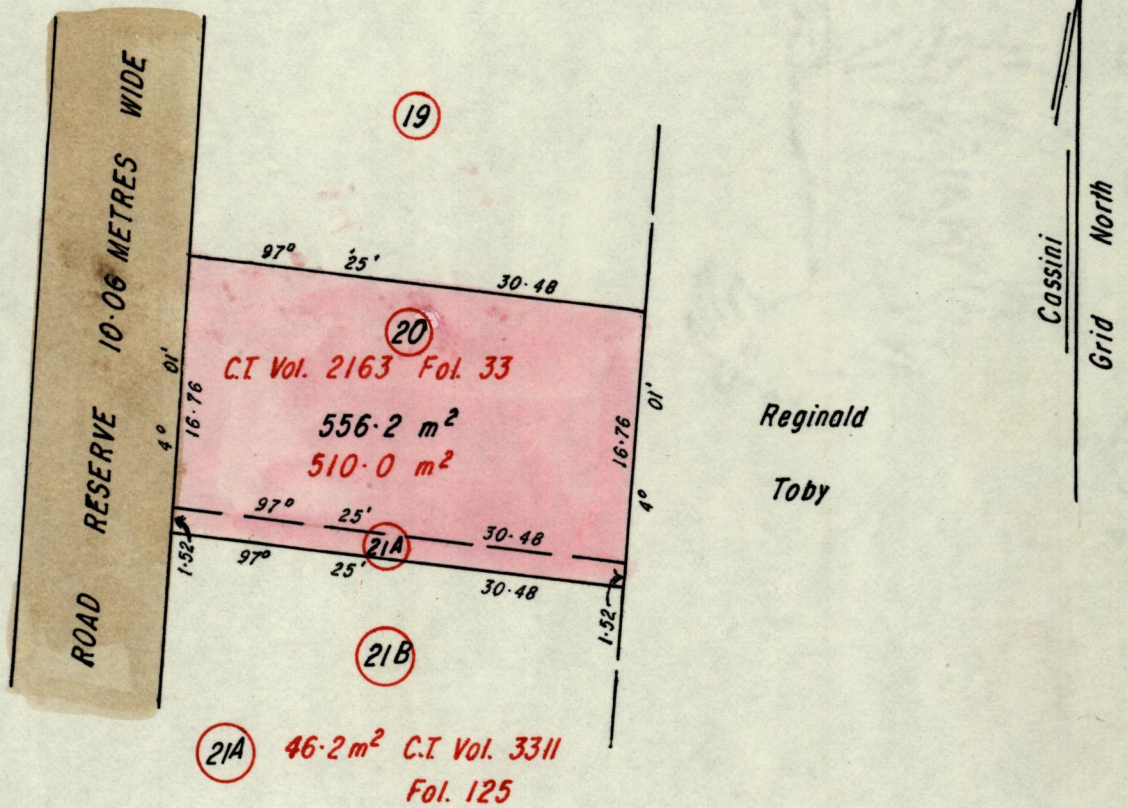

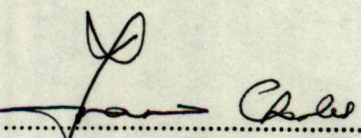
Approved 
 Director of Surveys
 95-03-20

SCALE 1/500

Note: To obtain compass bearings add/subtract minutes Distances are in metres

PLAN of 2 Parcels of land coloured pink in the Ward of Tobago
 Containing together five hundred and fifty six point two square metres
 Prepared by me, with due authority, in January, 1995

I certify that I have complied with rule 76 under section 14(2)(d) of the
 Land Surveyors' Ordinance 1952, and that this plan is correct.

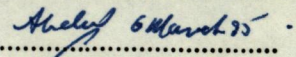
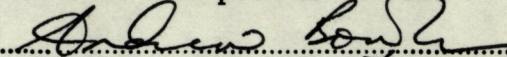
Checked by  6 March 95
 Entered  7th February 1995
 Land Surveyor, Trinidad and Tobago