

No 22791

1145

451

R.P.O. Vol.
C.T. Vol. 3118

Fol.
Fol. 175

Ward of Tobago
Parish of St. Patrick
Cadastral Sheet I. 16. D. $\frac{1C}{37/871}$

Bk. 1149 Fol. 113

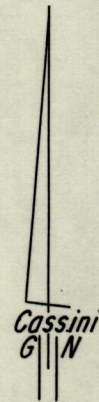
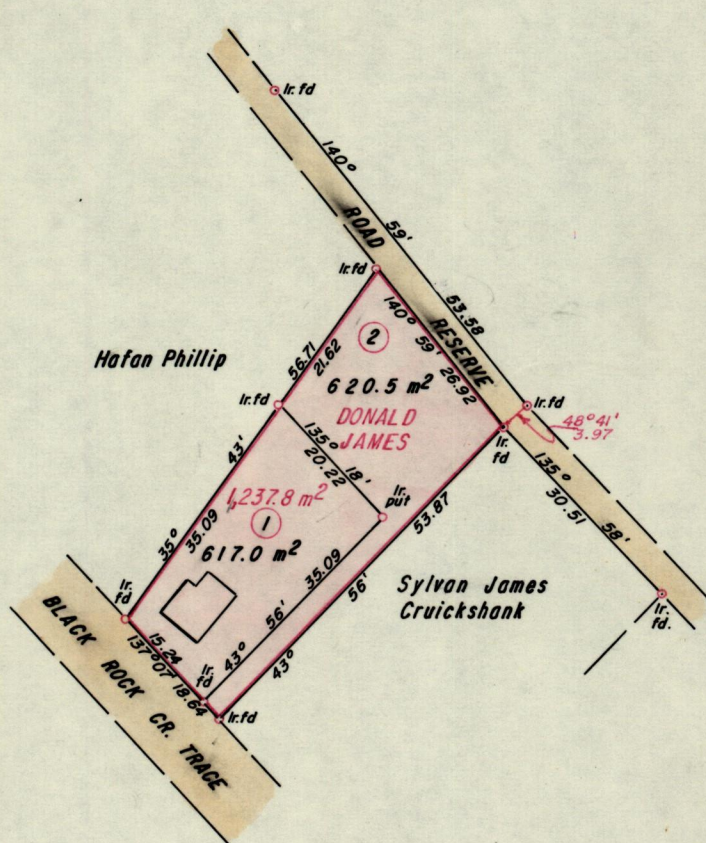

Approved

Land Cole
 Director of Surveys 9/03/88

Bearings are based on solar observations

SCALE 1:1000

Note: To obtain compass bearings add/subtract

minutes

Distances are in Metres

PLAN of 2 Parcel of land coloured pink in the Ward of Tobago

Containing together, one thousand, two hundred and thirty seven point five square metres

Surveyed by me, with due authority, in July 1990

I certify that I have complied with rule 76 under section 14(2)(d) of the Land Surveyors' Ordinance 1952, and that this plan is correct.

Checked by *G.R. Amchani 89.*
 18/3/91

Juma A.
 Land Surveyor, Trinidad & Tobago 21st January 1991

Entered

*13
9/10/88*