

802

REMAINING PORTION

R.P.O. Vol. 61.

Fol. 1.

1145

Cadastral Sheet D. 24. A. $\frac{44E}{3/d, 4/a}$

4(1)

C. of T. Vol.

Vol.

Ward of Pointe-a-Pierre.

S/O. No. 1338/99.

County of Victoria.

Original in Bk. 249. fol. 26.

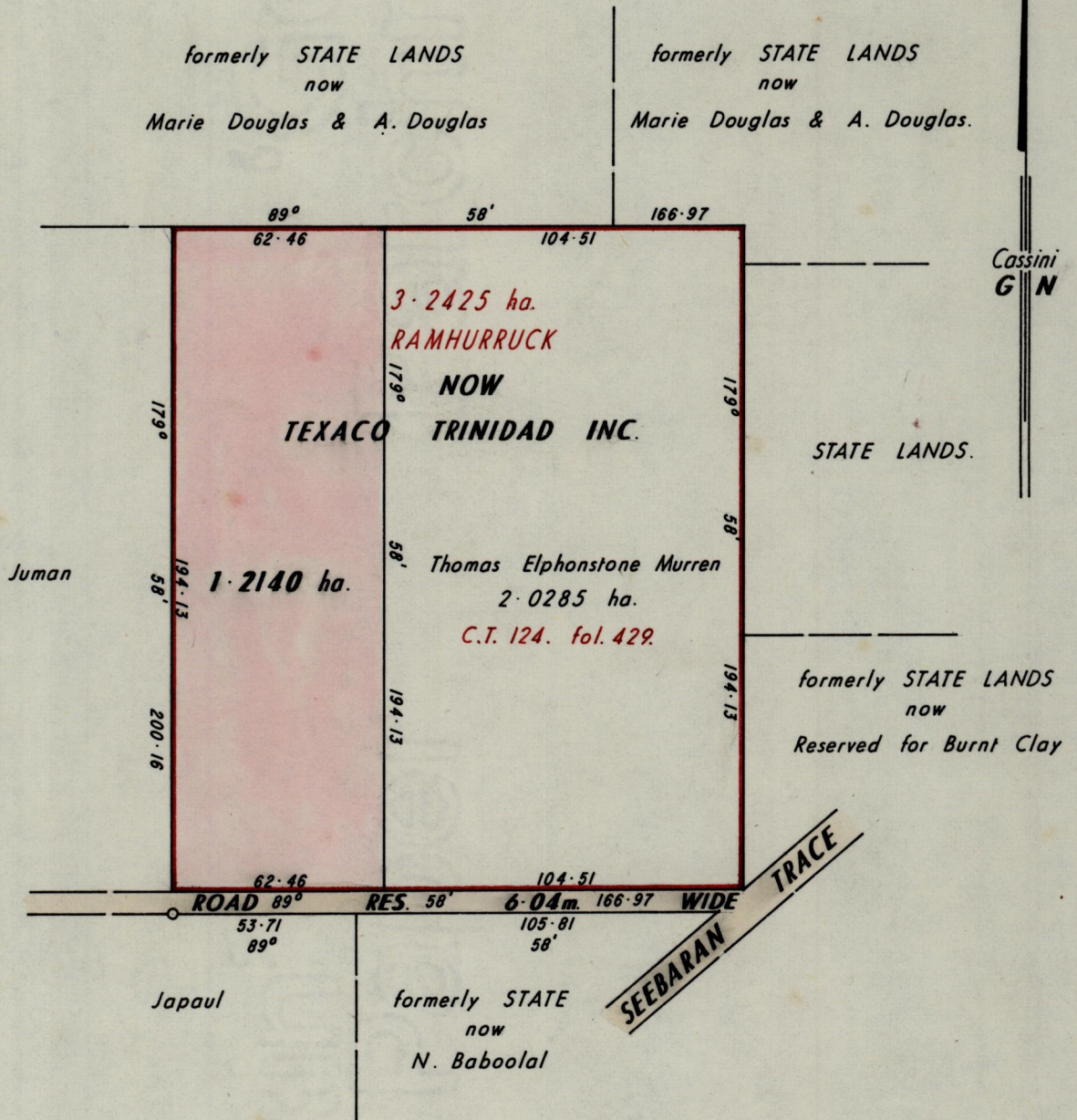

Approved

[Signature]
Director of Surveys
91.01.22

SCALE 1 : 2000.

Note: To obtain compass bearings

add 02 minutes

Distances are in metres.

This is a true copy of a diagram of three point two four two five hectares. originally granted to RAMHURRUCK. , shewing a portion coloured pink and containing one point two one four zero hectares. being the remainder after one. previous transfer of another portion of the land. the dividing lines having been run in conformity with Rule 76 under Sec. 7(d) of Cap. 27. No. 2 and duly certified by the Director of Surveys.

Checked by *[Signature]*
18/1/91

Entered on

[Signature]
Land Surveyor, Trinidad, 16th July 1990