

R.P.O. Vol. 188
C.T. Vol. 455

Fol. 555
Fol. 39

Ward of Naparima
County of Victoria.
Cadastral Sheet G. 13. G.
63.F.
1/d.

GN

CASSINI

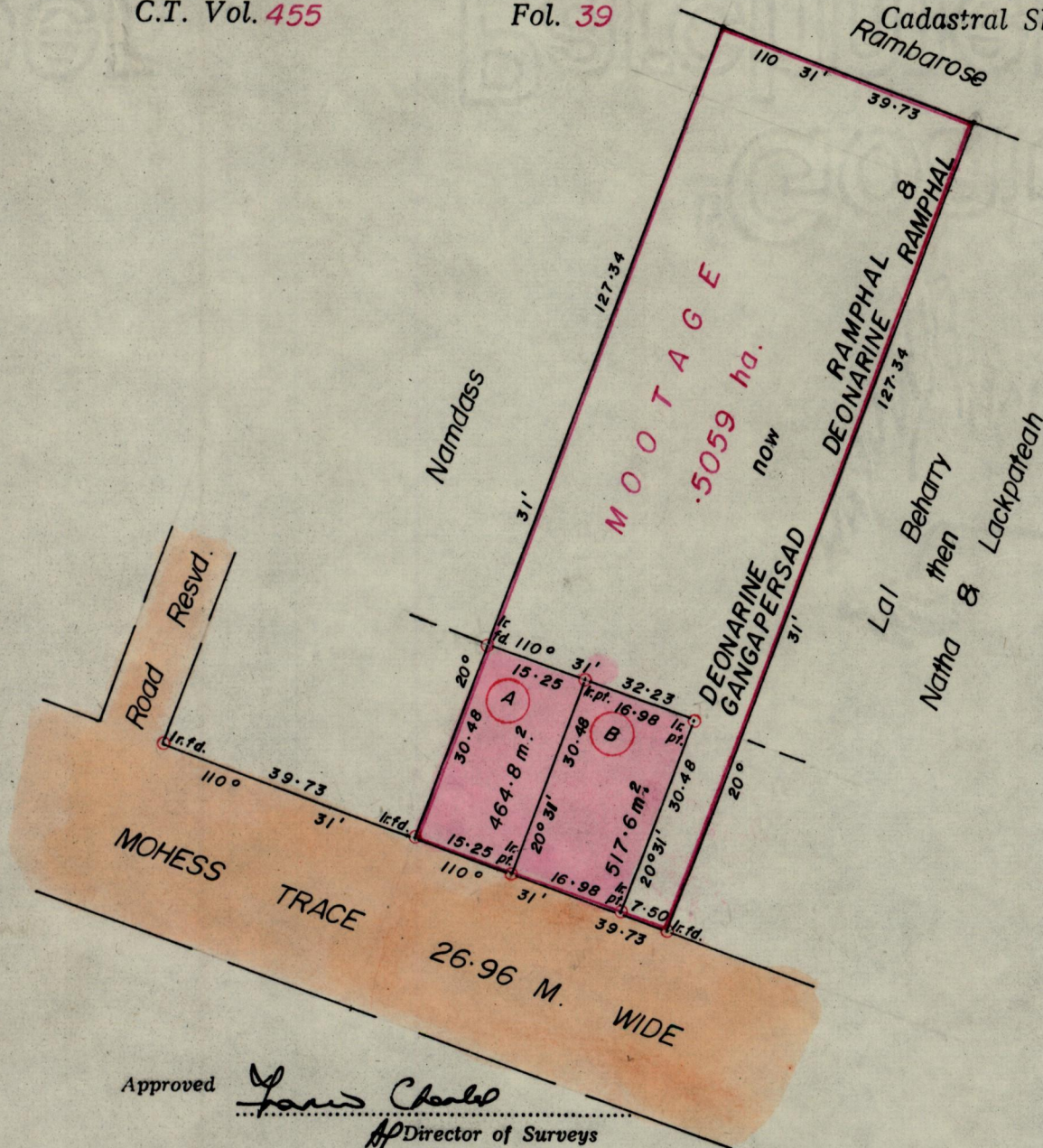

Approved

Janus Charles

Director of Surveys
90.07.17

SCALE 1:1000.

Note: To obtain compass bearings \pm / subtract | minutes Distances are in metres.

PLAN of 2 Parcelsof land coloured pink in the Ward of Naparima.

Containing nine hundred and eight two point four sq. metres .

Surveyed by me, with due authority, in September 1989.

I certify that I have complied with rule 76 under section 14(2)(d) of the Land Surveyors' Ordinance 1952, and that this plan is correct.

Checked by *G. Ramcharan*
16/7/90

S. Sathicharan
Land Surveyor, Trinidad & Tobago
2/10/1989

Entered

Land Surveyor, Trinidad & Tobago