

REMAINING PORTION

1145

388

R.P.O. Vol. 121 Fol. 407

Cadastral Sheet G.16 N. (72C)

C. of T. Vol. 1.80 Vol. 550

Ward of Erin

County of St. Patrick

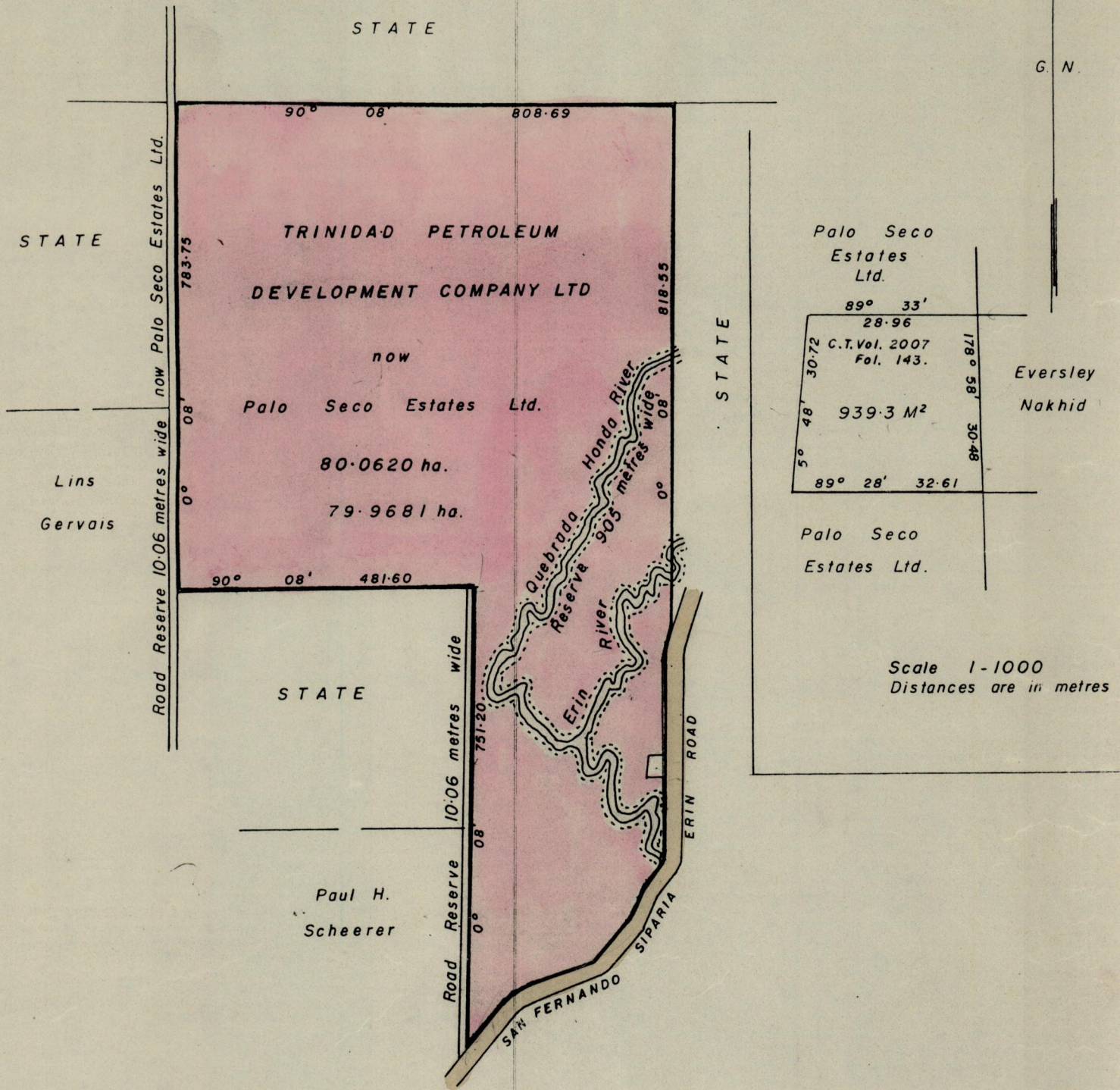

Approved

[Signature]
Director of Surveys

83.10.21

Note: To obtain compass bearings add 8 minutes subtract

SCALE 1 - 9504

Distances are in metres

This is a true copy of a diagram of Eighty point zero six two zero hectares originally transferred granted to TRINIDAD PETROLEUM DEVELOPMENT COMPANY LTD., shewing a portion coloured pink and containing Seventy-nine point nine six eight one hectares being the remainder after one previous transfer of another portion of the land. the dividing lines having been run in conformity with Rule 76 under Sec. 7(d) of Cap. 27. No. 2 and duly certified by the Director of Surveys.

Checked by *[Signature]*
83.10.20

Entered on

[Signature]

Land Surveyor, Trinidad, 1st November 1982