

No

17405

1145

369

R.P.O. Vol. 300  
C.T. Vol.

Fol. 369  
Fol.

Ward of Charuma  
County of Nariva  
Cadastral Sheet E.21. I. 55A 55B  
2/d 1/c

Sta.	Bear.	Dist.
B1 - C	115° 21'	52.26 fd.
	(114° 19')	51.20)
C - D	119° 59'	13.48
D - E	126° 11'	10.86
E - F	130° 50'	33.19
F - G	123° 20'	16.90
G - H	116° 24'	17.30
H - I	107° 30'	9.45
I - J	98° 14'	10.66
J - Jo	88° 17'	9.89
Jo - K	88° 17'	4.39
K - L	77° 43'	32.19
L - M	73° 51'	18.31
M - N	62° 57'	15.89
N - O	58° 13'	16.29

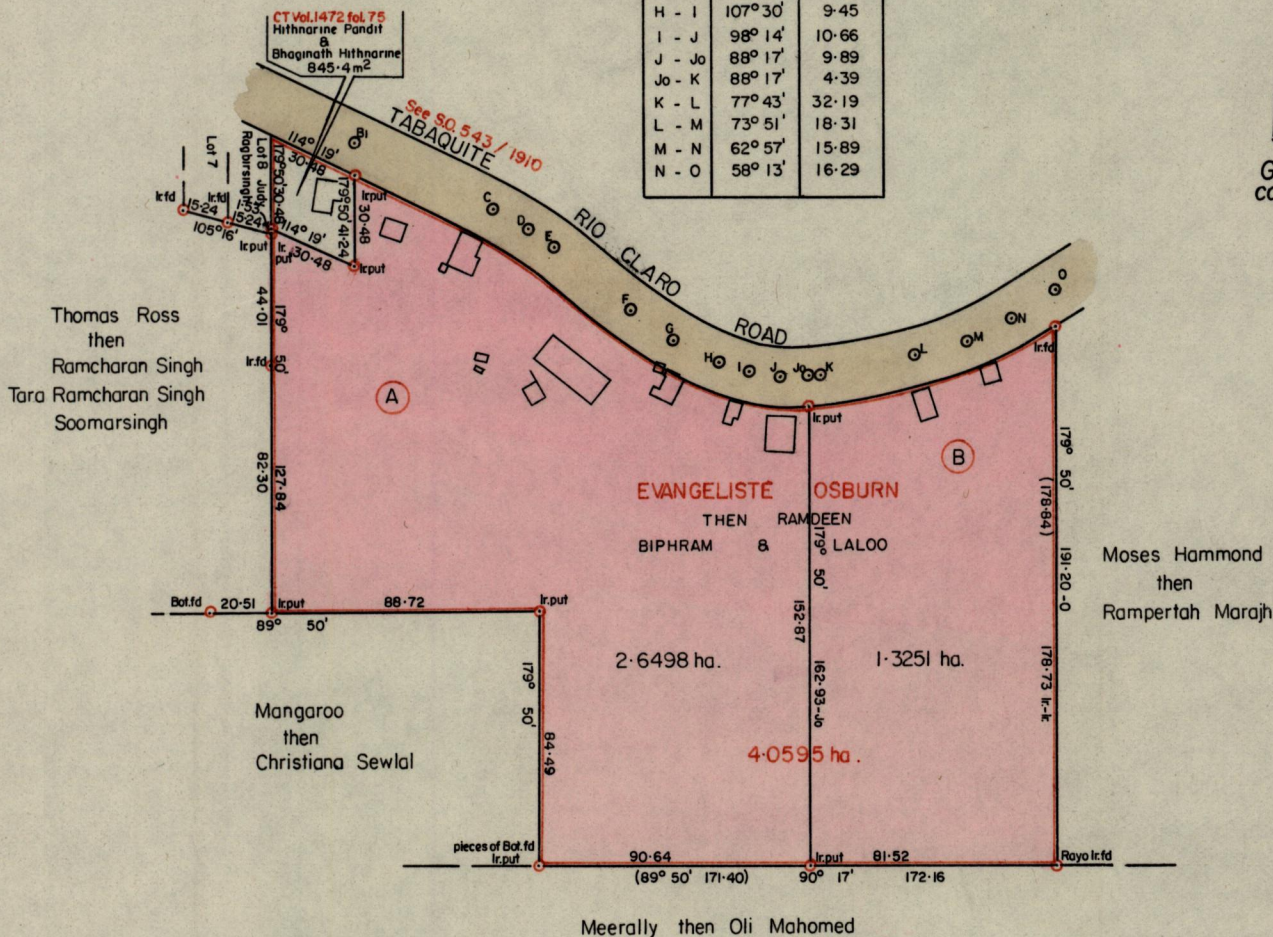

Approved

*James Charles*  
 Director of Surveys  
 90.06.26

SCALE 1/2500

Note: To obtain compass bearings add/subtract 10 minutes Distances are in metres

PLAN of 2 Parcels of land coloured pink in the Ward of Charuma

Containing

Surveyed by me, with due authority, in October 1989

I certify that I have complied with rule 76 under section 14(2)(d) of the Land Surveyors' Ordinance 1952, and that this plan is correct.

Checked by *G. Ramcharan* 21/6/90

*Arnold A.J. Ramon* ARICS.  
 Land Surveyor, Trinidad 19th October 89.

Entered .....