

REMAINING PORTION

R.P.O. Vol. 40 Fol. 646

C. of T. Vol. 1536 Vol. 215

Remaining Portion Plan Vol 1737 Fol 433

Cadastral Sheet C 21 P & E. I. D

Ward of Tamana

County of St Andrew

1145

35

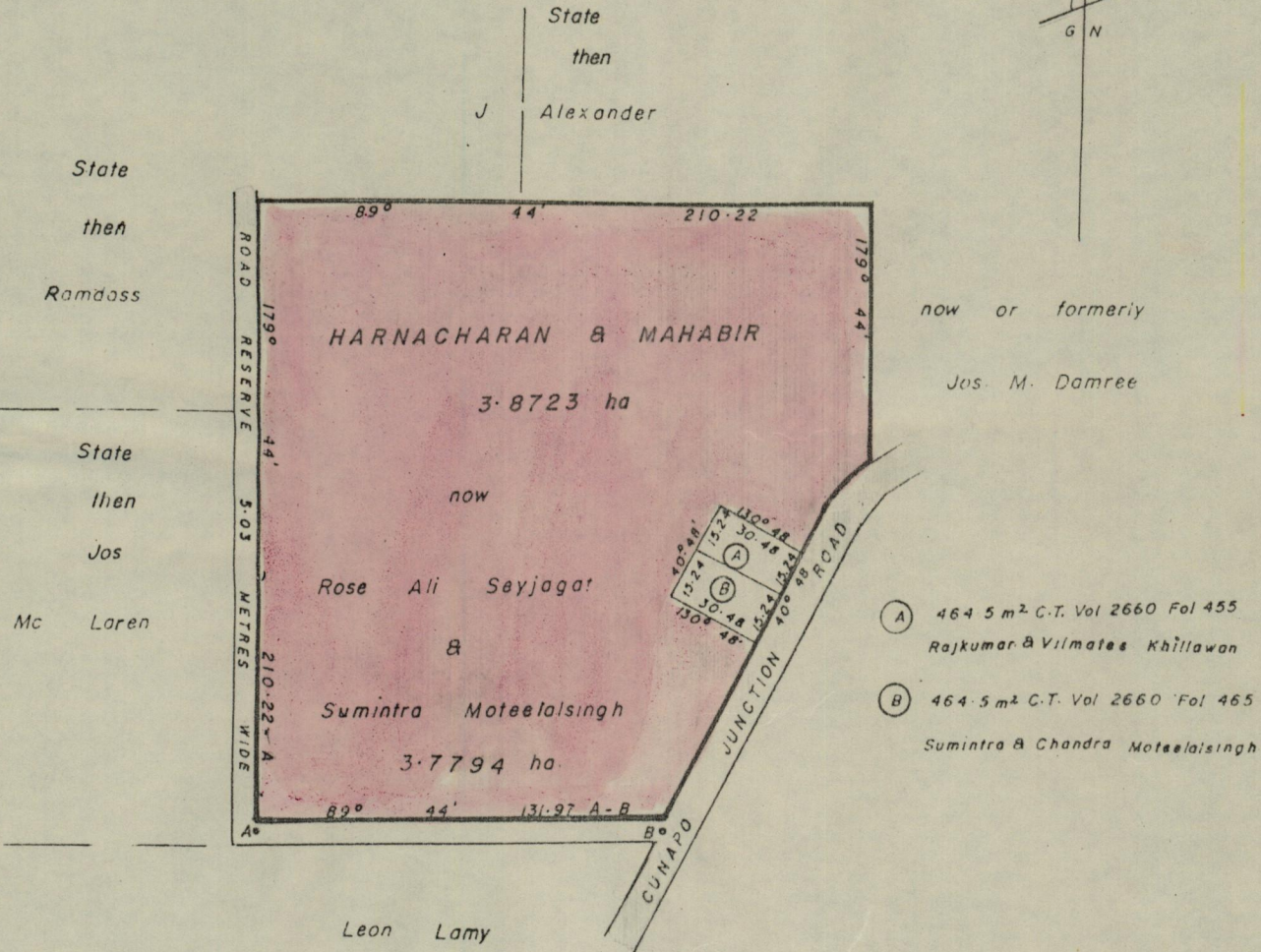

Approved

H. B. Joseph
Director of Surveys

85-8-26

Note: To obtain compass bearings ~~add~~ add 16 minutes

SCALE 1/2500

Distances are in metres

This is a true copy of a diagram of three point eight seven two three hectares originally transferred granted to HARNACHARAN & MAHABIR, shewing a portion coloured pink and containing three point seven seven nine four hectares being the remainder after two previous transfers of other portions of the land.

the dividing lines having been run in conformity with Rule 76 under Sec. 14(2)(d) of the Land Surveyors' Ordinance, 1952 (No. 2) of Cap. 27:2 and duly certified

by the Director of Surveys

Checked by *[Signature]* 85-8-23

Entered on

Laura Pierre

Land Surveyor, Trinidad, 2nd August 1985