

REMAINING PORTION

R.P.O. Vol. 615 Fol. 601
C. of T. Vol. Vol.

1145 Cadastral Sheet $\frac{73B}{1/a}$ G. 17. C 346
Ward of Siparia
County of St. Patrick

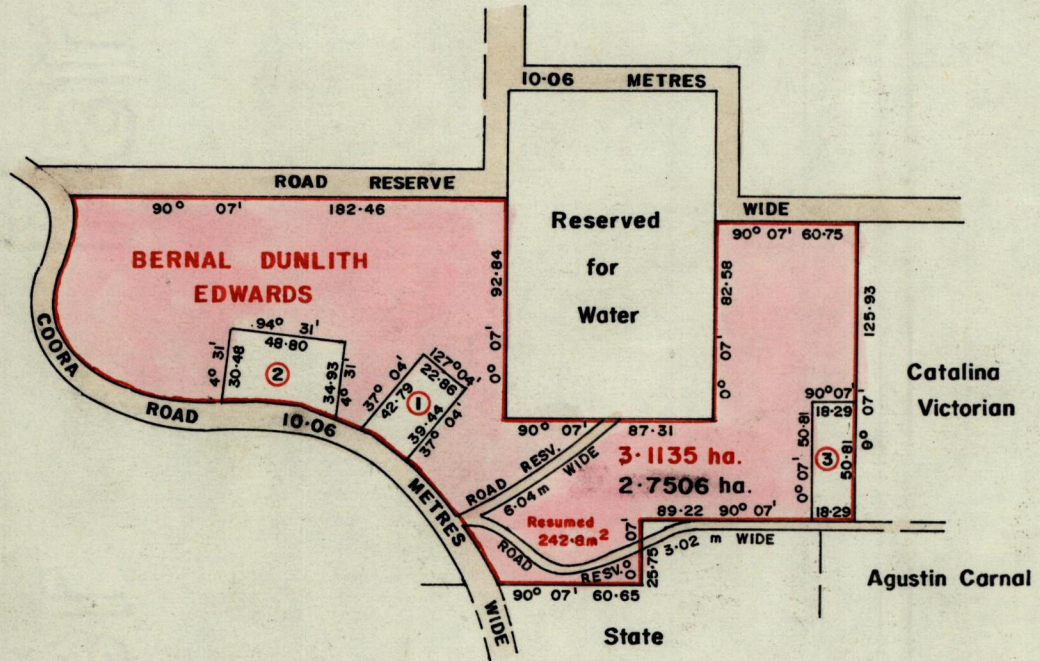

	NAME	AREA	REFERENCE
1	Clunis Pierre	929.0m ²	C.T. Vol. 1230 fol. 529
2	Harry Persad Maharaj	1528.2m ²	C.T. Vol. 1220 fol. 7
3	Edris Wilson	929.2m ²	C.T. Vol. 1792 fol. 469

Approved

[Signature]
Director of Surveys
90.5.4

SCALE 1 : 3168

Note: To obtain compass bearings ~~add~~ 7 minutes subtract

Distances are in metres.

This is a true copy of a diagram of three point one one three five hectares originally granted to BERNAL DUNLITH EDWARDS, shewing a portion coloured pink and containing two point seven five zero six hectares being the remainder after one resumption and three previous transfers of another portion of the land. 14(2)(d) of the Land Surveyors' Ordinance 1952 the dividing lines having been run in conformity with Rule 76 under Sec. 7(d) of Cap. 27, No. 2 and duly certified by the Director of Surveys.

Checked by *[Signature]* 24/5/90

Entered on

[Signature]
Land Surveyor, Trinidad, 1st May 1990.