

No 25834

1145

329

R.P.O. Vol. 120  
C.T. Vol. 3156

Fol. 559  
Fol. 335

Ward of Siparia  
County of St. Patrick  
Cadastral Sheet G-13-N  $\frac{63E}{4/d}$

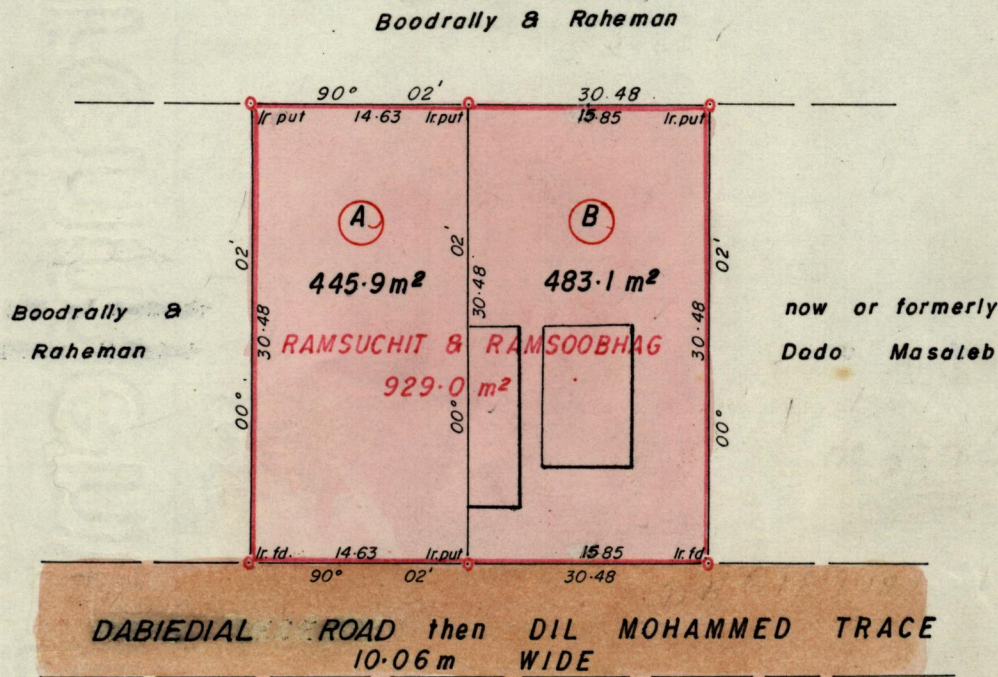

Approved

*[Signature]*  
 Director of Surveys  
 90-04-30

SCALE 1:500

Note: To obtain compass bearings add/subtract

minutes

Distances are in metres

PLAN of  $\frac{2}{4}$  Parcel of land coloured pink in the Ward of Siparia  
 Containing together nine hundred and twenty nine point zero square metres  
 Surveyed by me, with due authority, in July 1988

I certify that I have complied with rule 76 under section 14(2)(d) of the  
 Land Surveyors' Ordinance 1952, and that this plan is correct.

Checked by *GR 26/4/90*

*Winton Ramcharan*

Entered .....

Land Surveyor, Trinidad and Tobago *20<sup>th</sup> July* 1988