

REMAINING PORTION

R.P.O. Vol. 156

Fol. 357

1145

Cadastral Sheet G. 18. C.

3000
73.C.
1/b

C. of T. Vol. 1710

Vol. 109

Ward of Siparia.

County of St. Patrick.

G N
Cassini

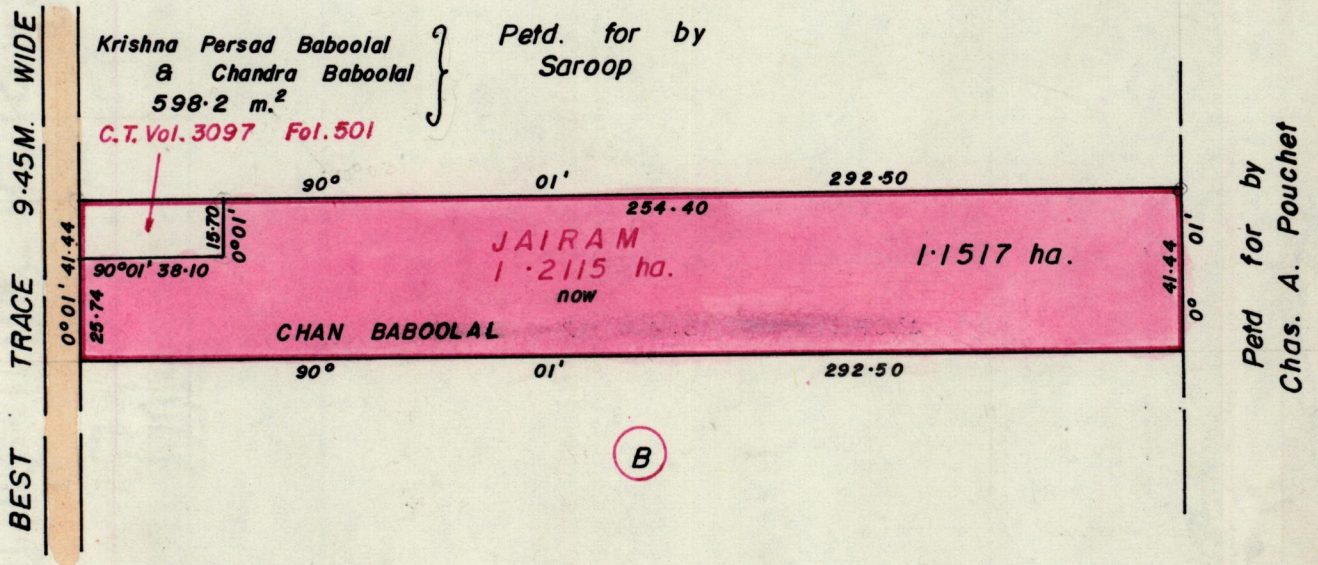

Approved

J. Charles
Director of Surveys
20.03.20

SCALE 1 : 2000.

Note: To obtain compass bearings ~~with~~ 1 minutes subtract

Distances are in metres.

This is a true copy of a diagram of one point two one one five hectares originally granted to **Jairam**, shewing a portion coloured pink and containing one point one five one seven hectares being the remainder after one (1) previous transfer of another portion of the land. 14(2)(d) of the Land Surveyors' Ordinance 1952 the dividing lines having been run in conformity with Rule 76 under Sec. 7(d) of Cap. 27. No. 2 and duly certified by the Director of Surveys.

Checked by *GR 2013/90*

Entered on

G. L. Charan

Land Surveyor, Trinidad, 12/1/1920