

R.P.O. Vol. 106

Fol. 201

C. of T. Vol. 648

Vol. 289

STATE then GUSTAVE PRINZ 1145

Cadastral Sheet G.16.M. 72C/3/d, 72F/1/b

Ward of Erin

County of St. Patrick

2832

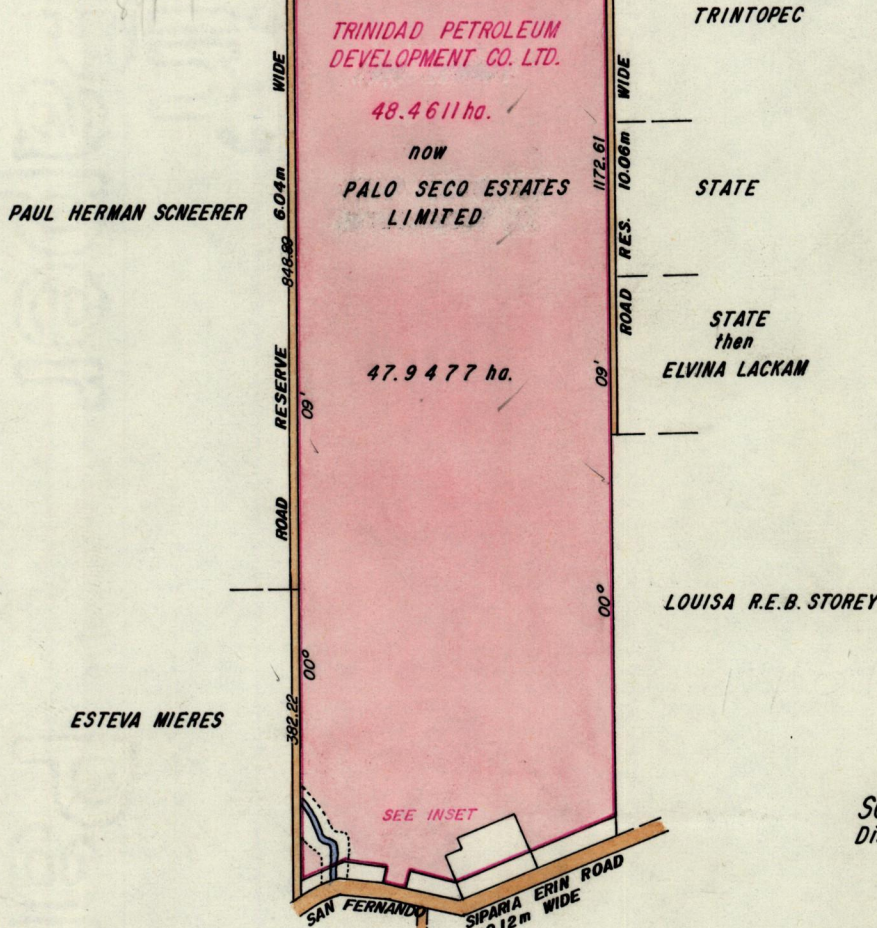

SCALE 1:9504 (12Chains) Distances are in Metres

INSET

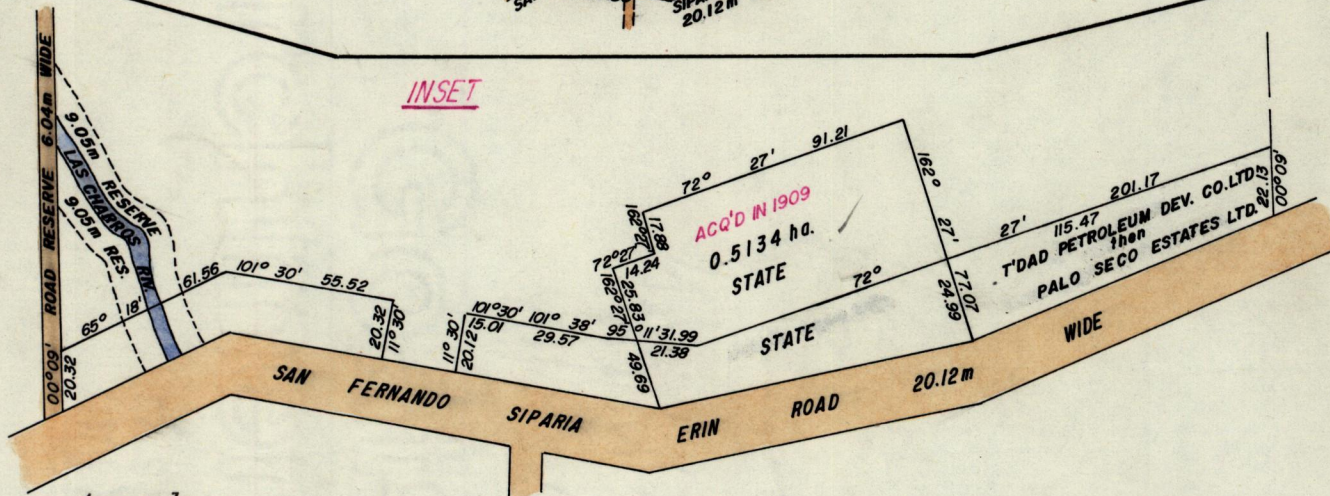

Approved

*Paul Chubb*

Director of Surveys 90.02.20

Note: To obtain compass bearings subtract 9 minutes

SCALE 1:2500

Distances are in Metres

This is a true copy of a diagram of forty eight point four six one one hectares originally transferred to Trinidad Petroleum Development Co. Ltd. , shewing a portion coloured pink and containing forty seven point nine four seven seven hectares being the remainder after one previous transfer of another portion of the land. the dividing lines having been run in conformity with Rule 76 under Sec. 14(2) (d) of the Land Surveyors Ordinance 1952 and duly certified by the Director of Surveys.

Checked by *SK 20/2/90*

Entered on

*J. J. ...*  
Land Surveyor, Trinidad, 27<sup>th</sup> October 1989