

No 25024

R.P.O. Vol. 52
C.T. Vol. 2869

Fol. 667
Fol. 113

Ward of *Pointe a Pierre*
County of *Victoria*
Cadastral Sheet *D.24.J (54B)*
2/c

State

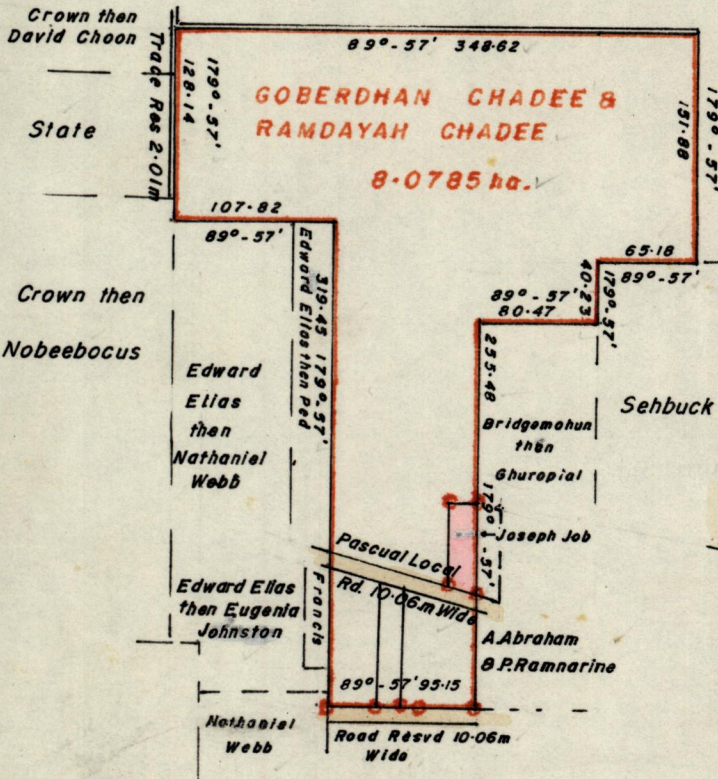

Crown then
Rodgemohun

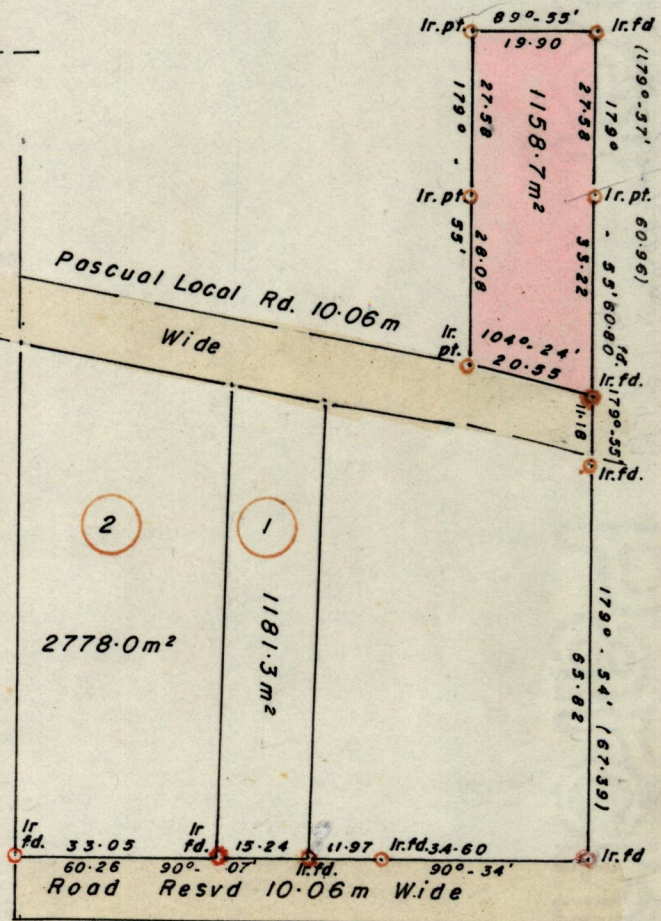

G. N.
CASSINI

Scale 1/5000

Approved *[Signature]*
Director of Surveys
02.02

Bearings are based on Solar Obs.

SCALE 1/1250

Note: To obtain compass bearings add/subtract 3

minutes

Distances are in Metres

PLAN of a Parcel of land coloured *Pink* in the Ward of *Pointe a Pierre*
Containing *One thousand one hundred and fifty eight point seven* sq.metres.
Surveyed by me, with due authority, on *23rd Nov. 1988*

I certify that I have complied with rule 76 under section 14(2)(d) of the
Land Surveyors' Ordinance 1952, and that this plan is correct.

Checked by *[Signature]* 2/1/90

[Signature]
Land Surveyor, Trinidad
and Tobago 9 June 1989