

No 24708

1145

245

R.P.O. Vol. 105.
C.T. Vol. 718.

Fol. 45.
Fol. 49.

Ward of Siparia.
County of St. Patrick.
Cadastral Sheet 63E G. 12. H.

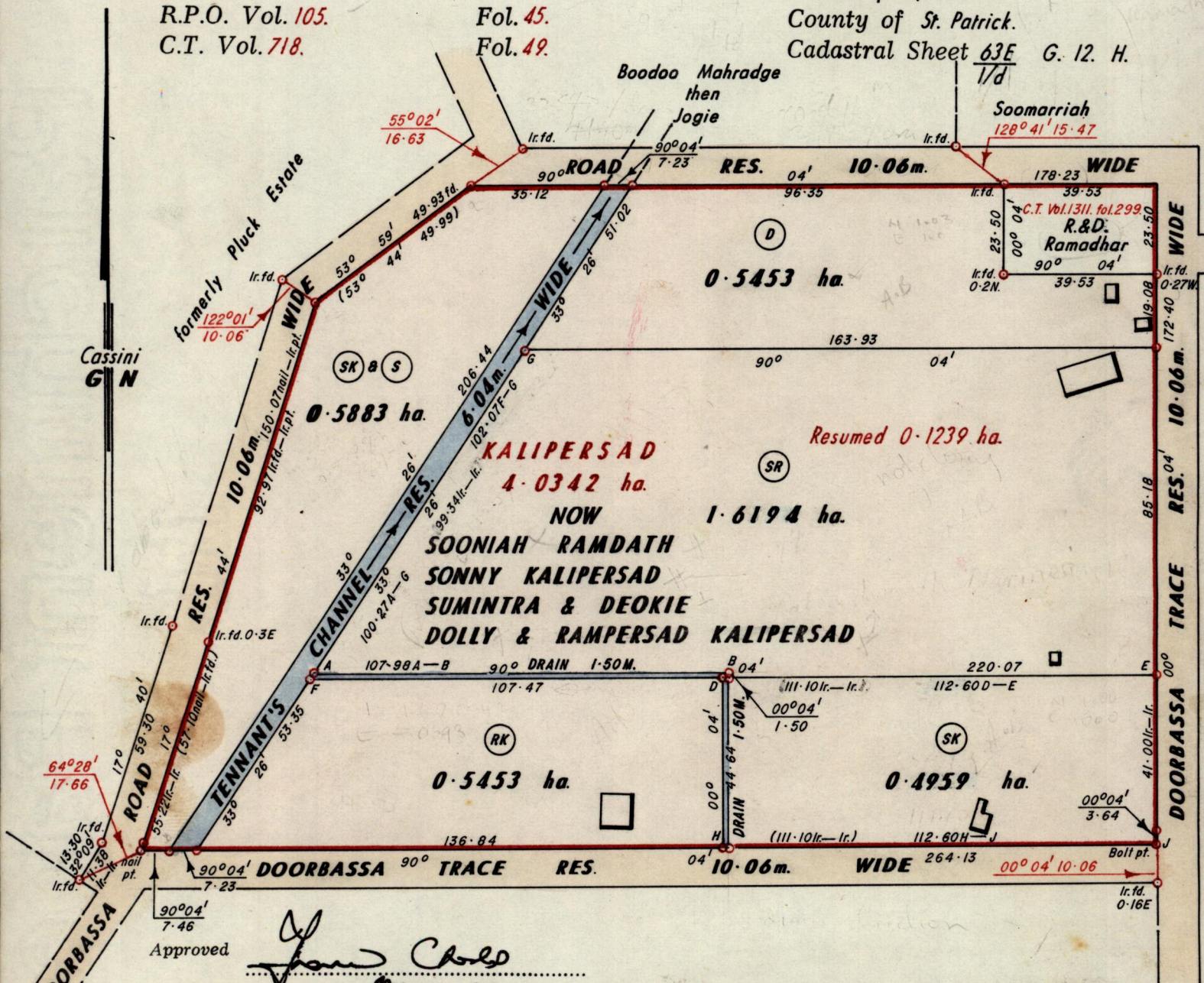

Approved

John Cole
Director of Surveys
12.20

o Denotes Iron put except otherwise stated.

Cassini Grid bearings based on Solar Observation. SCALE 1:1500.

Note: To obtain compass bearings \square /subtract 04 minutes

Distances are in metres.

PLAN of 5 Parcels of land coloured pink in the Ward of Siparia.

Containing together three point seven nine four two hectares.

Surveyed by me, with due authority, in September 1988 & February 1989.

I certify that I have complied with rule 76 under section 14(2)(d) of the Land Surveyors' Ordinance 1952, and that this plan is correct.

Checked by *A. K. ... 12/1/89*

Verne ...

Entered

Land Surveyor, Trinidad 2nd Nov. 1989