

REMAINING PORTION

R.P.O. Vol. 40 Fol. 13
 C. of T. Vol. 396 Vol. 207
 Previous Remaining Portion Plan
 L. & S Bk 798 Fol. 1

Cadastral Sheet A. 20.6
 Ward of St Anns
 County of St George

1145

242

H. W. Bertete

G.R. Gilkes

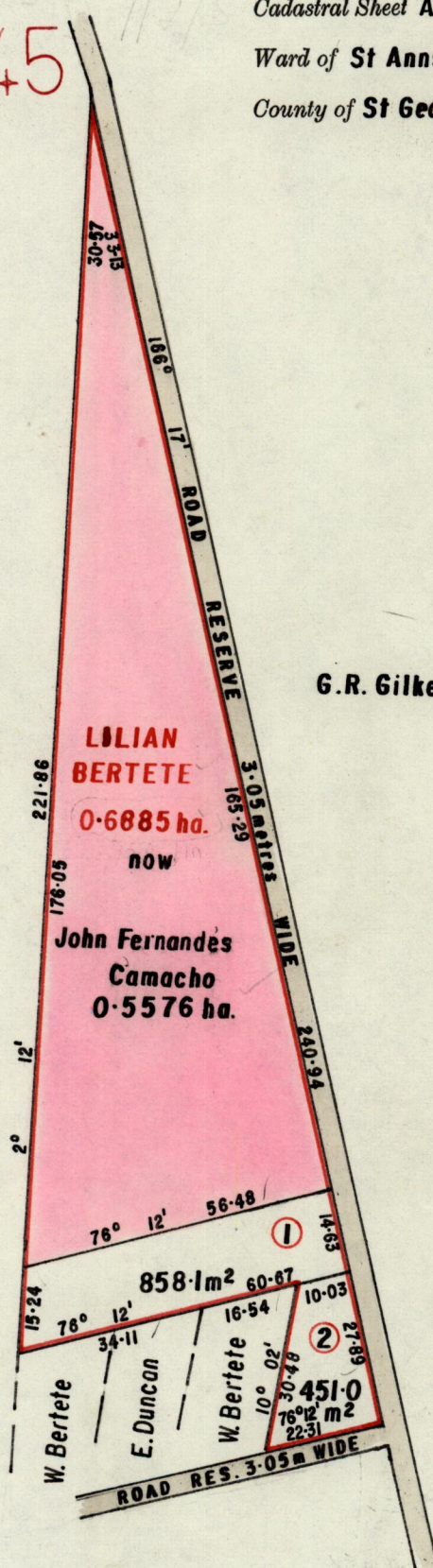

Lot 1 Harry Peters & Harold Vernon
 C.T.Vol. 1834 Fol. 9
 Lot 2 Boodoo Badal & Veronica Badal
 C.T.Vol. 1834 FOL. 15

Approved

[Signature]
 Director of Surveys
 8p. 11.24

Note: To obtain compass bearings ~~add~~ ^{add} 2 minutes _{subtract}

SCALE 1:1250

Distances are in metres

This is a true copy of a diagram of **zero point six eight eight five hectares** originally granted to **LILIAN BERTETE**, shewing a portion coloured pink and containing **zero point five five seven six hectares** being the remainder after **two** previous transfers of other portions of the land. 14(2)(d) of the Land Surveyors' Ordinance 1952 the dividing lines having been run in conformity with Rule 76 under Sec. ~~7(d) of Chap. 27, No. 2~~ and duly certified by the Director of Surveys.

Checked by *[Signature]* 23/11/89.

Entered on

[Signature]
 Land Surveyor, Trinidad, 14th Nov. 1989