

1145

210

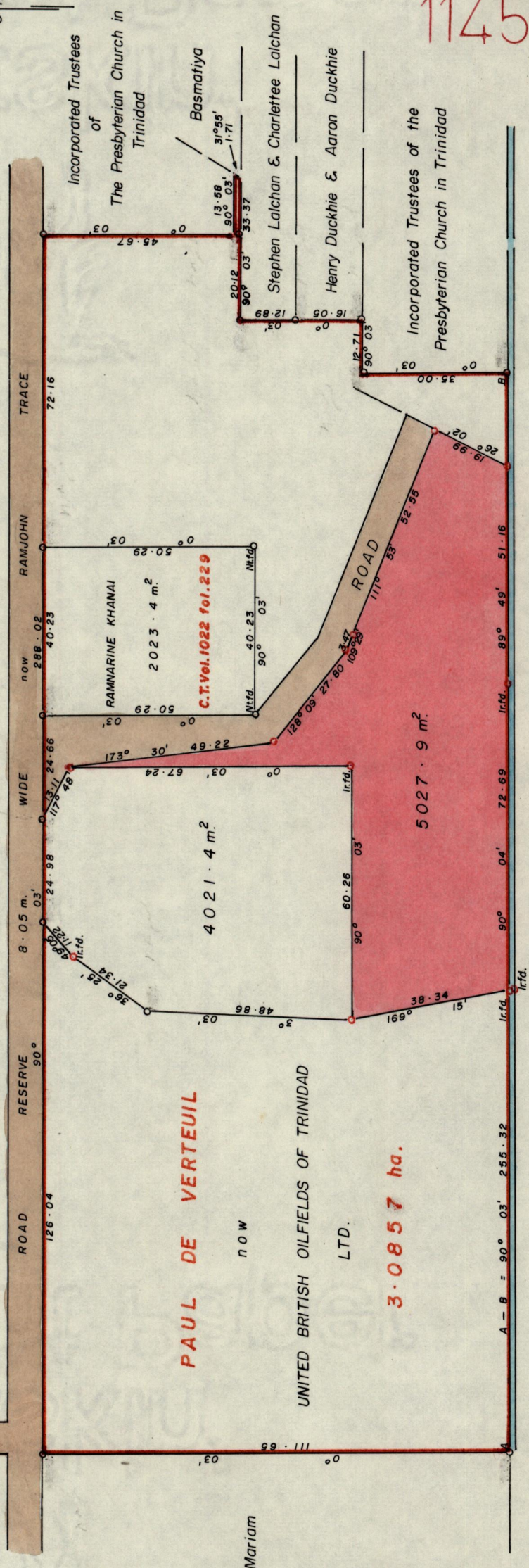

Jemeah

Approved *James Charles*  
Director of Surveys G.P.O.

○ Denotes No Mark Found  
● Denotes Iron put except otherwise stated

**SCALE 1:1250**

Distances are in metres

Note: To obtain compass bearing subtract 3 minutes

PLAN of a Parcel of land coloured pink in the Ward of Siparia.  
Containing five thousand and twenty - seven point nine square metres.

Surveyed by me, with due authority, in January 1988.

I Certify that I have complied with rule 76 under section 14(2)(d) of the  
Land Surveyors' Ordinance 1952, and that this plan is correct.

Checked by *GR 12/10/88*

*Winton Ramnarain*

Entered by ..... Land Surveyor, Trinidad 7<sup>th</sup> March 1988