

No 8509

1145

206
2006

R.P.O. Vol. 49
C.T. Vol. 803

Fol. 251
Fol. 243

Ward of Siparia
County of St Patrick
Cadastral Sheet G.12.F

63 D.
2/d.

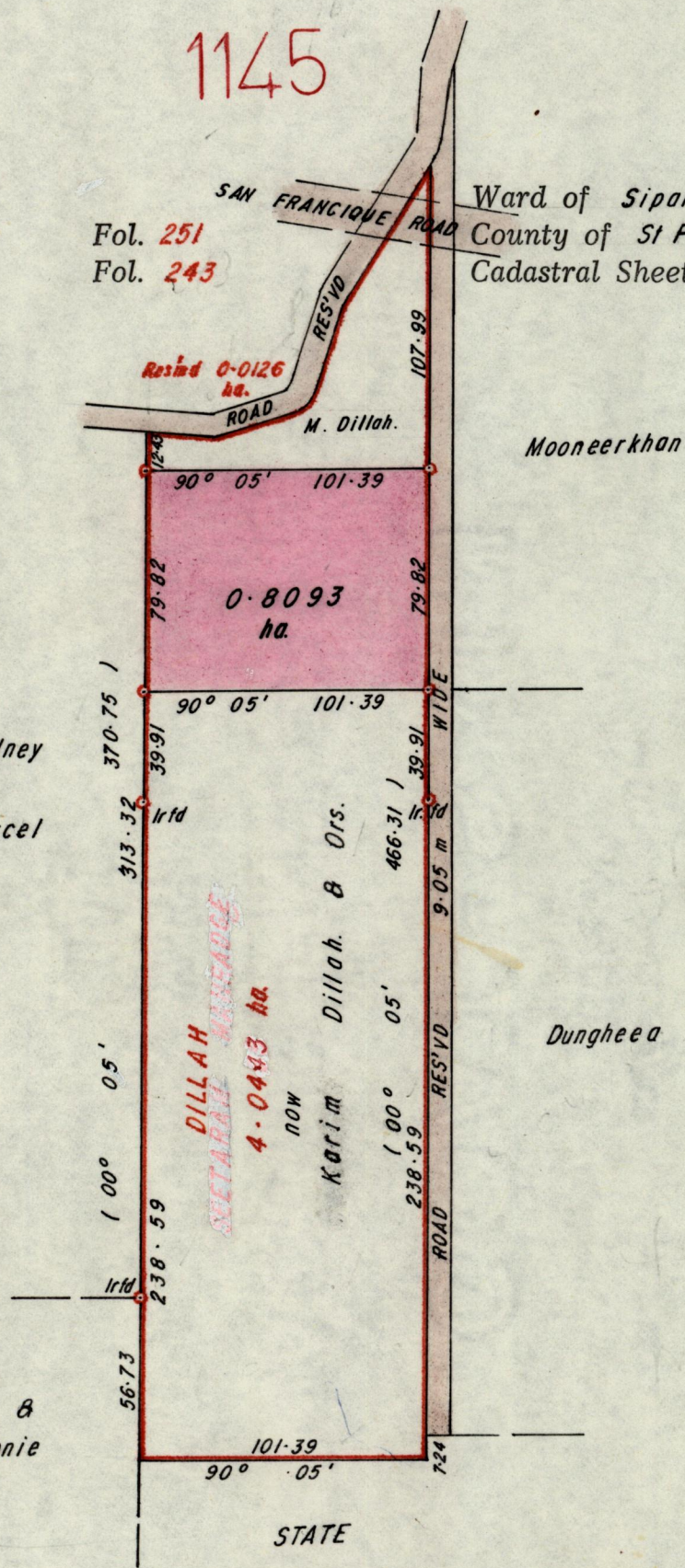

Approved

James Charles

Director of Surveys
8p. 10.0

○ Denotes Iron put, except where otherwise stated.

SCALE 1:2500

Note: To obtain compass bearings add/subtract 5 minutes Distances are in metres

PLAN of a Parcel of land coloured pink in the Ward of Siparia
Containing zero point eight zero nine three hectares
Surveyed by me, with due authority, in August 1986

I certify that I have complied with rule 76 under section 14(2)(d) of the
Land Surveyors' Ordinance 1952, and that this plan is correct.

Checked by *GC 11/10/89.*

Lawrence Clarke
Land Surveyor, Trinidad 29th July 1989

Entered