

2736

REMAINING PORTION

L. & S.—56

R.P.O. Vol. 91 Fol. 603  
C. of T. Vol. 2327 Fol. 257

1145

Cadastral Sheet E. 6. B.  
Ward of Tamona  
County of St. Andrew

22

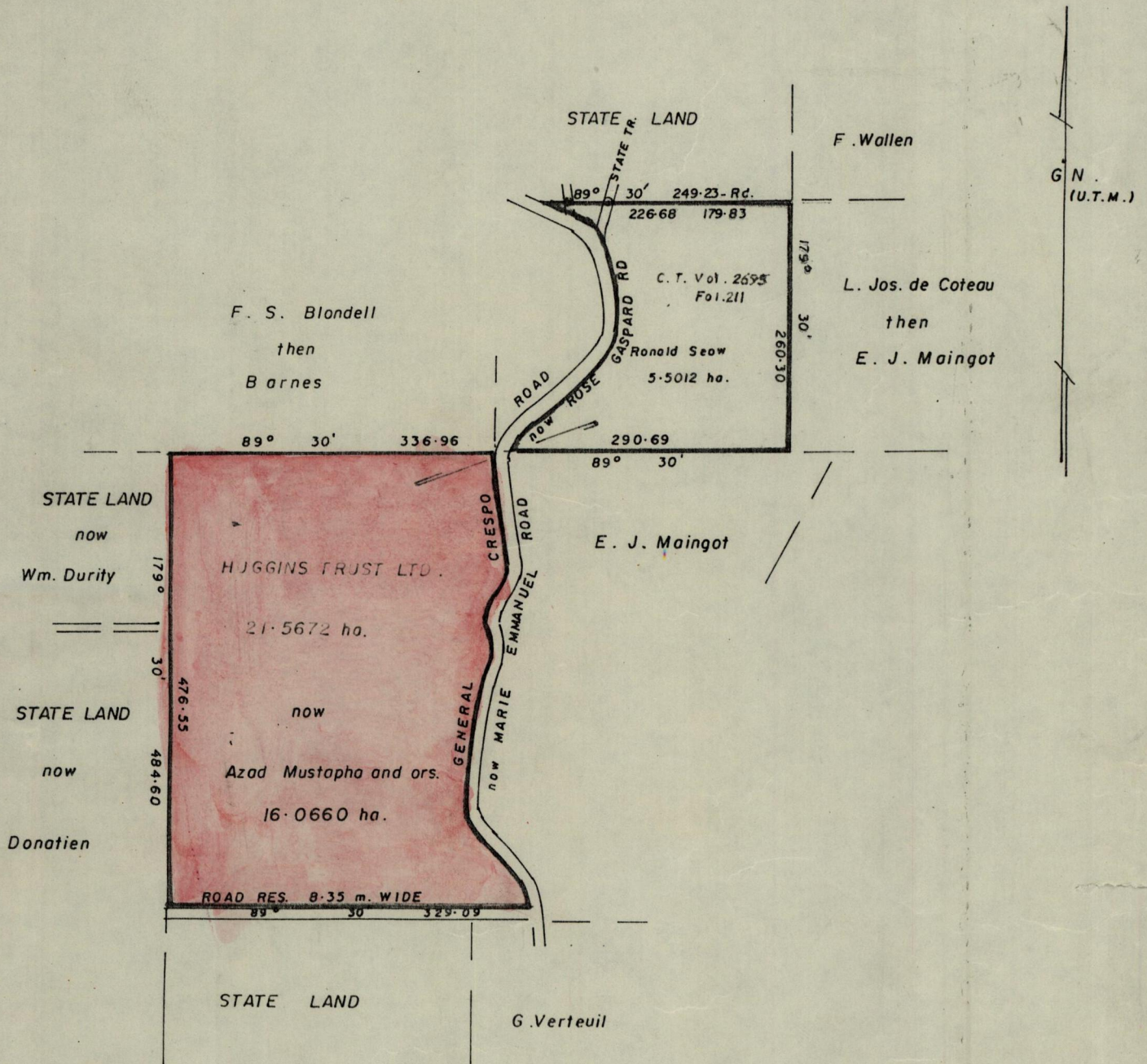

Approved

*R.B. Jones*

Director of Surveys

85.1.07

Cassini

Note: To obtain ~~compass~~ bearings add 18 minutes

SCALE 8 chns : 1 in.

Distances are in metres

This is a true copy of a diagram of twenty one hectares fifty six ares and seventy two square metres originally granted to Huggins Trust Ltd, shewing a portion coloured pink and containing sixteen hectares six ares and sixty square metres being the remainder after (1) one previous transfer of another portion of the land. the dividing lines having been run in conformity with Rule 76 under Sec. 7 (d) of Cap. 27. No. 2 and duly certified by the Director of Surveys.

Checked by *P. Beard* 85/01/07

Entered on

*Walter D. ...*

Land Surveyor, Trinidad,

10 Feb 1907