

R.P.O. Vol. 16 Fol. 491
C. of T. Vol. 1391 Fol. 223

Cadastral Sheet G. 15. B.
Ward of Savana Grande.
County of Victoria.

1145

19

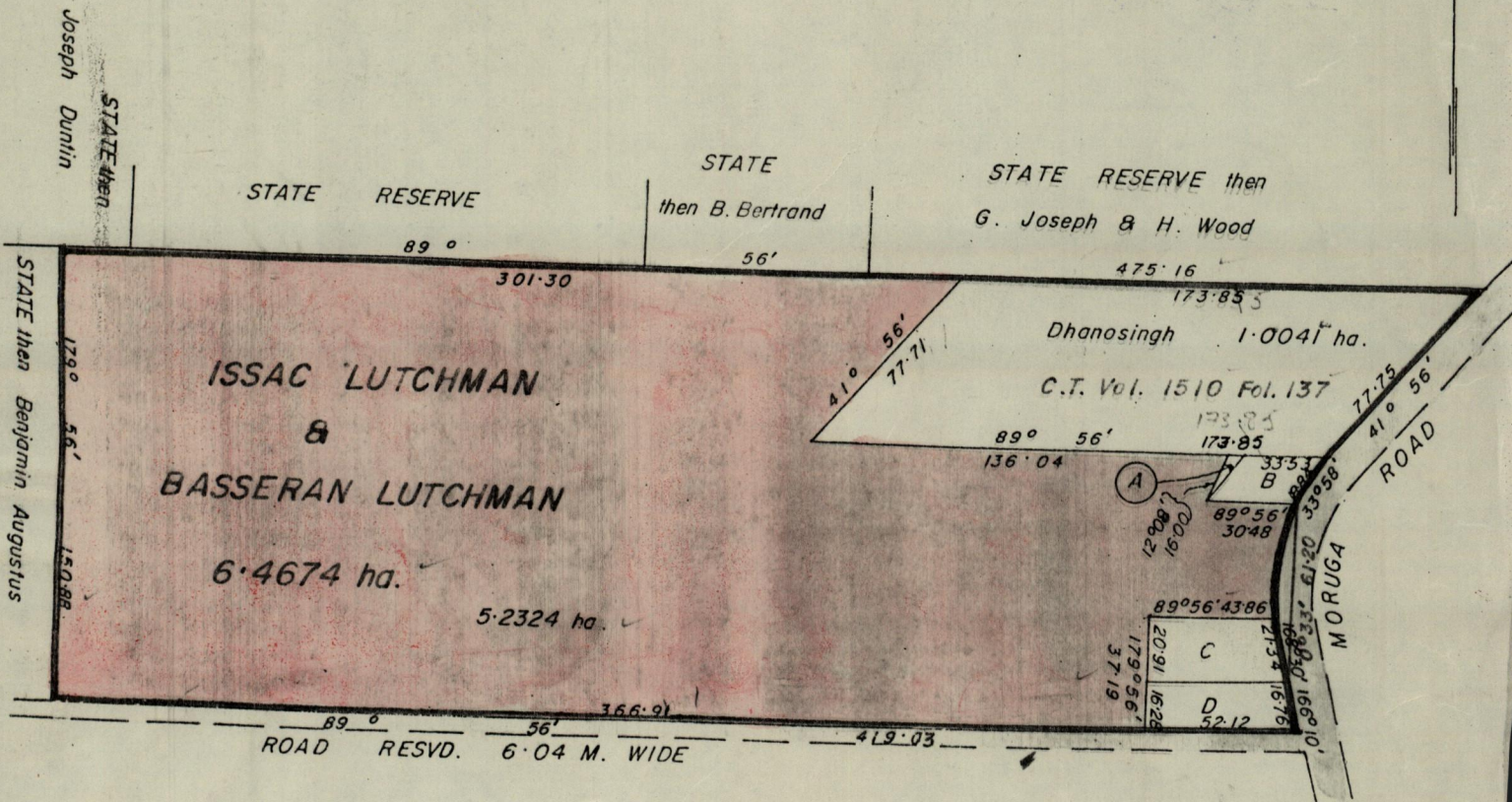

A	.0032 ha.	C.T. Vol. 1914 Fol. 399
B	.0499 ha.	C.T. Vol. 1637 Fol. 379
C	.0962 ha.	C.T. Vol. 2872 Fol. 39
D	.0816 ha.	C.T. Vol. 2094 Fol. 397

Approved

K.B. Joseph

Director of Surveys

25.5.10

Note: To obtain compass bearings ^{add 4} _{subtract} minutes

SCALE 1:2500.

Distances are in metres

This is a true copy of a diagram of six point four six seven four hectares originally
 originally transferred to Issac Lutchman & Basseran Lutchman, shewing a portion
 coloured pink and containing five point two three two four hectares being the remainder
 after five (5) previous transfer of another portion of the land.
 the dividing lines having been run in conformity with Rule 76 under Sec. 7 (d) of Cap. 27. No. 2 and duly certified
 by the Director of Surveys.

Checked by *A.S. 10*

Entered on

[Signature]