

No 22280

R.P.O. Vol. 4
C.T. Vol. 1070

Fol. 617
Fol. 237

Ward of Turure
County of St. Andrew
Cadastral Sheet E.I.F.

25 E
3/c, 3/d

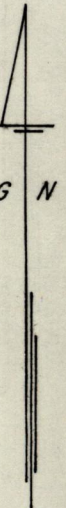

INSET

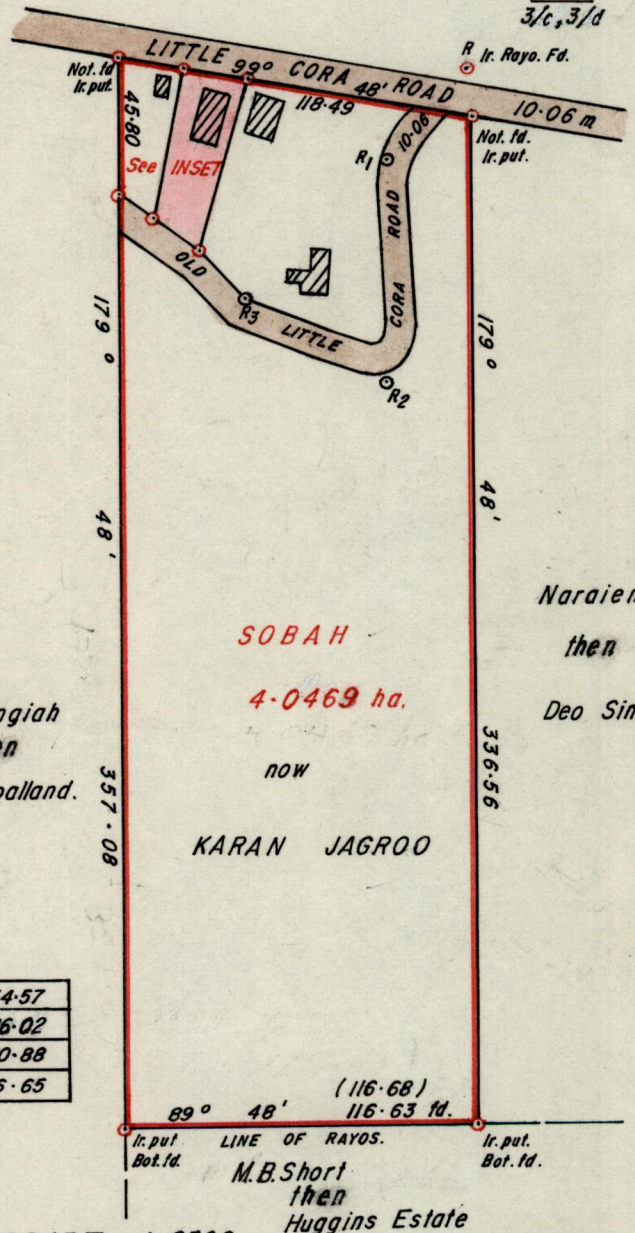
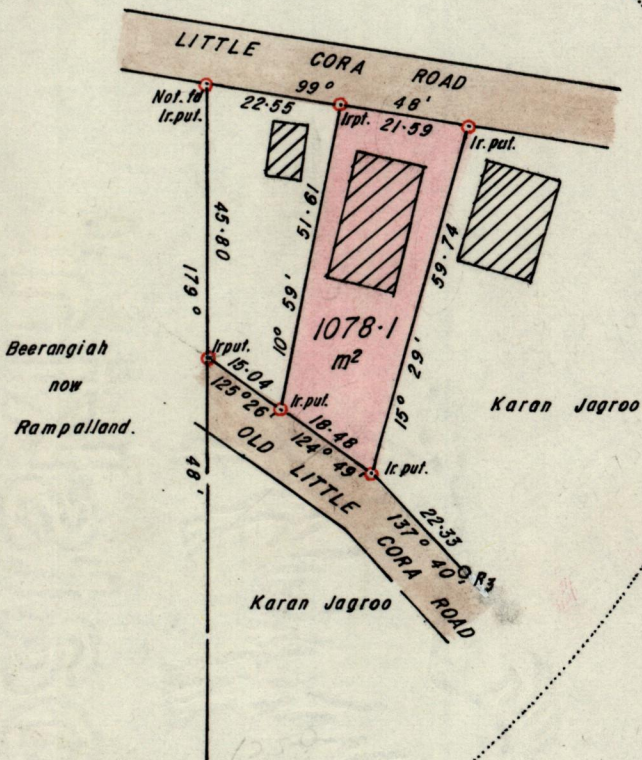

SCALE 1:1250
DISTANCES ARE IN METRES.

Reference			
R3 - R2	121° 17'	54.57	
R2 - R1	358° 04'	76.02	
R1 - R	42° 16'	40.88	
R - Ir	171° 13'	16.65	

Approved

Alphonse Thibault
Director of Surveys
89.08.15

SCALE 1:2500

Distances are in metres.

Note: To obtain compass bearings add/subtract minutes

PLAN of a Parcel of land coloured pink in the Ward of Turure
Containing one thousand and seventy eight point one square metres.

Surveyed by me, with due authority, in November 1988

I certify that I have complied with rule 76 under section 14(2)(d) of the
Land Surveyors' Ordinance 1952, and that this plan is correct.

Checked by *GR 14/8/89*

Horace A. Achille
Land Surveyor, Trinidad 18th November 88

Entered