

1145

16

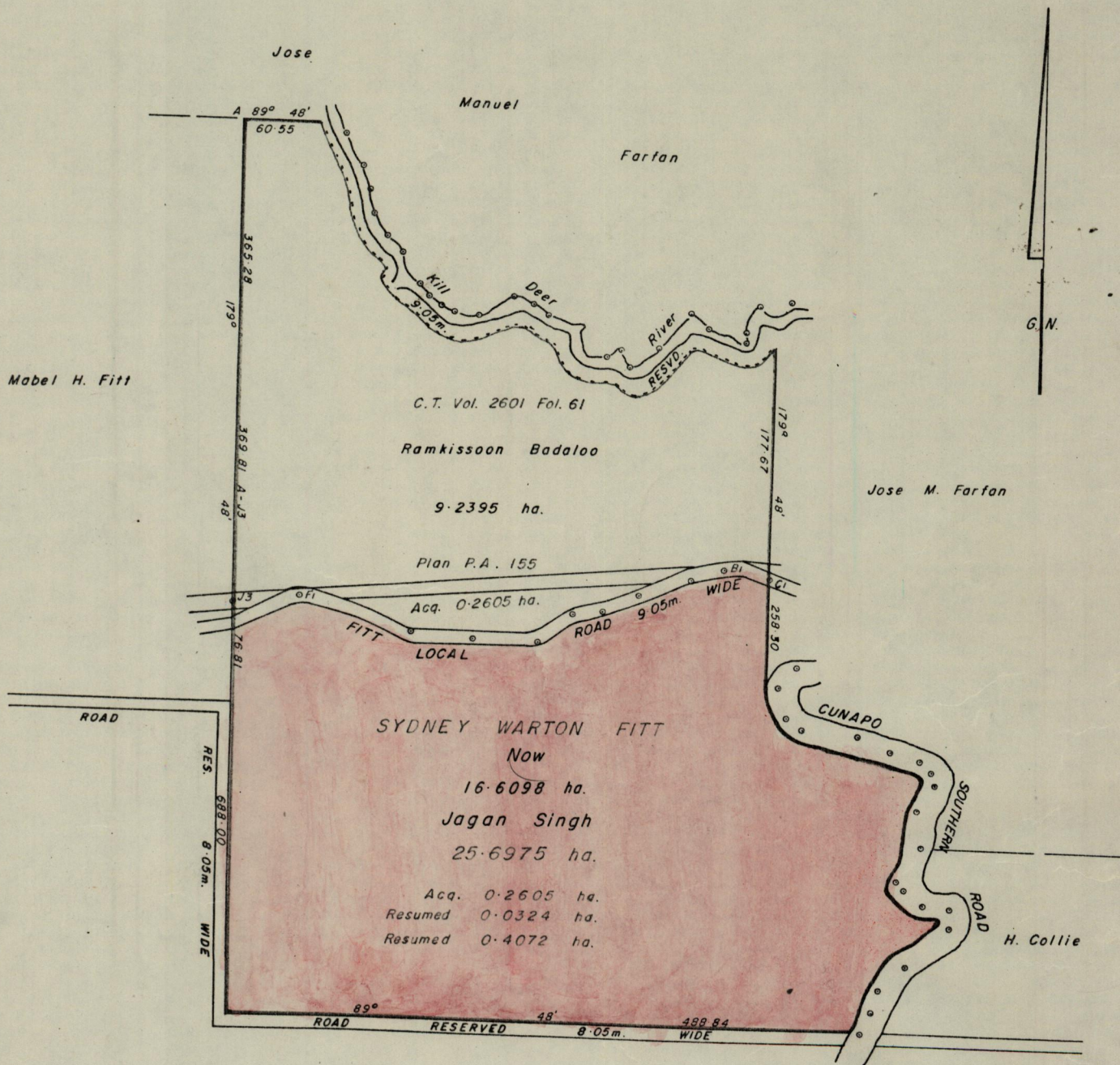

STAT	BEAR.	DIST.
J3 - F1	82° 49'	51.37
F1 - B1	85° 19'	332.06
B1 - C1	94° 24'	37.35

Approved

K.B. Joseph
 Director of Surveys
 85.4.16

182

Note: To obtain compass bearings *add* 12 minutes
subtract

SCALE 6 Chains to Inch.
 Distances are in Metres.

This is a true copy of a diagram of twenty-five point six, nine, seven, five hectares. originally
 Granted to Sydney Warton Fitt, shewing a portion
 coloured pink and containing sixteen point six, zero, nine, eight hectares. being the remainder
 after two resumption and one previous transfer of another portion of the land.
 the dividing lines having been run in conformity with Rule 76 under Sec. 7(d) of Cap. 27. No. 2 and duly certified
 by the Director of Surveys.

Checked by *[Signature]* 85.4.16

Entered on

[Signature]
 Land Surveyor, Trinidad, 27th MARCH 19 85