

1116

REMAINING PORTION

R.P.O. Vol. Fol.
C. of T. Vol. 1333 Vol. 185

1145

Cadastral Sheet (E. 12. G.)

36D
3/c

152

Ward of Turure

County of St. Andrew

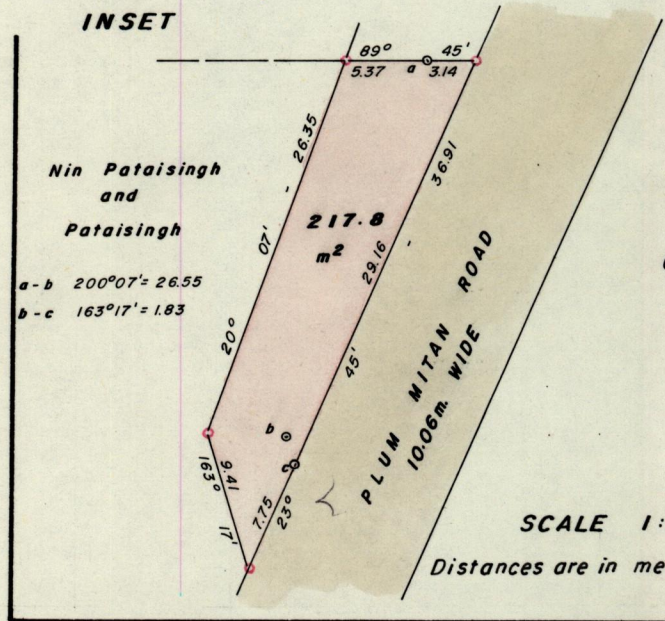
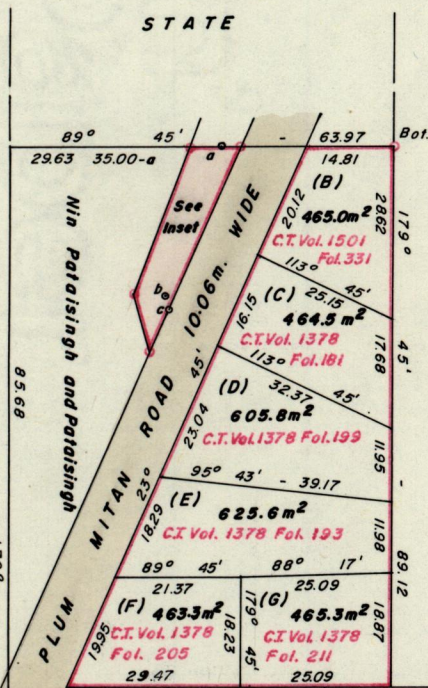

SCALE 1:500

Distances are in metres

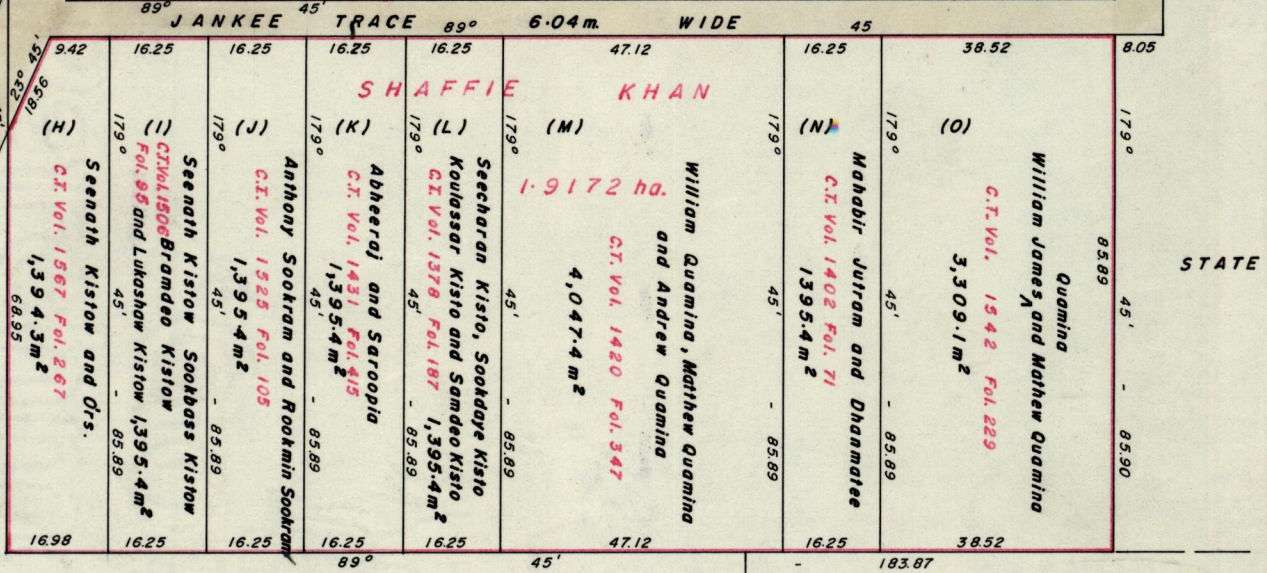

Rampersad

Sookeeah

Orig. Bk. 194 Fol. 182
Consolidated Plan Bk. 923 Fol. 232
Subdivision Plan Bk. 926 Fol. 213
Vol. 1378 Fol. 175

Approved

[Signature]
Director of Surveys
89.07.25

Note: To obtain compass bearings

add 15 minutes
subtract

SCALE 1:1250

Distances are in metres

This is a true copy of a diagram of one point nine one seventwo hectares originally granted to Shaffie Khan, shewing a portion coloured pink and containing two hundred and seventeen point eight square metres being the remainder after fourteen previous transfer of another portion of the land. the dividing lines having been run in conformity with Rule 76 under Sec. 7(d) of Cap. 27. No. 2 and duly certified by the Director of Surveys.

Checked by *[Signature]* 24/7/89

Entered on

[Signature]
Land Surveyor, Trinidad, 16th May 1989.