

No. 22039

R.P.O. Vol. 154  
C.T. Vol. 750

Fol. 93  
Fol. 209

Ward of Siparia.  
County of St. Patrick. 63E.  
Cadastral Sheet G.12.G. a 1/c

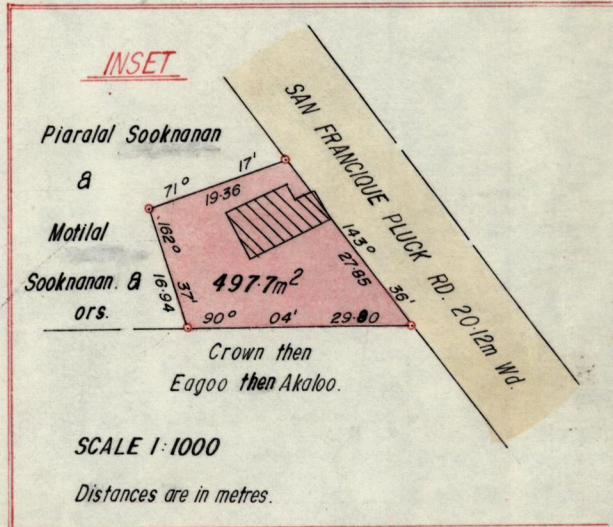
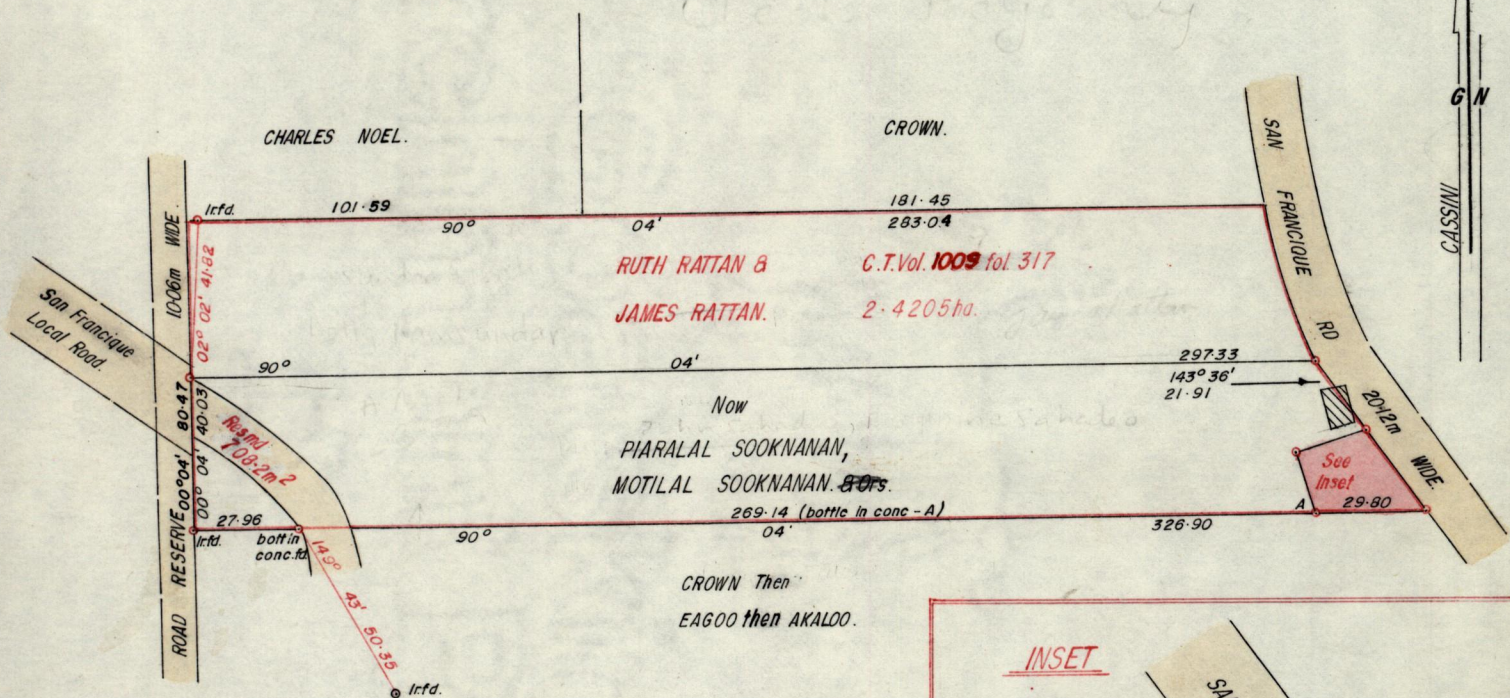

Approved

*Alwyn Phillip*  
Director of Surveys 89.06.14

Bearings are based on Solar Observations. (Cassini Grid.)

• Denotes Iron put except otherwise stated.

Note: To obtain compass bearings add/subtract

SCALE 1:2000

minutes

Distances are in metres

PLAN of a Parcel of land coloured Pink in the Ward of Siparia.

Containing four hundred and ninety seven point seven square metres.

Surveyed by me, with due authority, in February, 1987

I certify that I have complied with rule 76 under section 14(2)(d) of the Land Surveyors' Ordinance 1952, and that this plan is correct.

Checked by *GR 13/6/89*

*Jankaran Meero*

Entered .....

Land Surveyor, Trinidad *Dec, 15<sup>th</sup>* 1987