

No 8690

1145

130

R.P.O. Vol. 241  
C.T. Vol. 756

Fol. 561  
Fol. 45

Ward of Siparia  
County of St. Patrick  
Cadastral Sheet G.13K.  $\frac{63.F}{4/a}$

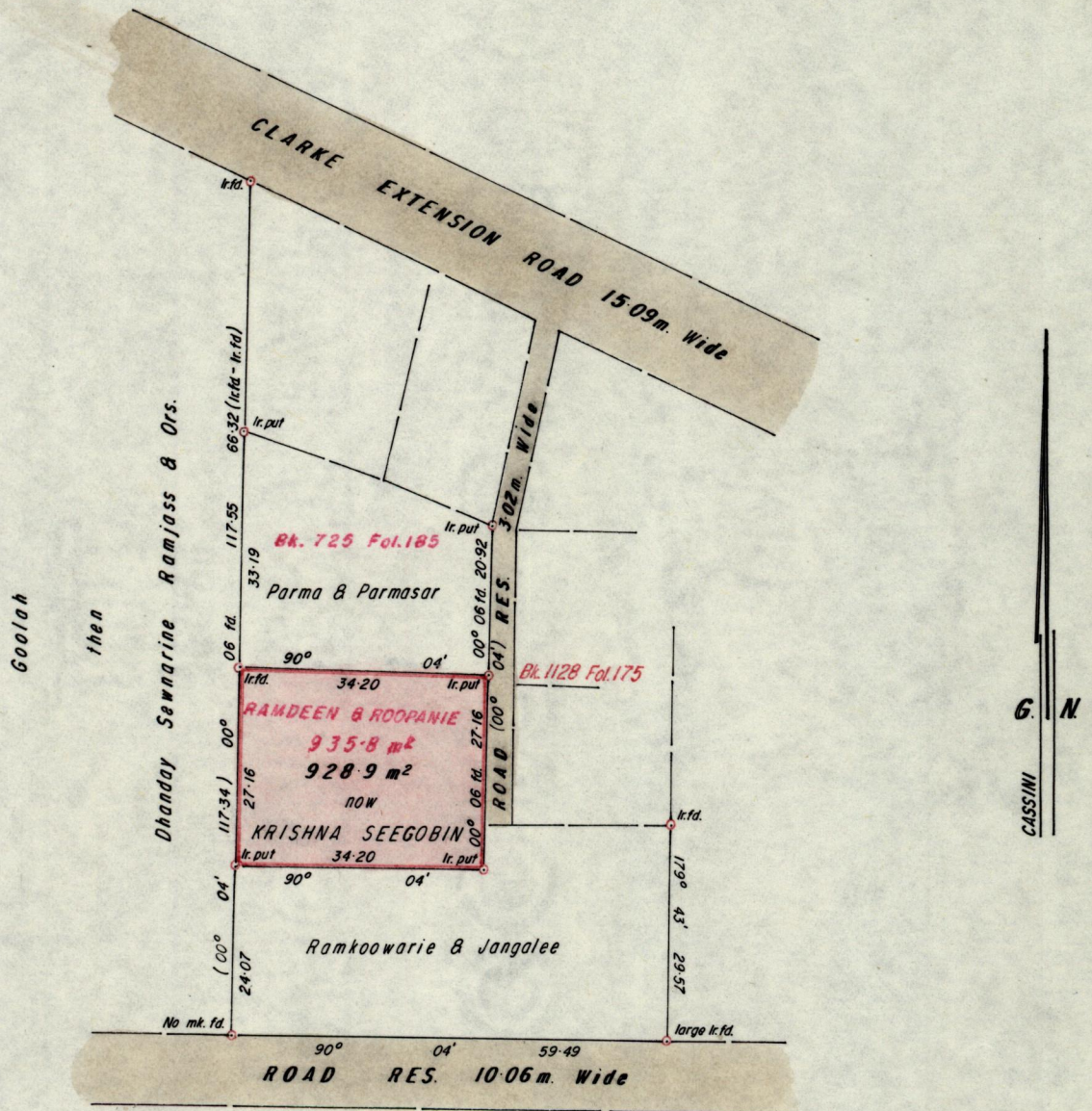

See Bk 725 Fol. 186

Bk. 871 Fol. 31

Approved

*Oliver Philips*

Director of Surveys

89.06.12

Bearings are based on Solar Observations (Cassini Grid)

Note: To obtain compass bearings add/subtract

SCALE 1/1000

minutes

Distances are in Metres

PLAN of a Parcel of land coloured pink in the Ward of Siparia

Containing nine hundred and twenty eight point nine square metres

Surveyed by me, with due authority, in April 1989

I certify that I have complied with rule 76 under section 14(2)(d) of the Land Surveyors' Ordinance 1952, and that this plan is correct.

Checked by *GR 9/6/89*

*Hug Somarajh*

Entered

Land Surveyor, Trinidad 24<sup>th</sup> May 1989