

No 20638

R.P.O. Vol. 13 Fol. 309  
C.T. Vol. 1957 Fol. 271  
REMAINING PORTION PLAN R.P.O VOL. 2395 FOL 137

Ward of Naparima  
County of Victoria  
Cadastral Sheet G-14-B-64 A  
3/d

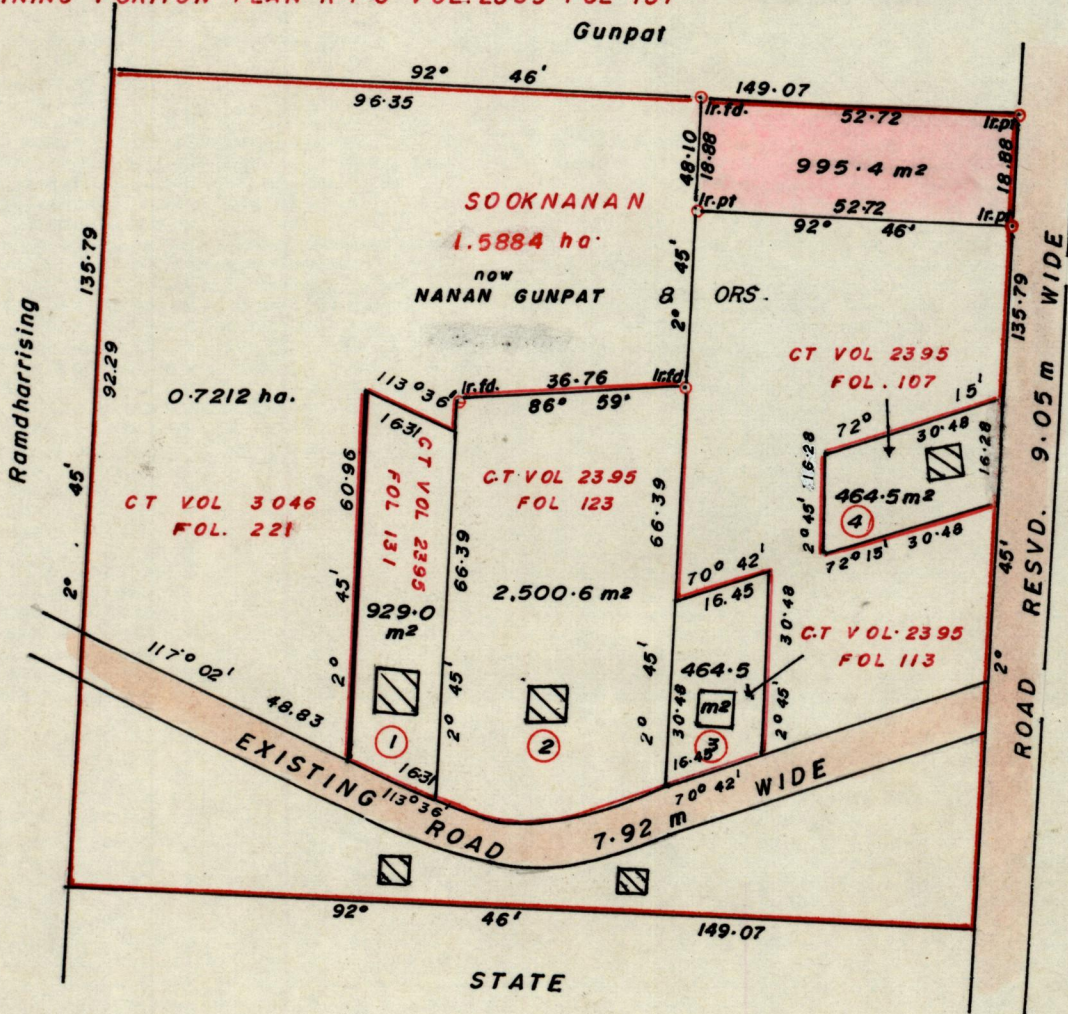

Approved

*Aloua Thilij*  
Director of Surveys  
89.06.08

Orig. Survey Bk. 980:76

SCALE 1:1250

Note: To obtain compass bearings add/subtract 1 minutes Distances are in metres

PLAN of a Parcel of land coloured pink in the Ward of Naparima  
Containing nine hundred and ninety five point four sq. metres

Surveyed by me, with due authority, in NOVEMBER 1988

I certify that I have complied with rule 76 under section 14(2)(d) of the  
Land Surveyors' Ordinance 1952, and that this plan is correct.

Checked by *GR 7/6/88*

*Winston R. ...*

Entered .....

Land Surveyor, Trinidad 2<sup>nd</sup> December 1988