

10153

L. & S.—54

913

No 23097

R.P.O. Vol. 169  
C.T. Vol. 1357

Fol. 655  
Fol. 171

Ward of Siparia  
County of St Patrick  
Cadastral Sheet G.16.D.  $\frac{73A}{1/a}$

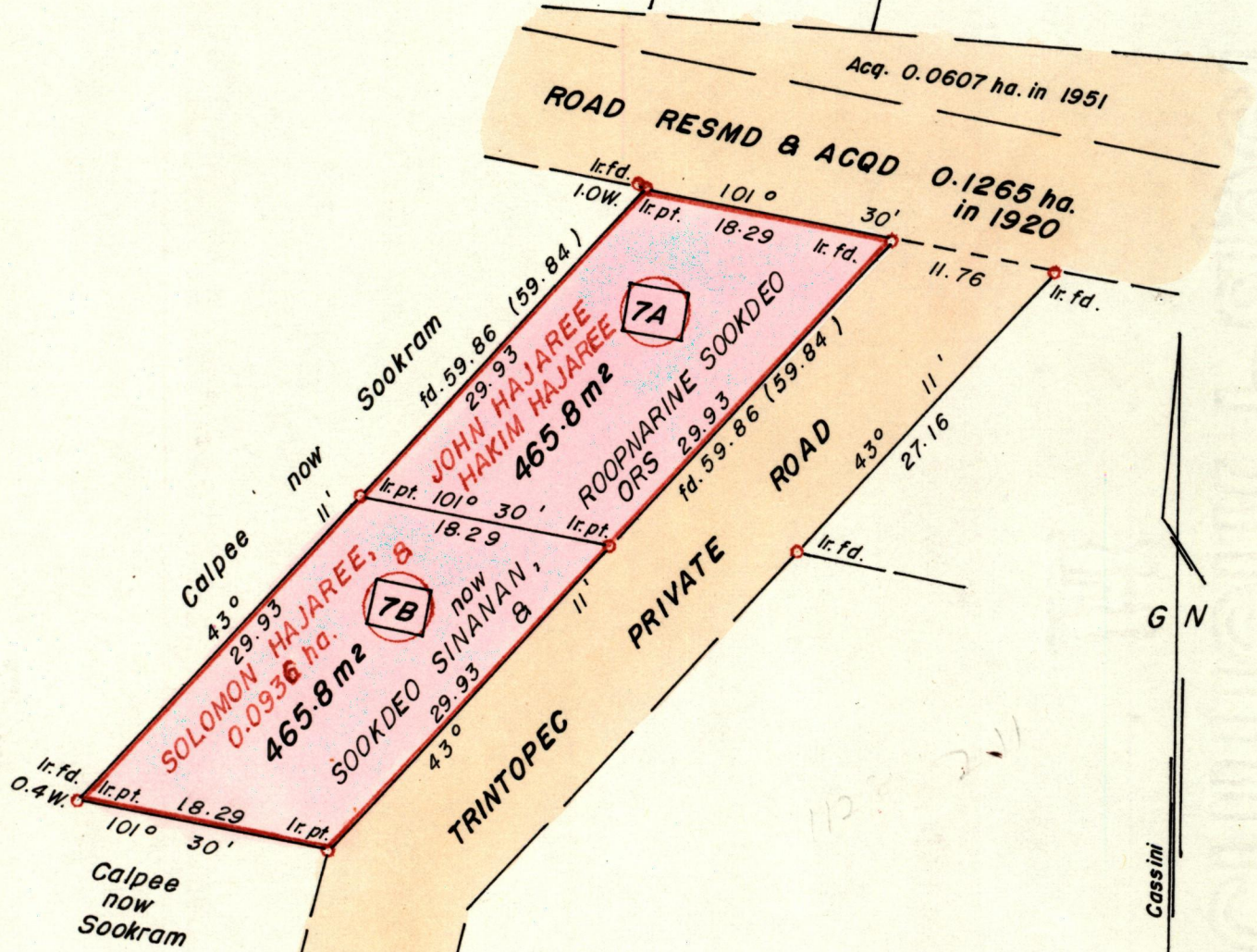

Approved

*Alton Thinksy*  
 Director of Surveys  
 89.01.11

Bearings based on Solar obs.

SCALE 1 : 500

Note : To obtain compass bearings ~~add~~/subtract 7

minutes

Distances are in metres

PLAN of <sup>2</sup>/<sub>4</sub> Parcel of land coloured pink in the Ward of Siparia  
 Containing together nine hundred and thirty one point six sq. metres  
 Surveyed by me, with due authority, in May 1987

I certify that I have complied with rule 76 under section 14(2)(d) of the  
 Land Surveyors' Ordinance 1952, and that this plan is correct.

Checked by *MA* 10/1/89

*MA*  
 Land Surveyor, Trinidad 15 June 1987

Original Survey Bk 9AD: 140

