

1053

901

R.P.O. Vol 200  
C.T. Vol. 1438

Fol. 621  
Fol. 341

Ward of Charuma.  
County of Nariva. 55A  
Cadastral Sheet D.25.K. 1/b a/d

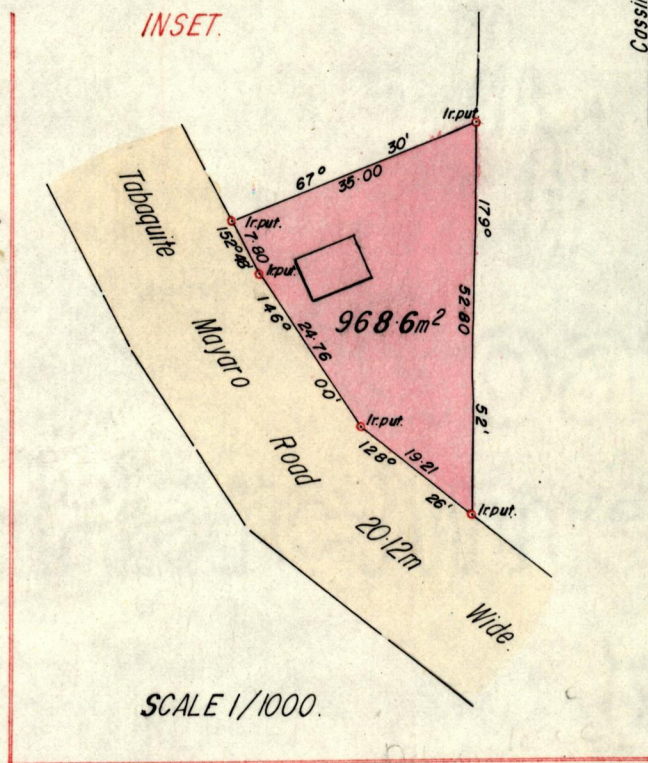
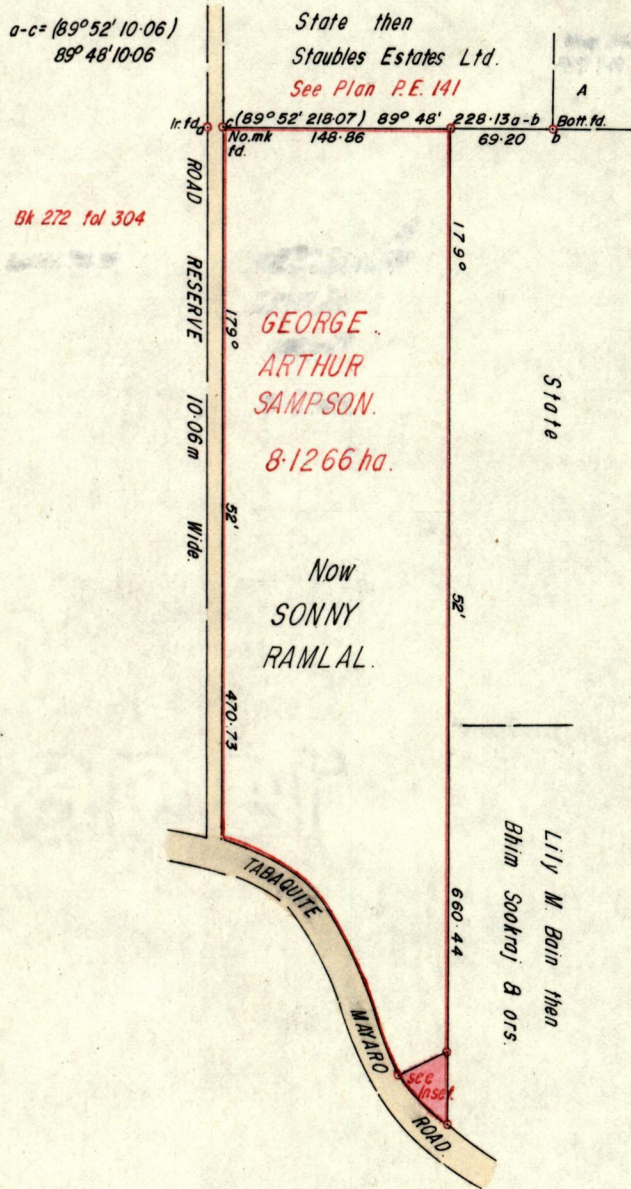

N.B. Tabaquite Mayaro Road. Scaled from Bk. 272 fol 304

Approved Alonso Kiley  
Director of Surveys  
88.12.22

Bearings are based on Solar Observations. (Cassini Grid.)

SCALE 1/5000.

Note: To obtain compass bearings add/subtract minutes Distances are in metres.

PLAN of a Parcel of land coloured Pink in the Ward of Charuma.  
Containing nine hundred and sixty eight point six square metres.

Surveyed by me, with due authority, in December, 1987

I certify that I have complied with rule 76 under section 14(2)(d) of the Land Surveyors' Ordinance 1952, and that this plan is correct.

Checked by GR 21/12/87 Jankaran Micoo  
Entered ..... Land Surveyor, Trinidad Sept 5<sup>th</sup> 1988

Original Survey Bk 272:304