

No 23891

1053

1111

R.P.O. Vol. 59
C.T. Vol. 1649

Fol. 275
Fol. 133

Ward of Naparima
County of Victoria
Cadastral Sheet G.13.B. ^{63F} 1/a

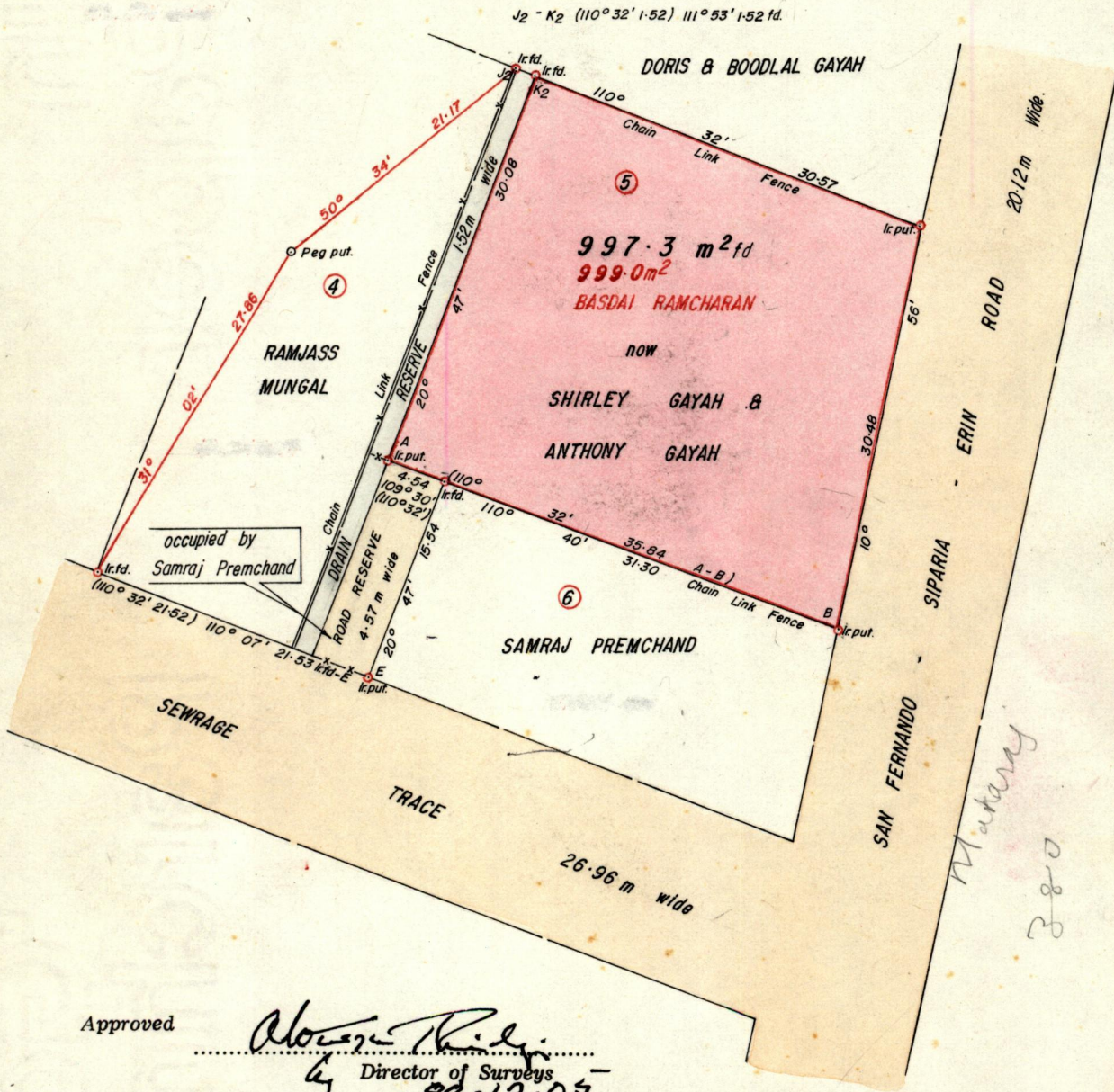

Approved

Alonso Rodriguez
Director of Surveys
38.12.05

Bearings are based on Solar Observations (Cassini Grid) SCALE 1:500

Note: To obtain compass bearings add/subtract 2 minutes Distances are in metres

PLAN of a Parcel of land coloured pink in the Ward of Naparima
Containing nine hundred and ninety seven point three square metres
Redefined by me, with due authority, in July 1986

I certify that I have complied with rule 76 under section 14(2)(d) of the
Land Surveyors' Ordinance 1952, and that this plan is correct.

Checked by *1/12/86*

Tankaran Micoo

Entered

Land Surveyor, Trinidad August, 8th 1986

Original Survey BK 714 Lot. 186