

No

1053

374

R.P.O. Vol. 32
C.T. Vol. 1728

Fol. 110
Fol. 551

Ward of Turure
County of St. Andrew
Cadastral Sheet E.I.D $\frac{25E}{27d}$

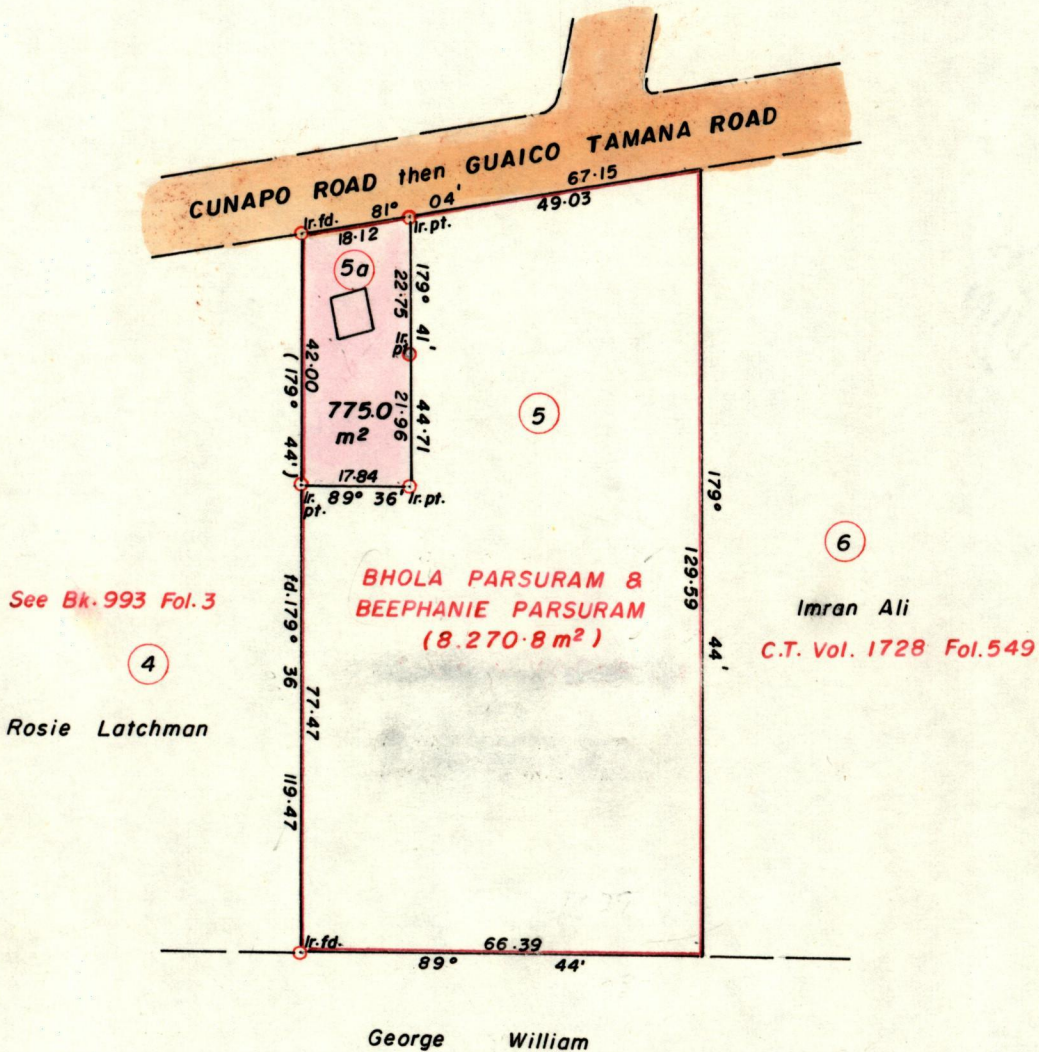

Approved

Alwyn Thibault
Director of Surveys
88.12.01

SCALE 1:1250

Note: To obtain compass bearings add/subtract 16 minutes Distances are in metres

PLAN of a Parcel of land coloured pink in the Ward of Turure
Containing seven hundred and seventy five sq. metres
Surveyed by me, with due authority, in November 1987

I certify that I have complied with rule 76 under section 14(2)(d) of the
Land Surveyors' Ordinance 1952, and that this plan is correct.

Checked by *GR 30/11/88* *Catharine Bas*

Entered Land Surveyor, Trinidad 15th December 1987.

See Bl 993:3