

No. 22083

11153

8363

R.P.O. Vol. 173  
C.T. Vol. 602

Fol. 85  
Fol. 171

Ward of Siparia.  
County of St. Patrick. 64 D  
Cadastral Sheet G.14. A 1/a

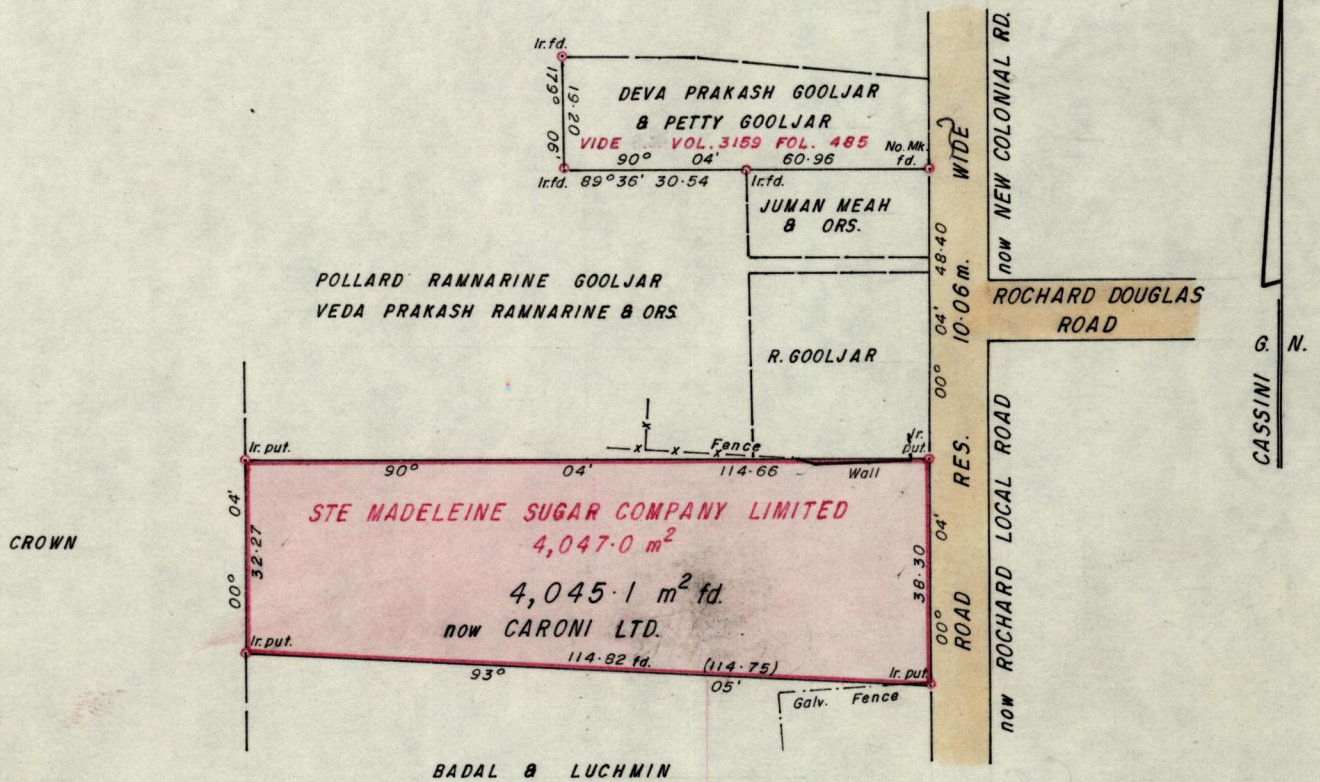

Approved *Alwyn Thiel*  
 Director of Surveys 88-11-28  
 Bearings are Cassini Grid, based on Solar Obs.

SCALE 1:1250

Note: To obtain compass bearings add/subtract minutes Distances are in metres

PLAN of a Parcel of land coloured Pink in the Ward of Siparia.  
 Containing four thousand and forty five point one square metres.  
 Surveyed by me, with due authority, in October 1988

I certify that I have complied with rule 76 under section 14(2)(d) of the  
 Land Surveyors' Ordinance 1952, and that this plan is correct.

Checked by *GR 25/11/88*  
 Entered ..... Land Surveyor, Trinidad *Jumanah* 7<sup>th</sup> November 1988



Original Plan Bk 722: 107