

10153

342

No 16860

R.P.O. Vol. 20
C.T. Vol. 2739

Fol. 517
Fol. 349

Ward of Ortoire
County of Victoria
Cadastral Sheet G.5.1. $\frac{54E}{3/b}$

Amendment to Lot 6

General Plan filed in Vol. 3262 Fol. 535

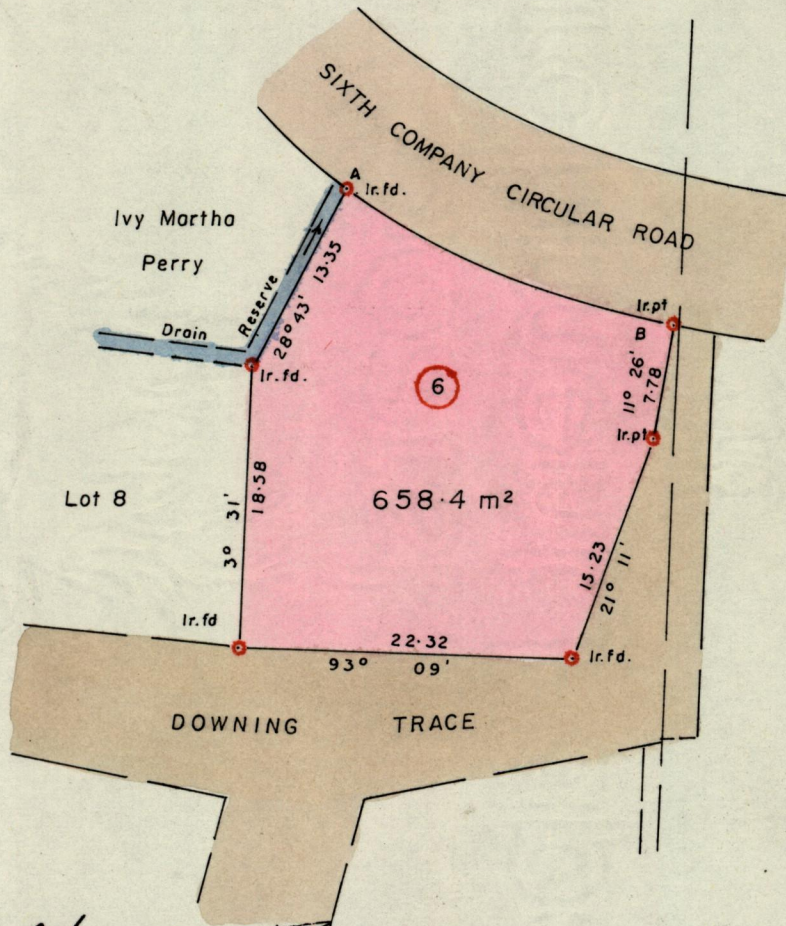

B	Ir. pt
23-82	0
12-00	1-5
0	0
A	113° 54'

Approved

Alonso Thili
Director of Surveys
88.11.11

Bearings are based on Solar Observations

Note: ~~To obtain compass bearings add/subtract~~

SCALE : 1 / 500

minutes

Distances are in metres

PLAN of a Parcel of land coloured pink in the Ward of Ortoire
Containing six hundred and fifty eight point four square metres
Surveyed by me, with due authority, in April 1988

I certify that I have complied with rule 76 under section 14(2)(d) of the
Land Surveyors' Ordinance 1952, and that this plan is correct.

Checked by *GR 10/11/88*

[Signature]

Entered

Land Surveyor, Trinidad *4th November 1988*

SAB

322:116

Orig Survey Bk 322:116

718
448

32
0212

Attachment to Vol. 2
General State Files in Vol. 2000 for 1900



[Faint, illegible handwritten text]