

1053

L. & S.—54

321

Nº 48365

R.P.O. Vol. 54  
C.T. Vol. 1004

Fol. 73  
Fol. 153

Ward of Charuma  
County of Nariva  
Cadastral Sheet H. 2. A.

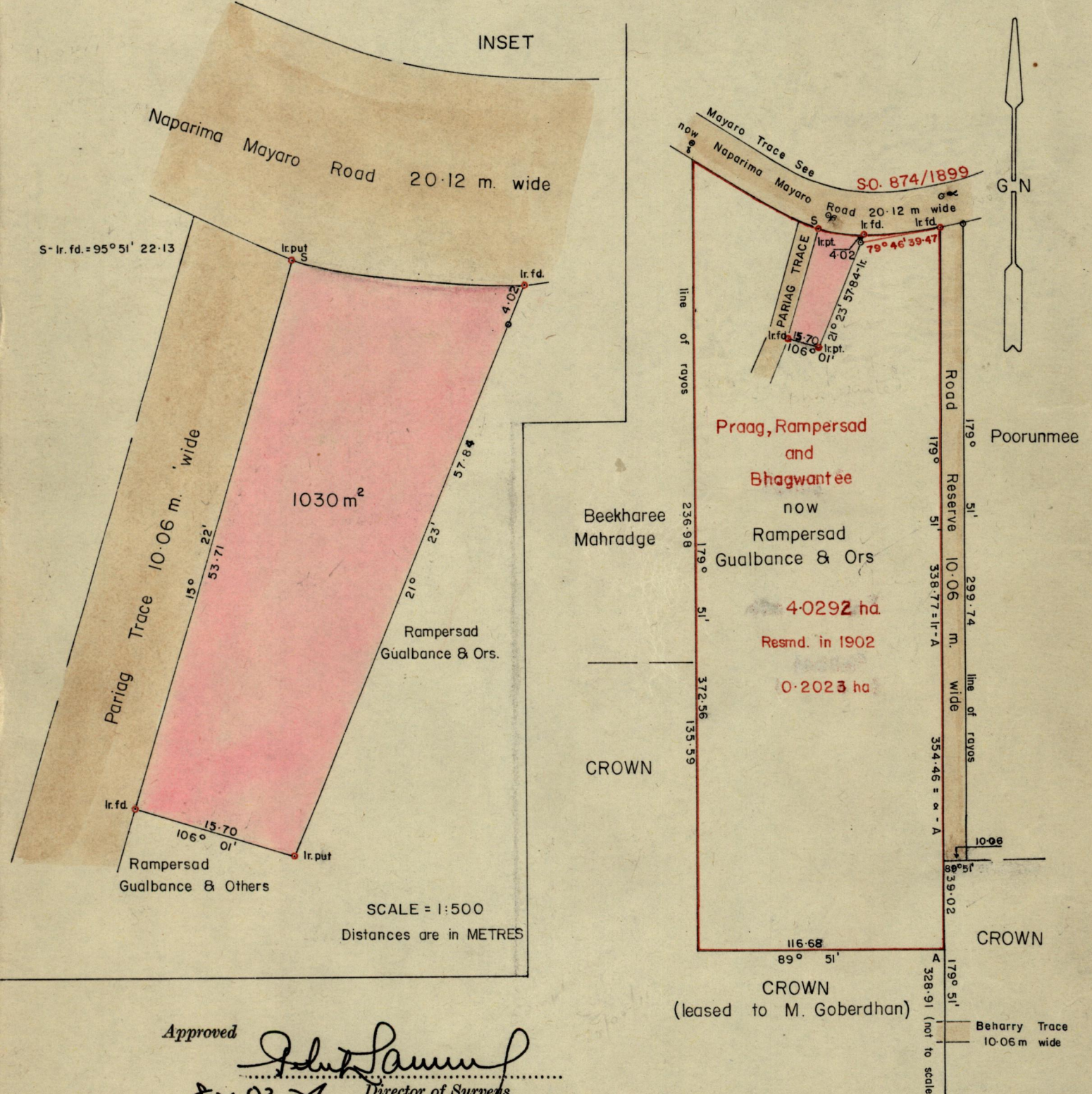

Approved *[Signature]*  
 8 v. 03. 26. Director of Surveys

SCALE 1:2500

Note: To obtain compass bearings add/subtract 9 minutes Distances are in METRES

PLAN of a Parcel of land coloured pink in the Ward of Charuma

Containing one thousand and thirty square metres

Surveyed by me, with due authority, in July 1981

I certify that I have complied with rule 76 under Section 14 (2) (d) of the Land Surveyors' Ordinance 1952, and that this plan is correct.

Checked by *[Signature]* 82/03/23

*[Signature]*

Entered.....

Land Surveyor, Trinidad 9th Feb 1982



original 326:219

1053

1053