

Nº 44221

1053

753

R.P.O. Vol. 269 Fol. 421 ✓
C.T. Vol. 1243 Fol. 95 ✓

Ward of Siparia.
County of St Patrick.
Cadastral Sheet G.13.P.

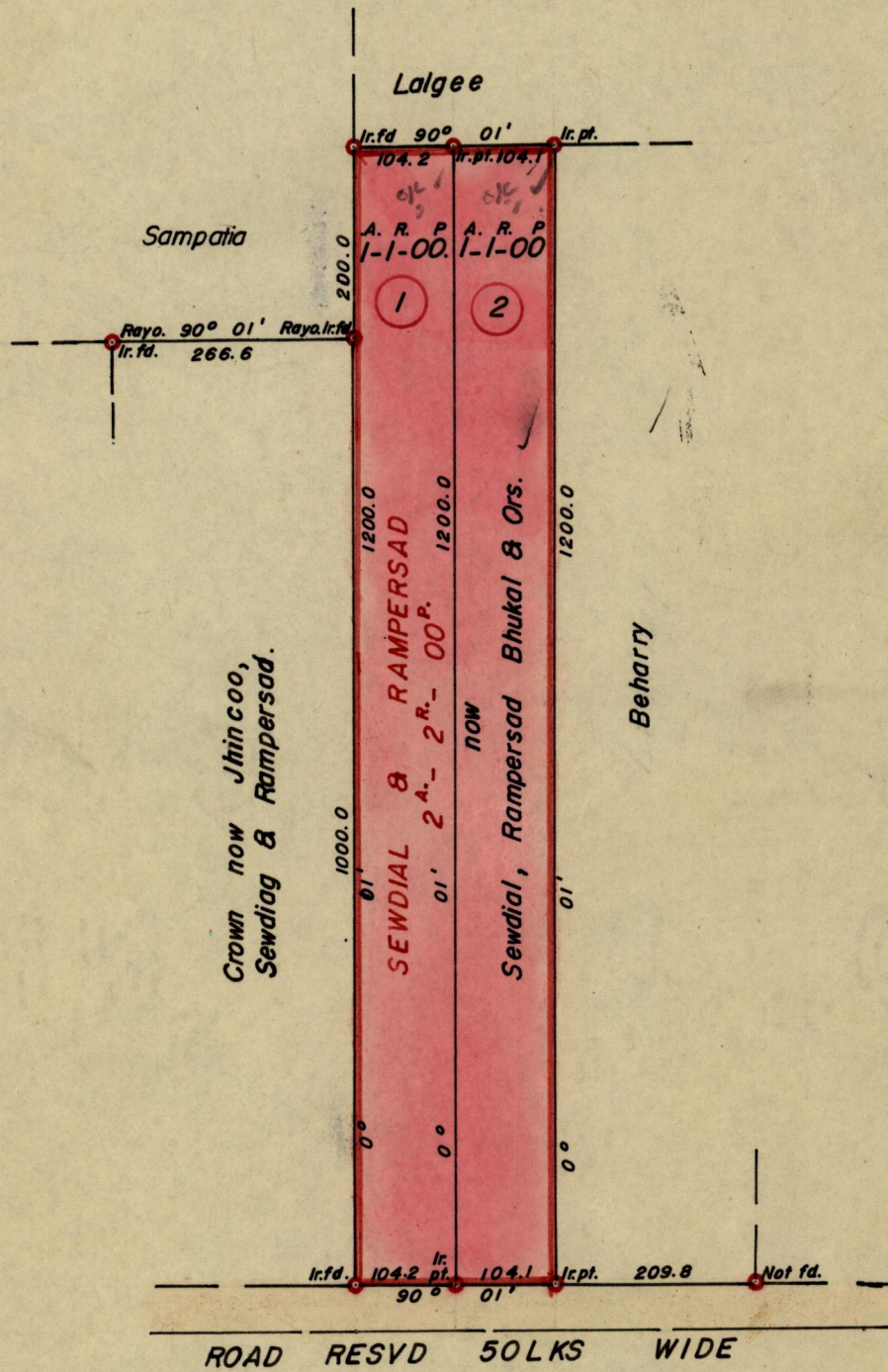

Approved

Robert Samuel
15.11.79. Director of Surveys

SCALE 2 Chains

Note: To obtain compass bearings add/subtract 1 minutes Distances are in Lks
PLAN of a Parcel of land coloured pink in the Ward of Siparia
Containing together two acres two roods.

Surveyed by me, with due authority, in July 1979.

I certify that I have complied with rule 76 under Section 14 (2) (d) of the Land Surveyors' Ordinance 1952, and that this plan is correct.

Checked by *L.F.W. 9/11/79* *R. Balliecharan*

Entered *20/8/1979*
LANDS AND SURVEY DEPARTMENT RECORDS Land Surveyor, Trinidad

Original Survey in BK 903 P51 129

2

8201