

1053

639

Nº 42914

R.P.O. Vol. 109  
C.T. Vol.

Fol. 181  
Fol.

Ward of Naparima  
County of Victoria  
Cadastral Sheet G.13.G

G N

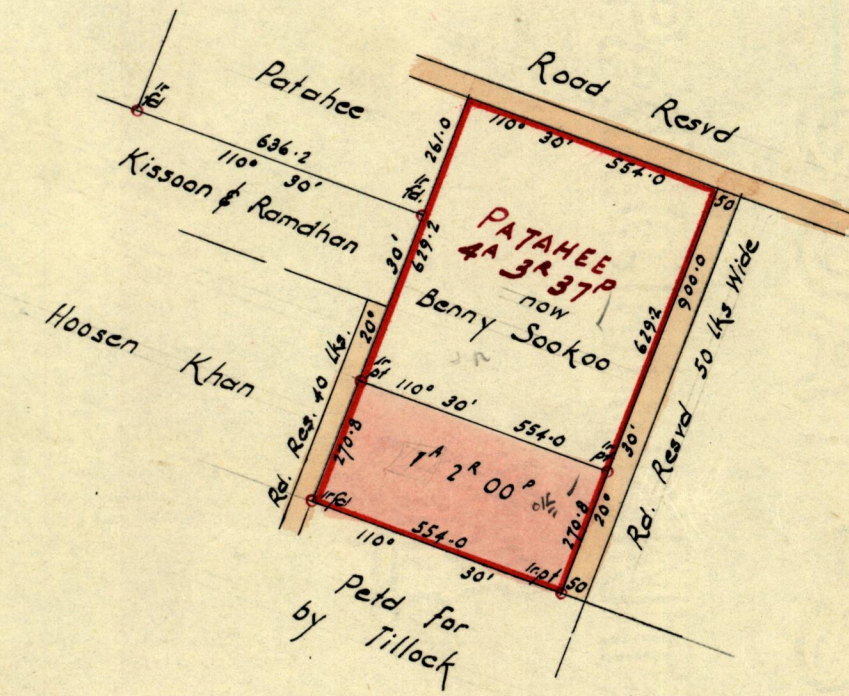

Approved

*John Samuel*  
27.5.79 Director of Surveys

SCALE 4 Chains

Note: To obtain compass bearings add/subtract 0 minutes Distances are in Lks

PLAN of a Parcel of land coloured pink in the Ward of Naparima

Containing One acre and two roads

Surveyed by me, with due authority, in Nov. 1978

I certify that I have complied with rule 76 under Section 14 (2) (d) of the Land Surveyors' Ordinance 1952, and that this plan is correct.

Checked by *L.N. 15/79*

Land Surveyor, Trinidad

*S. Balliecharan*

15/12/1978

LANDS AND SURVEYS VAULT RECORDS

2

Original Survey BK 395 fol 84



UNIVERSITY OF TORONTO